

THE PRECINCT OF CYBELE

To reconstruct this precinct we have as evidence to go on:

The general foundation plan

A few steps "in situ"

One Ionic cap

One piece of a column drum

Fragmentary roof tiles so assorted as to be of no possible value.

Starting with the sanctuary which is a long terrace of unbroken face but with a recess in centre. The recess demands a pitched roof in the opposite sense to that which would cover a stoa running the length of the terrace.

Something like this:
for which there is no precedent.



At Magnesia, however, there is a propylaea which offers a solution.

Here is a long stoa of unbroken line. In the centre is the ^{propyl}propylaea built in the Ionic order - while the columns on the stoa on each side are Doric.

The plan is:

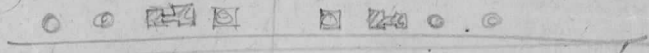

We adopt this plan for want of any evidence to the contrary, and as being admirably suited to the existing conditions.

Having only one cap, we may use it for the central motif as at Magnesia, or put a Corinthian order in the centre and Ionic along the sides. However, having adopted the plan of Magnesia, we might as well copy slavishly and use our Ionic cap for the centre. (As it was found at the foot of the sanctuary steps against the N. terrace wall, it is as likely to have come from there as anywhere).

The column drum was found at the base of the terrace wall at the extreme S. end. In size it might belong to the Ionic cap. It is picked to receive a plaster finish which could be fluted. Having arbitrarily placed the Ionic order in the centre, ^{the drum} its position makes it improbable that the drum and the cap belong to the same order.

The columns along the stoa we have assumed to be Doric, and giving them a diameter of 50 cm. This drum will fit in nicely as the first drum ^{of} the column showing entasis.

If the steps approach the sanctuary in unbroken flights, the N. and S. flights end at the inner column of the central motif. And the E. flight stops about 4m. east of the terrace wall leaving a platform ca. 4 x 6 cm. This is not impossible but it gives a ^{very} weak look to the whole. Also, there is one foundation stone ^{to the centre} "in situ" which does not quite fit into the N. flight.

On the plan it is noticeable that after the 7th step on both the N. and S. flights, there are no more steps in place. This might perfectly well be due to the natural disappearance by washing away and carrying off of material. Also at this same level there is a row of foundation stones parallel with the E. steps which could have no significance ^{when} the flights continuous. Therefore at the 7th step we must assume a change of plan which will account for this evidence, and if possible give the whole a more solid appearance.

Solution:

As to the altar in front of the steps, it is difficult to reconstruct having no superstructure. Also it is not centered perfectly on the steps.

The best parallel which I can find is at Miletas. There, however, it is not connected to a *temple* or sanctuary. It is approached from ^{one} inside only as is this one. It is low - which this should be (total $h = 1.93m$), consisting of a parapet surrounding the altar proper. *the altar*

The question of centering is immediately solved when we admit the approach from the N. only. It is three steps above the ground; the first step is certainly 30 cm. wide, as are the steps up to the sanctuary (see dowel holes). A cover slab rests on this and half its width, ca. 30 cm., is covered. The same is true of the next and the 3rd time it is the structure of the parapet itself which comes out 30 cm.

This leaves the height of two foundation courses exposed on the S. These would have been covered by single upright blocks with base molding to support them, only a light foundation would be necessary. This, we must assume has disappeared.

The ground-level slopes away to the E. Where the altar steps meet the sanctuary steps the first altar step is practically at ground level, and the 2nd step is at the same height as step one of the sanctuary - in fact on the west it was identical with it.

The question of what happens to the east is difficult. If the stoa was in existence at the same time as the altar, we must assume that the stoa was an open stoa and people would pass through it to get from one side of the precinct to the other. There is no real evidence to prove that the one structure is necessarily later than the other. However, it seems probable that the Aesclepeion was built after the stoa.

disappearance by washing away & carrying off of material.
 Also at this same ~~high~~ level there is a row of founda-
 tion stones parallel with the E. steps which could ~~not~~
~~be~~ have no significance even the flights continuous.
 therefore at the 7th step we must assume a change
 of plan which will account for this evidence &
 if possible, quote the whole a more solid appearance

Solution:

sect.

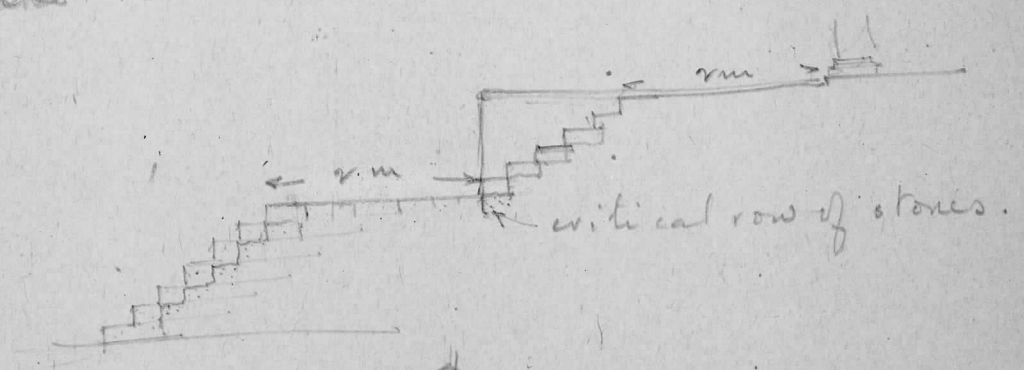

plan.

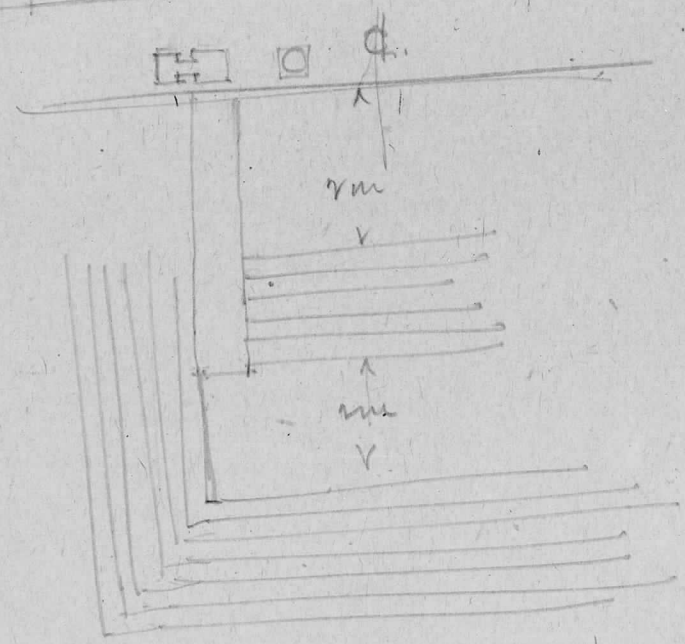

As to the altar in front of the steps:

To make room for this building the line of the outer retaining wall was changed and the S. end of the foundations of the stoa partially destroyed. Possibly at this time the whole of the stoa was torn down and only a flat terrace remained between the sanctuary and the outer precinct wall. Considering the inscriptions which are against the S. sanctuary wall, it seems probable that there must have been free circulation. The height of the altar foundations "in situ" preclude any assumption that it did not exist in the final rebuilding of the precinct, and the nature of the stone work makes it certain that the altar and steps were contemporary.

But the question of alignment of stoa and altar is more troublesome than that of circulation. It is possible that in some time in the rebuilding in the precinct the sanctuary steps were pushed forward to give greater importance to

we owe the construction of the altar in its present form and position and the destruction of the stoa.

It is low — which this should be (total h = 1.93), consisting of a ~~part~~ parapet surrounding the altar proper. The question of centering is immediately solved when we admit the approach from the N. side. It is three steps abt the ground the 1st step is certainly 30cm. wide as are the steps ^{4/5} the Sanct. (see dowel holes) When a cover slab rests on this and 1/2 its width ca. 30 cm. is covered the same is true of the next and the 3rd time it is the structure of the ^{parapet} altar itself which comes out.

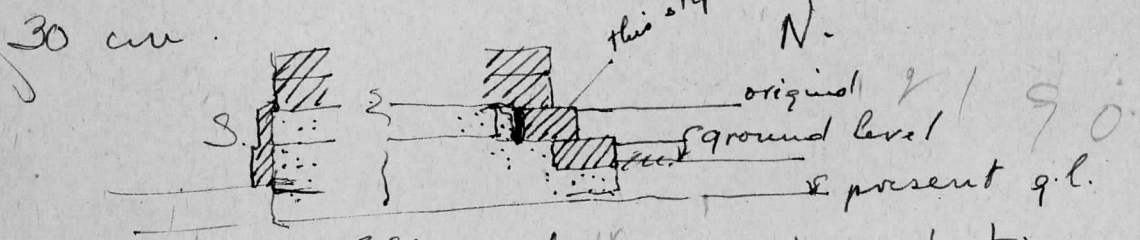

30 cm. this leaves the height of 2 foundation courses exposed on the S. these would have been covered by single upright ^{block with} base molding. To support this only a small light foundation would be necessary. ~~to~~ this we must assume has disappeared. *

The question of what happens to the East is difficult.

If the stoa was in existence at same time as altar we must assume that the stoa was an open stoa & people could pass through it to get from one side of the ^{the} precinct ~~sanct.~~ to the other. There is no real evidence to prove that the one structure is necessarily later than the other. However, it seems probable that the Asclepeion

* the ground level slopes away to the E. the altar steps meet in sanct steps. When the wall step is practicable at ground level the 1st step is at same level as after the sanctuary + 1/2 step on the wall.

is it correct to call them base blocks or blocks?

6

was built after the stoa.

To make room for this building the line of the outer retaining wall was changed and the S. end of the foundations of the stoa partially destroyed. — Possibly at this time the whole of the stoa was torn down and only a flat terrace remained between the sanct. & the outer precinct wall. Considering the inscriptions which are against the S. wall. It seems probable that there ~~circulation~~ must have been ~~very~~ free circulation. The height of the altar foundations "in situ" preclude any assumption that it did not exist in the first rebuilding of the precinct and the nature of the stone work makes it certain that the altar & steps were contemporary.

But the question of alignment of stoa and altar is more troublesome than that of circulation.

It is possible that in some time in the rebuilding of the ^{precinct} sanctuary the sanctuary steps were pushed forward to give greater importance to the approach. And to the date of this rebuilding ^{the} we ^{possibly the cause} ^{as cause of the} ^{headstone} owe the construction of the altar in its present form & position and the destruction of the stoa.