

Argive Heraeum

---

CAR 1925

RSD 1927



The image shows the front cover of an antique book. The cover is decorated with marbled paper featuring a pattern of irregular, rounded shapes in shades of red and maroon, outlined in a dark blue or black. A vertical strip of a different material, possibly leather or a different color of marbled paper, runs down the center, serving as the spine. A small, rectangular, cream-colored paper label is affixed to the spine, with the name 'Mary S. Fisher' written in cursive. The book's edges are bound in a dark green cloth.

Mary S. Fisher

C. A. Robinson, Jr.  
Archive, Heraculum  
1975

Index C.A. Robinson 1925-

Terms

II 1, 2, 7, 8, 15, 20, 25, 30, 35, 40, 45, 50  
52, 57, 63, 69, 74

III 1, 3, 7, 9, 16, 21, 26, 31, 36, 41, 46, 53, 58,  
62, 64, 68, 70, 75

IV 1, 4, 6, 7, 10, 12, 17, 22, 27, 32, 37, 42, 47,  
54, 59, 65, 67, 71, 76

~~XIII~~ 1, 5, 7, 11, 13, 18, 23, 28, 33, 38, 43, 48, f,  
55, 60, f, 66, 72, f.

Index. Darbrothire, 1927

Old Temple Terrace 77-103, 167, 171

Neolithic hollow 110, 115, 116, (119), 171

Tombs

XVI 172

XVII 166, 172

XVIII 172

XIX 172

XX 173

XXI 173

XXII 105, 106, 107, 108, 109, 115, 116, 118, 120, 126,  
127, 128, 129, 131, 136, 137, 138, (140), 147, 173

XXIII 105, 107, 108, 109, (111), 116, 120, 126, 127, 128, 129

XXIV 105, 106, 107, 109, 114, 116, 120, 126, 127, 128,  
129, 131, 132, 134, 135, (140), 147, 157, 158, 173

XXV 105, 106, 107, 109, 116, 120, 123, 126, 127, 128, 129, 131,  
132, 134, 135, 137, 138, 139, (142), (146), 147  
151, 157, 159, 161, 162, 163, 165, 166, (168), 173

XXVI 105, 107, 109, 116, 118, 120, 125, 126, 127, 128,  
129, 131, 132, 134, 135, 136, 137, 138, 139, 147,  
(148), 151, 160, 162, 174

XXVII 105, 107, 108, 109, (112), 115, 116, 118, 120  
126, 127, 128, 129, 131, 136, 137, 139, 147, 162, 163, 174

XXVIII 105, 108, 109, 116, 120, 126, 127, 128, 129,  
132, 135, 137, 138, 139, (144), 174

XXIX 109, 115, 116, 118, 120, (121), 126, 127, 128  
129, 131, 136, 137, 138, 139, 158, 175

XXX 109, 115, 116, 118, 120, 126, 127, 128, 129,  
131, 132, 135, 137, (141), 175

XXXI 105, 108, 109, 115, (117), 118, 120, (124),  
126, 127, 128, 129, 131, 132, (133), 134, 135, 136,  
137, 138, 139, 147, 157, 159, 160, 161, 162,  
175, 176

XXXII 132, 136, 137, 139, 147, 151, (152), 157,  
159, 160, 162, 163, 165, 166, 176

XXXIII 132, 136, 137, 139, 147, 151, (154),  
157, 159, 160, 162, 163, 165, 166, (168), 176

grave XI 130

wed. April 1.

[Arrived March 31 from Athens  
and have taken over Chamber  
tombs nos. 2, 3, 4, 13]

Tomb 2.	10 men.
Tomb 3.	2 men.
Tomb 4.	1 man
Tomb 13	2 men
	<hr/>
	15 men

Later in the morning, the  
men were distributed thus:

Ch. Tomb 2	8 men
" " 3	2 men
" " 4	0 men
" " 13	2 men
	<hr/>
	12 men



2)

### Ch. Tomb 2.

This is a very large tomb, with roof partly cave-in. circular.

At W. end two boys have come to light, and will be drawn shortly. Work stopped here & concentrated on clearing rest of tomb & finding drums.

At E. end depth 1.30 a broken Corinthian fan tile came up.

(we think we have found the drums; if so both sides were walls & the passage between ca. 50m wide. However on second thought, I should say that these stones are merely the stones which closed the doorway. More digging will probably reveal the drums just east of the stones.)

Several tiles have been turned up just within the tomb, also some Byz pottery.

Lot 8.

3

### Ch. Tomb 3

In S.W. corner at depth of ca 1.65 m three fragmentary fan tiles turned up.

A few sherds are now coming out at about same depth, including several late ones; probably carried in at time of cave-in of roof.

It is not absolutely certain that this is a tomb. We are clearing away the fallen rock to try to catch the line of the tomb.

A small piece of bronze has come up in N.W. corner, depth 200.

Several tiles have come up.

From dump: Corinthian bronze of 3rd century B.C. Obv. too dirty to read; prob Pegasus flying; Rev. trident upwards. In field 2, Δ



Some late pottery (Byz) is coming out.

Lot 9.

4) Ch. Tomb 4

All we have here is the beginning of the chamber. The chamber is rather curious: the N. side is the usual hard earth or rock while the S. side is a wall ca. 90 high made of small & medium sized stones. Next to this wall, at its N. face and 1.33 m from its E. end lies a skull split in half (or perhaps two skulls); there seem to be no other bones.

The two skulls photographed by C. B. film D# 7

Good l. H. shreds are coming out.

to p. 6

Ch. Tomb # 13

5

Two men are digging here and are now down about 200 in. while nothing has been found, nevertheless the rock has the conventional cutting.

a few B. shreds & a broken piece of bone, perhaps the rim of a vessel, have come out. The rest of this vessel has just appeared & seems to be broken: rests in center of chamber. see p. 13

to p. 11

B) Ch. Tomb 4  
from p 4  
map showing position of  
skulls in drawers.

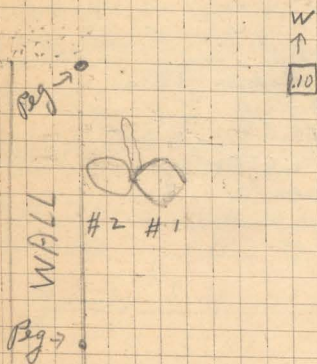

Skull #1 was right side up and feet  
towards wall (south).

top. 10

(7)  
Thursday, April 2.

Ch. Tomb 2	6 men
Ch. Tomb 3	4 men
Ch. Tomb 4	2 men
Ch. Tomb 13	2 men
	<hr/>
	14 men

Ch. Tomb 13 temporarily has  
an extra man, digging out  
a bronze vessel.

8/ Ch. Tomb 2  
to p. 2.

The men are clearing out  
the earth from the chamber.

Byz shards are still coming out  
in quantities, also a few tiles.

a very small bead has come  
out of rear part of chamber.

A small bronze coin, as yet too  
dirty to identify, has come out of  
center of chamber.

A loose lamp (unbroken) has been  
found.

to p. 15

Ch. Tomb 3  
to p. 3

(9)  
The men are clearing out  
the earth from the  
chamber.

A good many Byz shards, a  
Corinthian pan and cover tiles  
are coming out.

Most of our work consists in  
clearing out the fallen rock  
and laying bare the original  
lines of the chamber.

A bronze pin has come out from  
the rear part of chamber.

to p. 16

10) Ch. Tomb 12  
to p. 5-10

The men are digging in  
the dromos.

Good L.H. sherds are coming  
out.

A beak, broken in half, has  
come out.

A small broken ~~black~~ black  
stone blade has come out.

Two pieces of obsidian have been  
found.

Ch. Tomb 13  
to p. 5-

The men are digging in  
the dromos.

In the center of the chamber,  
yesterday, there came to  
light a bronze vessel; one  
man is digging it out.

L.H. sherds are coming out of  
the dromos.

to p. 13

to p. 12

12) Ch. Tomb 4 (to p. 10)  
 Diagram showing stones just below  
 surface of ground, incised in drums



wall  
 ground

Photographed by CWTB film E #1

to p. 17

~~Ch. Tomb 13~~ Ch. Tomb 13  
 to p. 11

W  
 ↑

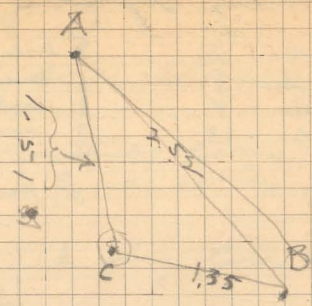

radius .123"  
 depth below A 1.45"

Diagram showing position of  
 bronze vessel in chamber.  
 The vessel was taken out - broken.

to p. 18

Transferred to  
 Plan of Miss Cox

(13)

14) Friday April 3

Ch. Tomb	2	8 men
Ch. Tomb	3	2 men
Ch. Tomb	4	2 men
Ch. Tomb	13	3 men
<hr/>		15 men

Ch. Tomb 2  
fr. 1.8

(15)  
The men are clearing out  
the chamber.

Byz shards still come out in  
considerable quantities.

Photographed by CWTB  
film E #8

Bones in rear part of chamber  
discovered several days ago,  
drawn by Miss Cox.

to p. 20

16) Ch. Tomb 3  
p. 1-9

The men are clearing out  
the chamber.

Photographed by CWB Film E #9

Byz pottery still coming out.

to p. 21

Ch. Tomb 4  
p. 1-12

17

work to date has consisted  
in digging in the doorway.  
The doorway (i.e. the stones  
filling it) has been reached &  
is now being cleaned for a  
photograph.

Photographed by Prof. Forster

we are digging in through  
the upper part of the doorway.  
a good many of the stones in  
the doorway have been taken out  
so we are digging in behind.  
a late tile was found inside.

to p. 22



Ch. Tomb 13  
(for p. 13)

Two men are working in  
the dromos.  
The other man is digging  
in the chamber with his  
kumbe.

Bones have come to light in  
center of chamber

Bones have come to light in the  
~~dromos~~ dromos. no pottery as yet.

Bones photographed by  
CWBS Film E #7 (AH 43)

Bones drawn by Miss Cox.

to p. 23

Saturday April 4

Ch. Tomb 2	8 men
Ch. Tomb 3	2 men
Ch. Tomb 4	2 men
Ch. Tomb 13	4 men
<hr/>	
	16 men

20

Ch. Tomb 2  
fr 1.15

The men are still clearing  
out the chamber.  
Byg sherds continue to come  
out.  
we have reached a depth of  
3.65 m and are still finding  
Byg sherds.

Put a man to work scratching  
around the bones found several  
days ago in rear of chamber, and  
have discovered several more  
bones. ~~but not~~ perhaps an  
animal.

we are doing a little digging  
now trying to find the  
drinks.

to p 25

21

Ch. Tomb 3  
(fr 1.16)

The men are clearing out  
the chamber.

a bronze pin has come up  
also another bronze pin

In NE corner of tomb depth  
1.75 m has come to light a  
mycenaean dagger -  
drawn by Miss Cox.

In sifting the soil a bronze  
sack has been found.

Part of what I believe to be the  
handle of the dagger has been  
found. This does not belong to  
the dagger, but is part of a  
bronze knife.

Digging now is done only with  
the knife. Soil is sifted.

to p 26

22 / Ch. Tomb 4  
p. 17

The roof of this tomb has  
fallen in. The men are  
carefully digging it out, beginning  
at the door.

Some amber (or gold?) paste  
has turned up in chamber.  
no shreds found.

to p 27

Ch. Tomb 13  
p. 18

23

Two men are digging in the  
trous. The floor & stones has  
been found; one end was getting  
the sides exactly.

Two men are digging in the  
chamber with knives. Two  
pots have been discovered. One  
bar. These ~~the~~ <sup>date of the</sup> ~~was~~ <sup>was</sup> the doorway,  
also part of another pot.

The pots on south side of chamber are  
classical. The date of the one near the  
doorway cannot be determined as yet.  
(late Mycenaean - Mycenaean type - c. 1500)  
to p 28

24/ Monday April 6

Ch.	Tomb 2	5	men
Ch.	Tomb 3	3	men
Ch.	Tomb 4	2	men
Ch.	Tomb 13	3	men
		13	men

Ch. Tomb 2  
p. 20

25

All digging in the chamber has been stopped. Work was concentrated on trying to find the dromos.

I think we have found the dromos now.  
A. H. Sherb has turned up also a tile.

Failing to find the dromos by digging outside, we have transferred the men to the chamber and are digging for it from inside.

The bones found in rear of chamber (p. 20) have been drawn by Miss Cox.

The body skeleton is fairly well preserved; but has doubled up on side.

Bones taken out of the pottery show the body to have been 18 y. old. Found with body a few many pieces of broken glass have turned up on E side of chamber.

to p. 30

26/ Ch. Tomb 3.

to p. 21

One man is digging in the chamber with a knife. The other two are sifting the soil.

A fair-sized bronze bead has turned up on S. wall of chamber depth 1.40 m.

work today consists in getting down to stones all around the tomb.

to p. 31

Ch. Tomb 4

to p. 22

(27)

Two men are carefully digging out the chamber with knives. No swords found in P.M.

A tile has turned up and some non-descript potshards.

In the north side of the chamber there are several stones. Perhaps they fell from the doorway or perhaps they belong to a later grave.

to p. 32

20 Ch. Tomb 13  
pt. 23

One man is digging in  
the chamber with a knife.  
The other two are sifting  
the soil.

A few bones have come to light.  
Nothing found during day.

tot. 33

29  
Tuesday April 7

Ch. Tomb 2	5 men
Ch. Tomb 3	3 men
Ch. Tomb 4	2 men
Ch. Tomb 13	4 men
	<hr/>
	14 men

Ch. Tomb 2  
ft. 25

The men are digging outside the chamber trying to find the drums.

A few L. H. sherds have come up. C. W. B. by scratching with his knife has found the line of the drums.

A trench has been laid out and the men are now engaged in digging out the drums.

Chamber photographed with large camera by C. W. B.

In the chamber we had reached a depth of ca. 4 M. The present floor consists of fallen rock. If the Byzantines did not get through this stratum, we may expect to find the tomb unrobbed.

to p 35

Ch. Tomb 3  
ft. 26

one man is digging inside the chamber with a knife. The other two are sifting the soil.

One man has been transferred temporarily from Ch. Tomb 2 to throw the dung away from around chamber, at the place where we expect to find the drums.

A few L. H. sherds have come up near doorway, and some Byz. sherds from south side of chamber.

On south side of chamber some of the rock has fallen in. The gap thus formed shows the other tomb. Stereo marks clearly the line of our tomb and we shall limit ourselves to it for the present; later, we shall probably dig out the adjoining tomb.

A piece of bronze has come up from ~~the~~ near door.

to p 36

32 / Ch. Tomb 4  
p. 27

The men are digging in the chamber with knives.

A few L.H. sherds have come up. Promoe and chamber photographed by CWB with large camera.

The chamber is pretty well filled with fallen rock and stones. The stones occupy chiefly the north side of ~~chamber~~ and seem to lie in a rough semi-circle. They seem to have no significance, although they may mark a late grave. The stones were drawn by Miss Cox.

p. 37

Ch. Tomb 13  
p. 28

Two men are digging in the chamber with knives. The other two are sifting the soil.

Promoe and chamber photographed by CWB with large camera. A few L.H. sherds have come up.

A whole L.H. pot and a small piece of bronze have come up.

Some white pots have come up. They are L.H. in date and are in rear part of chamber chiefly.

Bones have been uncovered.

p. 38



34

Wednesday April 8

Ch Tomb 2	4 men
Ch Tomb 3	3 men
Ch Tomb 4	2 men
Ch Tomb 13	4 men
	13 men

Ch. Tomb 2

Apr 30

35

The men are digging out the dromos. Digging in the chamber had reached such a depth that it became necessary to dig out the dromos so as to carry out the earth from chamber the more easily.

The dromos looks as if it may be the short and wide type. Near the doorway, ca. <sup>1.35m</sup> below surface of ground, the dromos is 1.50m wide.

At depth of 9.90m a long bronze pin has come up (length of pin 10cm). Found in center of dromos.

~~At depth of 13.88m at corner leg  
of base a circular object of bronze  
with a diameter of 1.5m was found.  
It has a hole in the center and  
has a hole in the side. It is  
made of a material of a different  
kind than the other objects found.~~

At depth of 1.95m not far from doorway, a geometric bronze base (for a tripod?) has been found. It is semi-circular and has one leg.

Apr 40

36 / ch. Tomb 3  
p. 31

The men are clearing out the chamber with knives

- A few L.H. sherds have come up from near door.

A good many tiles have come up in rear part of chamber also a few Byz. sherds.

to p 41

ch. Tomb 4  
p. 32

37

The stones mentioned on p. 32 have been taken out. Underneath two of the stones on the north side were a few bones.

The men are clearing out the chamber with knives

to p 42

Ch. Tomb 13

Apr 1 33

Two men are digging with knives in chamber - the other two are sifting the soil.

We have clearly reached the Mycenaean level. Several nice white pots have come to light this morning. Most of our pots lie in rear part of chamber.

Some bones have come up in center and north side of chamber.

A stone button has been found in rear part of chamber.

The classical pot mentioned on p 23 has been drawn by Miss Cox. This pot and the bones in center of chamber mentioned on p 18 have been taken out.

Two more buttons have come up. One button and a bead of paste have come up.

Position of paste bead drawn by Miss Cox.

A bronze knife has come up in rear part of chamber. Its position drawn by Miss Cox. The knife lay amid bones and pots, pointing towards doors.

Born from rear part of chamber and of position the doorway, have come up six buttons.

p 43

Thursday Apr 9

Ch. Tomb 2	7 men
Ch. Tomb 3	3 men
Ch. Tomb 4	2 men
Ch. Tomb 13	4 men
	<hr/> 16 men

Later in morning men distributed thus:

Ch. Tomb 2	9 men
Ch. Tomb 3	8 men
Ch. Tomb 4	2 men
Ch. Tomb 13	6 men
	<hr/> 17 men

About 11:30 a heavy rain stopped work for the day.

40

Ch Tomb 2

ft 35

The men are digging out the  
dromos.

In middle of dromos depth 1.60m,  
a large bronze ring has  
come up.

ft 45

41

Ch Tomb 3

ft 36

The men are digging out  
the chamber.

Work temporarily stopped here  
and men transferred to  
Tomb 13 to dig in dromos.

ft 46

42 Ch Tomb 4  
ft 37

The men are digging out the  
chamber.

to p 47

43 Ch Tomb 13  
ft 38

The men are digging in the  
chamber with knives, and  
are sifting the soil.

Work at Tomb 3 temporarily  
stopped and men transferred  
here to straighten out south  
side of drains. One man  
digs with knife in chamber

to p 48

Friday April 10

ch Tomb 2	6 men
ch Tomb 3	4 men
ch Tomb 4	2 men
ch Tomb 13	3 men
	<hr/>
	15 men

A good deal of the morning  
was spent in digging small  
trenches around dromos, to catch  
water of future rains.

In afternoon, men distributed thus:

ch Tomb 2	7 men
ch Tomb 3	0 men
ch Tomb 4	2 men
ch Tomb 13	3 men
	<hr/>
	12 men

ch Tomb 2

Apr 10

The men are bailing the  
water out of the dromos.

P.M.

One man is cleaning the stones  
of the doorway; the others are  
digging in the dromos.

A thin piece of bronze, geometric,  
has turned up, depth 1.65 m; east  
center of dromos.

A few L. H. shreds have come up.

to p 50

46/ ch tomb 3  
ft 41

The men are clearing  
fallen rock from the  
chamber.

P.M.  
no work here.

to f ~~42~~ 53

47  
ch tomb 4  
ft 42

The men are digging in the  
chamber with 10 shovels.

P.M.  
work continues as in A.M.

to f 54

Ch Tomb 13

f 43

one man is digging in the chamber with a knife. The others are bailing the water from the dromos.

P. M.

one man is digging in the chamber with a knife; the others are digging in the dromos.

The doorway is partly filled with stones. These stones have fallen forward a little, probably at time of cave-in of roof. (note f. 49) stones taken out.

a few L. H. shards have come up in dromos.

a button has come up in rear of chamber.

f 49

Tomb 13

f 48

49

Note on stones filling doorway:

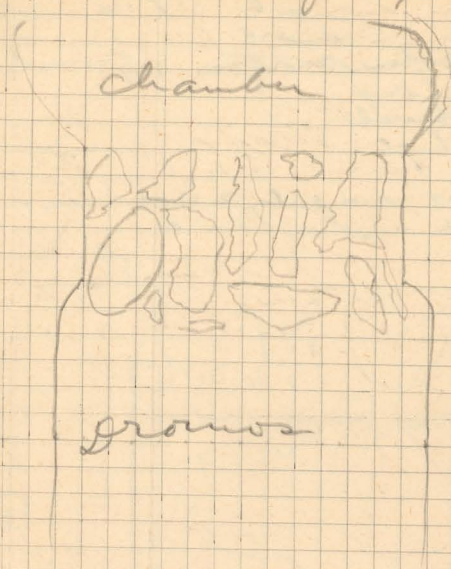

f 55



Tomb 2  
ft 45

note on stones filling driveway in front

- 1.03 below surface of ground.
- 1.55 low
- 1.30 middle
- .60 high

There are, roughly, 2 courses.  
Seem to rest on terrace.

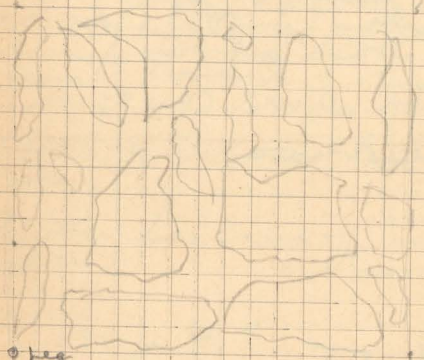

steps

Drums

Photographed from East by CWS Film G. 3  
" " " West " " " 4

Stones taken out

~~ft 45~~ to ft 52

Saturday April 11

Ch Tomb 2	10 men
Ch Tomb 3	0 men
Ch Tomb 4	2 men
Ch Tomb 13	3 men
	<hr/> 15 men

52 / Ch Tomb 2  
for 4.50

The men are digging down in  
the drains and then extending  
it to the east.

After breakfast C.W.B. examined  
the doorway with a view to  
taking out some of the fallen  
stones, and discovered a  
fresco. The fallen fragments  
were put in a tray and after  
washing showed colors of bright  
blue and red. A specialist has  
been put to work clearing the  
earth away gently with a knife,  
and applying plaster of Paris  
to keep the fresco in place at the  
doorway.

The fresco appears on each side  
of doorway.

Small piece of bronze found in  
basement of earth.

Fresco is being cleaned by C.W.B. &  
drawn by Miss Cox.

a button with monogram MP found  
in east end of drains, depth 1.10

Stone arrow head found in  
center of drains, depth 2.40

to p. 57

53  
Ch Tomb 3  
for 4.46  
no work here.

to p. 58

54  
Ch. Tomb 4  
p. 47

The men are digging out the chamber with knives. A few bones have come up. No skulls as yet. We are probably nearing the Mycenaean level & may expect to find pots soon.

p. 59

55  
Ch. Tomb 4  
p. 49

One man is digging in the chamber with a knife; the others are sifting the soil.

The chamber has been pretty well cleaned. Bones and pots lie around the side. In the center two bones at least seem to lie in more or less order; they lie on right side bent at knees. The bones along the side are in confusion and are probably earlier burials.

We are cleaning and sweeping the pots and bones to make ready for photography and drawing.

A pot has come up on N.E. side of chamber.

p. 60

56 / Monday April 13

Ch	Tomb 2	11 men
Ch	Tomb 3	0 men
Ch	Tomb 4	2 men
Ch	Tomb 13	0 men
		<hr/>
		13 men

Ch Tomb 2  
p 52

57

one man is clearing the  
fresco.

The other men are digging  
in the drains.

A piece of bronze turned up  
in drains.

L.H. starts coming up.

p 63

58

Ch Tomb 3  
b + 53

no men here -

b + 64

Ch Tomb 4

b + 54

59

The men are digging out  
the chamber with knives.

b + 65 -

60/ Ch Tomb 13  
p 155

No men here in Am.

Miss Cox and I spent morning  
drawing contents of chamber.

at end of notebook is list  
of objects in tomb.

Pots nos. 8-28 photographed by CWB  
fil G 7  
Pots nos. 28-37 photographed by CWB  
fil G 8  
Pots nos. 37-44 photographed by CWB  
fil G 9

Pots nos 1-8 photographed by CWB  
fil G 10

Photographed from above from ~~east~~ east  
by CWB. Film H1

Photographed from above from south  
by CWB. Film H2

Photographed from above from west  
by CWB. Film H3

A workman and I spent the  
afternoon taking out pots.

Under peg A a piece of bronze (perhaps  
the tip of a knife) turned up.  
A whittle turned up under pot 41 (object 45)

After pots below peg A were removed  
another pot came to light. Will not  
be taken out till drawn. Drawn by  
Miss Cox and I. ~~fil G 11~~ taken out. object # 47

Ch Tomb 13  
p 160

(61)  
A large paste (or glass?) <sup>aged stone</sup>  
turned up under ~~pot 41~~ object  
# 41. The base is of a good.

In rear of chamber there  
came to light a Mycenaean  
dagger, 3 rivets, no inlay.  
Drawn by Miss Cox + taken out.

<sup>object no. 46</sup>  
The stones on NE side of  
chamber taken out  
a cist grave was found in center of  
chamber. To p 66

62 Tuesday April 14

Ch Tomb 2	10	men
Ch Tomb 3	0	men
Ch Tomb 4	2	men
Ch Tomb 13	3	men
	<hr/>	
	15	men

Late in P.M. two men put  
in Tomb 3, digging in chamber.

Ch Tomb 2  
fr p 5-7

63

The men are digging out  
dromos.

L.N. sheets coming up.

North fence photo exposed by Carl  
Film H4

In dromos, 2.85 m from doorway  
and .53 m from north wall of  
dromos, there have appeared  
several bronzes in fragments:

parts of a knife perhaps and a  
arrowhead; also an arrow head  
practically entire. These were  
found by the pick in my  
absence; careful search of  
earth yielded no more.  
Depth ca. 3.45 m

to p 69

64 / ch. Tomb 3  
ft 58

no work here.

In P.M. two men transferred  
here to work in chamber.

to ft 70

ch. Tomb 4  
ft 59

65

The men are digging out  
the chamber with knives.  
A couple of L.H. studs have  
come up.

We have now reached several  
stones, evidently fallen  
from doorway. They lie in  
more or less confusion.  
See drawn on p 67.

Taken out.

In P.M. men from ch. Tomb 13  
transferred here.

~~to ft 71~~  
to ft 67



66/ ch Tomb 13  
p 61

one man is digging in  
chamber with a knife. other  
men are sifting soil.

Bones taken out and buried.

Remaining stones in doorway (except  
those at very bottom) taken out  
under object #12 has come  
up another whorl.

A few shells are being found  
in the sifting.

Whole chamber carried  
down to stairs. nothing else  
found.

Cist grave cleaned, cleaned.  
Bones consist of a skull and,  
beneath it, about 10 fairly large bones  
lying side by side.

Remaining stones in doorway taken  
out, and earth carried to  
stairs, nothing found.

work on tomb completed, except  
draining of bones in cist grave,  
men transferred to Tomb 4.

to p 72

ch Tomb 4  
p 65

67

Diagram showing approx.  
position of stones, fallen from  
doorway. Stones taken out.

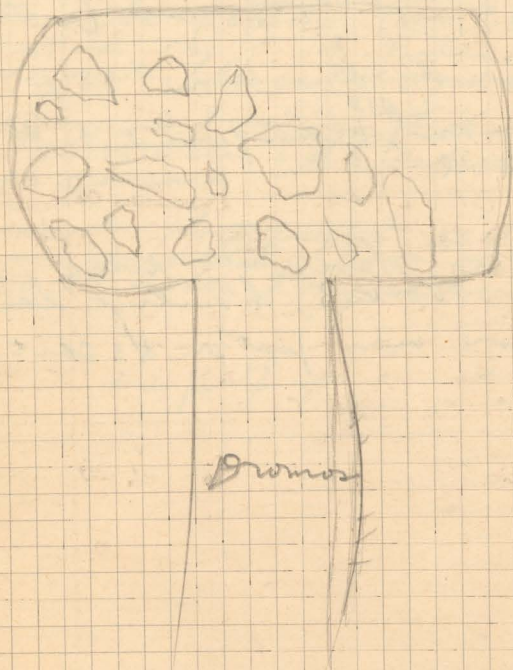

to p 71

66 Wednesday April 15

Ch Tomb 2	11 men
Ch Tomb 3	2 men
Ch Tomb 4	3 men
Ch Tomb 13	2 men
	<hr/>
	18 men

one man transferred fr #13  
to #3.

CWB sends one man to #3

Other man <sup>in #13</sup> transferred to #4  
to sift soil.

9<sup>15</sup> P.M. five men were put  
at Ch Tomb 3, hauling earth.  
Two more men put on #3 carting  
earth.

Ch Tomb 2  
p. 63

69

The men are digging in the  
dromos.

3.90 m from doorway, .55 m from  
S. wall of dromos, depth ca. 3.60 m  
have come up two broken  
arrowheads (bronzes).

Fresco photographed from center  
of dromos by CWB Film I #7  
and with large camera.

Dromos and Fresco photographed  
by CWB Film I #6 and with  
large camera.

Fresco photographed in P.M.  
from middle of dromos by  
CWB with large camera.

to p 74

70 Ch Tomb 3  
p. 64

The men are digging in  
the chamber with knives.

A mycenaean dagger (no gold  
inlay apparently) discovered  
in rear of chamber.

Drawn by Miss Cox and  
taken out.

In P.M. five men were  
put to work hauling the  
earth away from south side  
of Tomb. The reason for this  
is the existence of another  
tomb just below.

Two more men put to work  
carting earth.

to p. 75

Ch Tomb 4  
p. 67

(71)  
The men are digging in the  
chamber with knives.

~~Two~~ <sup>two</sup> fasks and a broken pot  
and a broken pot have come up.

L.H. sherdls coming up.

The fasks mentioned above  
are part of a T.C. figurine.

A whole has come up, next to  
the figurine.

Earth is being sifted.

A pot and another figurine  
have come up.

to p. 76

72 ch Tomb 13  
p 166

The men are sifting the soil.

Bones photographed by CWB  
with large camera. 1 Bone in  
cist photographed by CWB Film I # 8

Bones in cist taken out. Earth  
sifted. Nothing found.

Work in tomb at an end.  
See end of book for list of  
finds.

Thursday April 16

73

Ch Tomb 2	11 men
Ch Tomb 3	4 men + 8 Cartip earth
Ch Tomb 4	4 men

---

27 men

Work in Ch Tomb 13 was brought to  
an end yesterday.

74 Ch Tomb 2  
ft 69

The men are digging in the  
dromos.

L.H. stands coming up.

Stones has been reached in  
a couple of places. The dromos has  
been extended ca 2 m to east and  
we are digging on down at an  
inclined plane.

Fresco photographed before  
breakfast by Curtis Film J #4

Tomb & dromos photographed from  
west by Curtis Film J #6

Dromos ca 18 m long

1.95 m wide at west end.  
ca 4.40 m deep at west end

we may have a list grave near  
~~to~~ east end of dromos, but will  
not dig it now.

75  
Ch Tomb 3  
ft 70

8 men are carting the earth  
away from just south of tomb  
and dumping it west of tomb.

2 men are digging in the  
chamber with knives. The  
other two are shovelling at  
the earth.

at depth of 1.83 m at east end of  
chamber have come up a few  
pieces of bronze - wet and  
digging carefully hoping to find  
a bronze vessel.

P.M.

Digging continues in chamber.

3 men are digging at the dromos.  
The doorway is apparent from  
inside chamber by the stones,  
and stones on either side.

At south end of chamber a  
well of stones has appeared.  
They may be a list grave (unlabeled),  
or more probably represent the  
downway to a side chamber.  
Or, there may be another tomb  
just south and the earth between  
having fallen away, they walled it off.

Two late tiles have come up  
in chamber. Tiles coming up  
in dromos.  
a bone has come up in rear  
of chamber. A figurine has come  
up in rear of chamber; buried it again.

76 Ch tomb 4  
ft. 71

Two men are digging in the  
chamber with knives. One  
man is carrying out the earth  
and another is sifting.  
Another pot and skull have  
come up.

L.H. sherds come up.

Two more skulls have come up.

Three beads have come up,  
just below the pot at left of  
doorway.

Three more beads have come  
up in same place.

Another pot has come up.

Argive Heraeum 1927

H. S. Dartshire.

Apr 18<sup>th</sup>

men 12.

To date temple terrace.

Trench E at eastern end at right  
angles to terrace c. 3 x 9 metres

Trench W. at west end along wall  
to the <sup>NW</sup> corner c. 5 m. from existing trench  
and from 4 to 3 metre wide (to corner).

Trench E page 78, 1

Trench W. page 80.

In face of terrace wall to N I find two fragments  
of geometric and half dozen Mycenaean sherds.

also quick roof tile colored red.

" piece of sandstone cut at the end as if for  
filling in a hole.

# Trench E

EASTERN WALL OF TEMPLE TERRACE

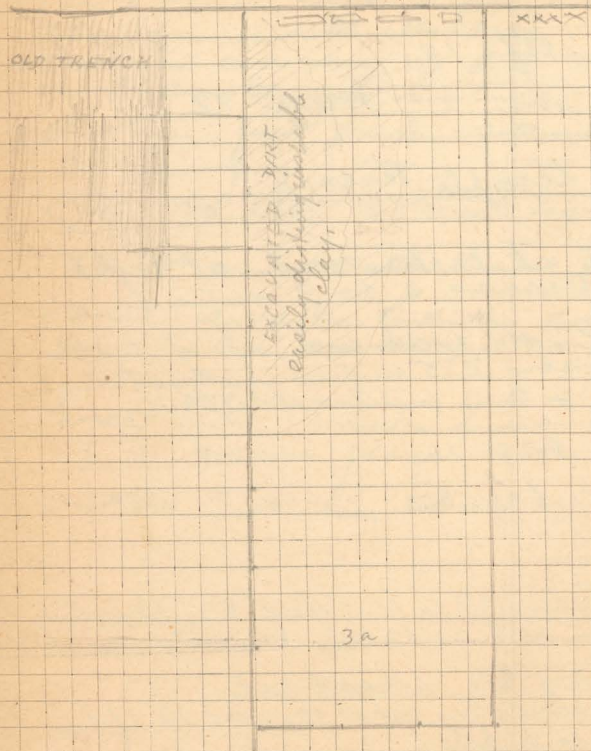

note appearance of stones xxxx facing the temple terrace of poros

1. remove bushes
2. remove excavated dirt. no sherds
3. remove surface dirt, sherds.

excavation to proceed in levels of .20

~~20~~ = I surface dirt - sherd with herring bone pattern  
Mycenaean  
yellow earth and clay, very hard near wall.

I sherds from dump and surface dirt to depth of .20, basketted and so labelled.  
bronze band bent as a ring, overlapping

II few sherds 

III bronze nail or skewer  
few sherds

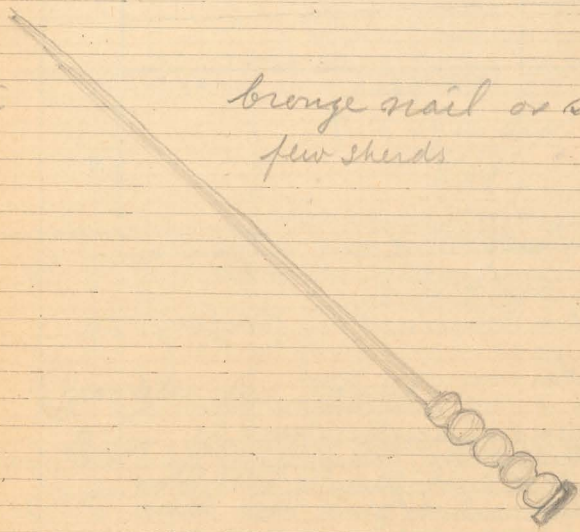

Zimbilia I and II } .20 - 60  
III }





32

April 19

men 12

Trench W.

level III 60-80 going down except at B  
where stools of fill remain  
sherds in gumbali. Some E.H.

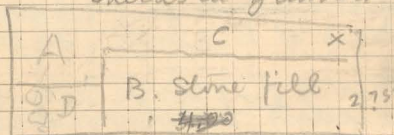

level IV x 80 to 1.00 ring, round  
and full circle with raised  
line

This and the bronzes on opposite  
page were found at C above  
at the side of the fill of stones

The earth is softer than in  
trench W but full of small  
stones

Apr 19,

8.3

Trench W, level VI. 100-120  
at C.

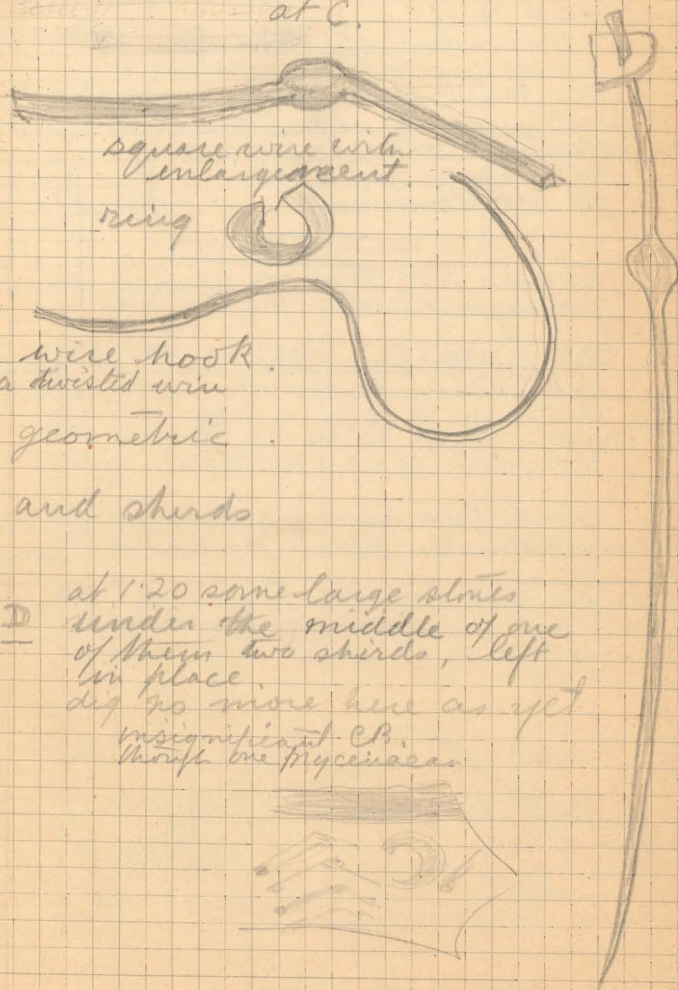

square wire with  
enlargement  
ring

wire hook  
a twisted wire

geometric  
and sherds

at 1.20 some large stones  
under the middle of one  
of them two sherds, left  
in place.  
dig no more here as yet  
insignificant CP.  
though one Mycenae

84

Hole in Old Temple Terrace Apr 19

from W c. 10 m from N c. 10 from S c. 20

remove fallen stones and loose dirt  
2 Mycenaean sherdsat 1 metre, earth harder and wet from  
rotten pores, a few sherds and bronze  
disc (broken) also p. 81  
at 1.30 native rock  
too wet to continue. C.B. sherds insignificant.Towards SW corner of terrace where  
paving missing.Two men to clean away earth to show  
substructure on chance of a similar  
hole and to find sherds

Loose dirt thrown aside

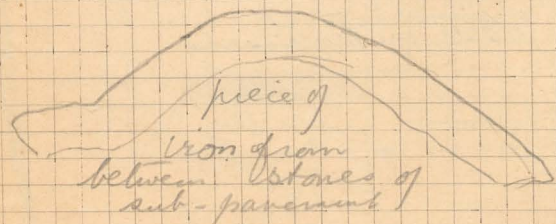
sherds from level of substructure or  
between the stones of it, badly worn, few.The sub-pavement is very roughly  
laid, rising up to the high  
poros block of the outer wall.  
(more than 5 m x 2.50.)

piece of  
iron from  
between stones of  
sub-pavement

C.B. The sherds insignificant

from p 79 Trench E - Apr 19

85

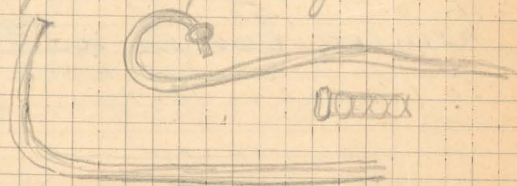
Level III .60 - .80  
sherds in gimbilia & labelled III  
fragments of rotten bronze.level V .80 - 1.20  
fragments of bronze wireand three similar pieces  
sherds on stone & labelled VThe earth is still yellow and  
very hard.There are a good many large  
stones but singly & without purposeThe stone facing of the terrace  
xxxxx continues downwards  
four stone deep nowLabel V continues to 1.40  
(same sherds, though by  
mistake)

to page 88

86

Trench N. Apr 19

Began trench at right angles  
to N. side of old terrace

15 metres from W end,

remove bushes and roots

(87)

Apr 20 <sup>5</sup> a.m. 12

West Trench 2 men

Level VII 120 - 140



digging continues at A to C

glass bead - Box.

bones & shells

soft earth & holes at x with large  
stone over

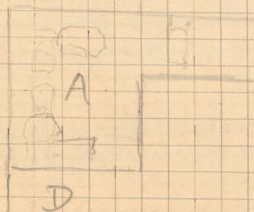

foundation appears  
on ~~between~~ its stones. thin shell



black and brown on warm yellow  
geometric

fall of large facing stone nearest  
old trench at p. 80

"Level VII" 140+ - cleaning foundation  
basketed & so labelled

88

Apr 20, from p 85

E. TrenchR.S.D. late, for rain, and label ✓  
carried to 1.40

label vi from 1.40 — 160

layer of flat fallen stones in  
center of trench2 large stones projecting from  
middle 4". Stone down of facing  
of terrace wall.label vii 160 — 160note possibility that the boy has thrown  
sherds from dump while raking  
back earthThe sherds I see from the trench are  
without pattern.

to page 92

Apr 20.

89

all day 8 men & boy  
until noon 12 men

90

Apr 20

W. Trench

1 1/2 m. wide . . . m. long  
stepped at from .15 to .30  
from terrace edge towards hill  
abandoned at noon and  
four men to tomb area.

one bronze disc as on p. 81. & p. 84  
but without hole in centre.

91

Apr. 21.

Men 6 and boy  
from 7 men & boy

West Trench

+40+, cleaning foundation  
geometric pins and fragments  
arrange to widen A & D by digging  
to S of old trench (on p. 80)  
The fall of the large facing stone (p. 87) has  
made it possible to dig here to the present  
terrace wall.

Level VIII 140+ labelled  
in basket as yesterday's & can go with it.

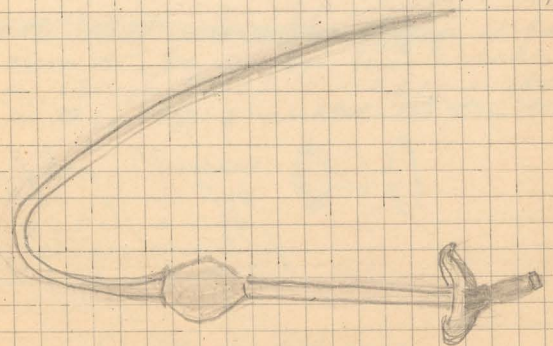

piece of heavy tile.

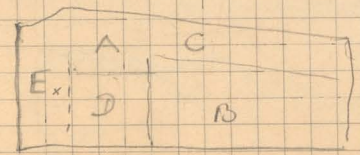

92

Apr 21, E. Trench. from p 88

Level 8. 180 — 200

disc as 1.81.84.90 with hole in center

black seal pierced for stringing



(back broken)

deeply incised thus

 wire pin with  
working point.

bronz pieces

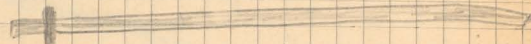
Level ~~IX~~ 200 — 240
 resembles cuff link  
but may have  
seen a pin by  
following dotted line  
dropped in Apotheca.

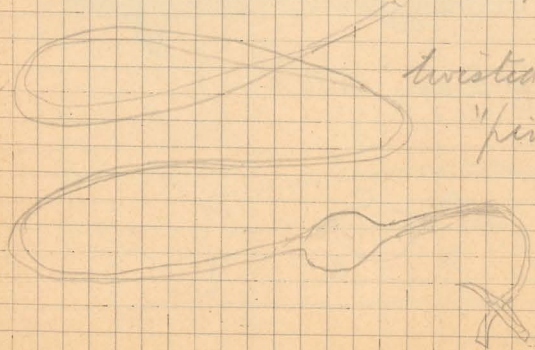
 twisted wire  
"pin"

to p. 93

93

Apr 26

Men. 7. (water)

digging as before

E. Trench, 240 —

fragments of rings

W. headless horse, bronze. at about 1.40  
in E. x p. 91.

sherds from both pits in baskets labelled

C.B. in charge

 note that smaller stones of facing  
seem to be under the terrace wall  
as though the fill of heavy stones  
in E (p. 91) E antedated the terrace

E trench to p. 95

Apr 27

76 men & boys  
and water man

## W. Trench

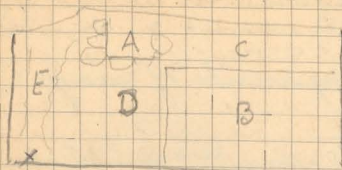

- A. foundation at 140  
 B. fill of stones c. 60 horizontal  
 C. edge of fill to 120  
 D. fill of heavy stones at 140 + "  
 E. edge or interruption of above at 160-80  
 at E level 160-180  
 under large stones D, middle Helladic sherds  
 only

at E under stones of terrace three  
 middle Helladic sherds boxed

W. trench abandoned, two men to look  
 for sherd in face of terrace p. 96

Report of W. trench on p. 99

Apr 27

## E. Trench

near terrace, reach undisturbed earth at 2.7  
 two large stones lying against  
 terrace foundation

at E end on both sides of trench the large  
 flat stones show a slant downwards to the east  
 as if fallen from  
 the terrace.

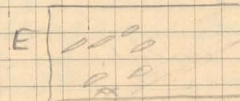

so that geometric  
 sherds found x x  
 are not in evidence for

date of temple foundation

level X 160-180, labelled in basket  
 260-280

fringe wire as before.

" ring of three wires hoops (C)

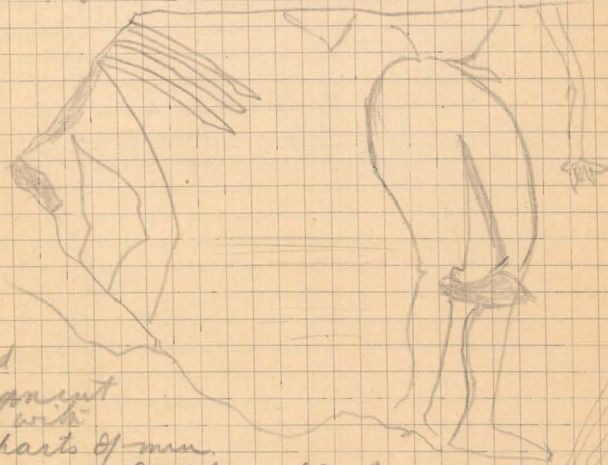

boxed  
 fragment  
 with  
 parts of man

light or black  
 W. The use of the white paint on black  
 is unusual  
 It was in geometric company, a goose etc.

Basket - 280-300. in small central  
 area - to p. 101

Apr 27.

Terrace face

hole between stones of E face, under large block, from earth undisturbed if possible, to collect sherds about 6 m. from SE corner

sherds = 31. period?

hole between blocks on S face under large block from undisturbed earth about 4 m. from SW corner to collect sherds

sherds = 32. period?

Apr 27

page 84. Hole in Old Temple Terrace,

continue cleaning disturbed earth, to dig under platform if possible.

no sherds

removal of earth removes support of large stone which cracks, settles, and makes dangerous further excavation

men to p. 95.



95 Apr 27 SE Trench  
2 men at S.E. corner of terrace  
in view of possibility of a ramp  
turning the corner with outer  
wall in continuation of back wall  
of lower terrace

note that the wall seems to be turning  
and that there are cuttings in the  
corner stones of the terrace.

Trench SE begun in line with S face  
of old terrace & 10 metres from it.

Surface sherds not kept. -  
dd. p 103

work abandoned for present in favor of  
tombs.

Apr 27 Report on W. Trench. Old Terrace. A.H. 99  
For the purpose of dating the Old Temple  
Terrace a trench has been dug at the  
N.W. corner of it.

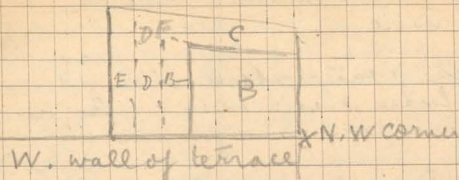

Along the west terrace wall at a depth of .30 is  
a line of lime stone blocks facing the con-  
glomerate terrace or projecting from under  
its top in pavement layer, which presents close irregularity.  
At .40 and sloping to the W is a fill  
5 m from the corner (and 2.75 + westward)  
It is not contiguous to the terrace and without  
structural significance. It (B) is left in place,  
except for a metric from the northern edge.

B - the northern edge of fill B was for 1 m  
removed and together with D its area ex-  
cavated through disturbed earth and sherds  
of mixed periods without significance.

D. This area (B, D) was well used by in-  
cluded E which had been excavated to 1.50  
on some previous occasion, the earth and  
sherds being of the same nature.

E. In E, D, B, and C (at the outer edge of  
the fill of stones (B)) digging was continued  
to a depth of 1.40. Besides the mixed, but  
chiefly geometric, sherds were found a few  
bronze objects of usual geometric design,  
rings, pins or spits, and a thin coin-  
like disc with a hole in the center.

At 1.40 in E was found a small bronze  
horse of geometric anatomy, unfortunately headless.

at this level (1.40 - 1.50) a layer of  
large stone floors the terrace and apparently  
placed under the conglomerate blocks  
of the terrace, whose side is visible at  
the S.E. corner of this trench. At one point  
they seem arranged as if for a foundation, be-  
tween the stones of which were geometric  
sherds (D.F.)

At the face of the terrace, and from between the terrace blocks, well within, were three middle Helladic sherds.

In the bottom of E also at a depth of 170 or more where the layer of heavy stones was removed or interrupted, were found middle Helladic sherds only, grey and red and yellow Mycenaean.

The only conclusion to be made (as to the date of the terrace) from this excavation is that the terrace was not built before middle Helladic times. This has not been suggested, perhaps upon astronomical premises, Waldstein proposes an early date.

It should however be noted that suggestion of Mycenaean origin receives no support from the presence of Mycenaean sherds among others to be expected from the proved use of the site in all Helladic periods.

The possibility of later construction is not in any way denied and rather affirmed than otherwise by the quantity of geometric sherds, bronze,

details on pages 80, 81, 82, 83, 87, 91, 93, 94

E. Trench



OLD TER. FACE WALL

A = not dug below 280 and used for earth from B

C = original slope of hill 270-290 with large stones against terrace base

B = final excavation reaching stones at 3.20

B. sherds = Early, Middle, & late Helladic and geometric!

B. <sup>bronze</sup> work of the same geometric kind at the bottom and spit.

with abandoned yam and men to area of tombs.

summary of E Trench on page 103

from p. 96. Holes in Terrace wall

- 33. no sherds in 2<sup>nd</sup> hole in front wall & therefore no 3,3.
- 34. sherds. Mycenaean and uncertain
- 31. mixed, one geometric. E.
- 32. sherds and label disappeared. S

these together with 3 sherds boxed from west trench between stones of wall

prove nothing.

near to area of tombs -

Summary E. Trench 20

pp. 79, 85, 88, 92, 93, 95, 101.

A trench has been dug at right angles to the east end of the old terrace at the Argive Heraion in the hope of evidence for its date. A facing of hard limestone was exposed going down for four tiers and below that large stones against a mude foundation, which impede search between the stones of the wall for sherds undisturbed since the building.

The eastern part of the trench was full of large and small flat stones which as digging continued were shown to have fallen or been thrown from above, as they are inclined to the slope of the hill as if in situ.

The character of the sherds and bronze was without relation either to depth or distance from the terrace. At the original slope of the hill were found at a depth of 3.10-20, sherds of Early, Middle, and Late Helladic period and one of probably geometric but possibly late Mycenaean. On the bottom also were bronze wires a pin or spit.

A sherd with parts of two men, in white paint on black (p. 95) - probably geometric, was found at 2.80.

The bronzes were pins, spits, votive discs, and rings of geometric style, the same from top to bottom. The best was a pin (on p. 79) 60m.

This investigation therefore has proved nothing as to the date of the terrace.

Its evidence agrees with that of the trench at the west end in the predominance of geometric remains and in showing the antiquity of the site and its use at many periods.

Of intrinsic interest only a seal (p. 92) should be noted.

Apr 28, 1927.

Eight Men

Hill Qirogalera. for Tombs  
 = Qiro Galera - old Galera  
 George Ἐσπάρτης suggests "round  
 sheep folds" for derivation.  
 100 yds. up into the ravines are  
 several such enclosures and  
 water breaks with polygonal stones -  
 (called "new" by George).

Trial trenches.

in four trenches nothing found  
and stones near surface

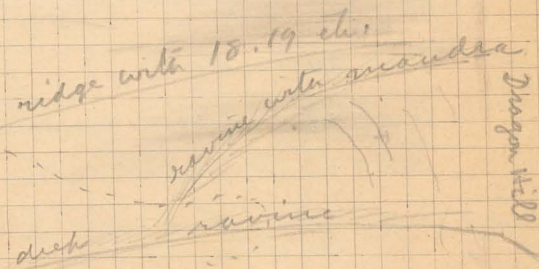

(Hill of  
No. 1)

- B 28
- 24
- 25
- 26
- 27

23

Pit nos

Apr 29. 20 men & water  
48 in all, Min C = 22

trial trenches on quarry hill at  
glacier like place below green bushes  
nothing shown and work here to be post-  
poned after today for George's convenience.

trial trenches along ravine A & B, below  
patches of bushes.

nothing as yet, perhaps too near a trap for  
trial trench on hill of Tomb 1 when road  
runs along top of an outcrop of pines.  
from W to E.

✓ Tomb 24. Shards

Tomb 25. Shards

trial trenches above on this hill

(22) Tomb 100 - along same ledge facing deep  
ravine S. westward - Shards

✓ a higher trench discovers fragments  
of a large pitheon and crackle ware?

Dragon hill, trial trenches, steno

one depth of earth connected with  
1347. Sherd. perhaps.

no shards on this hill

one trench of deep earth

Apr 30. ? 31

Road ledge

No. ~~23~~ 23 Dig out dromos (2)

No. ~~22~~ 24 " " " (2)

men from quarry hill to trenches A & B  
along ravine bank

line of road ledge continued (7)  
discovering more entrances with shards  
No. ~~102~~ 25 " " "

~~X~~ layers of stones where 26 expected ✓

✓ No 26 " " "

✓ No 27

continue clearing entrances

Ravine ledge

✓ No. ~~21~~ 22 dig out dromos (2)

continue line of ledge (8)

(shaphogard trenches between 101 and 100) (6)

(Pitheon trenches left for inspection)  
Nevertheless shards

work on Dragon hill

(10)

deep trench shows soft earth for considerable  
distance as if for large dromos (4)

There are large stones in it  
and it is directly below bushes, sherd

above the upper side of a rough wall (unclear)  
follow it and find fallen wall  
" or grave covering (2)

May 2, 1929 Men =

Trench below road carried along from 23 southward - Tombs No 28 probably 29.

No 23. The stones of the door were fallen in clearing entrances, sherds to zimiti marked as on map p 105

No 31 at X on p 105. The layer of stones opened. 2 sherds and soft earth below

No 27. doorway stones in place

No 28 diagonal dromos in turn of rock

p.m.

widening entrances

all these dromoi 27-28 are wider than at first supposed

No 22 promises well. presence of good sherds. a piece of cobalt.

widening Neolithic trench & collecting sherd of poor quality and late date. obsidian. Neuen type a deposit in a hollow, black overlaid by yellow. Uncover the black

May 3 = Men = widening entrances continued

No 31 x is a fill of stones with black dirt in & under

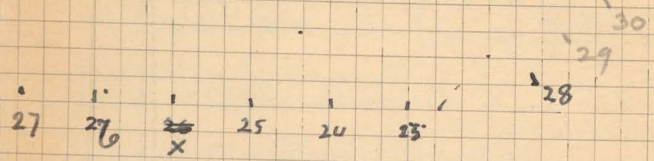

No 28 paste bead in dromos, blue

No 30 entrance shows & dromos hole shows open comb.

No 29 sherds found, narrow entrance & dromos showing

No 31 x a Palace style sherd, good sherds few

No 27 bronze knife blade and one rivet found at entrance of dromos

No 24 sherds large & small

No 25 well dromos & small door

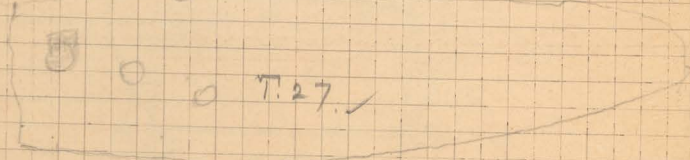

No 26 wide dromos, well under rock

No 27 see p. 113

X to be called 31

No 22, dromos running deep

No 30 hole south of Cliff Road

No 31. Leave 31 for experienced workmen after removing fill of stones, a wall of them at the back & well under the rock was found to be built against stones & part of rock pile below which a bone now appears

110

Neolithic hollow w. Yungulera

yellow dirt

black dirt

and

comp. of small stones & black dirt

stones & black dirt

Obsidian and shreds as before, polished incised beads shreds and some with painted pattern, very much effaced. The deposit is late neolithic.

Tomb No 23.

111

May 3

door sill only in place 1.34 wide of about a dozen stones, .20-.30 high the fall of stones inward is .60 thick among which are two large flat stones dromos shreds without pattern parts of stone basals

Remove fallen stones note that the ledge has rotted away leaving the doorway .70 forward of present rock 2 men with knives part of the limit pen One bone only at high level

May 4 2 men with knives.

- A-B = 1.34
- B-C = 1.44
- A-C = 2.09
- A-Bone = 1.80
- B-Bone = 1.20

inside of door N. to S.



bone probably not human!

two halves of a path bead.

May 5

bones on west. very hard bottom remove door stones, 3 tiers abandon to wait for good man

The entrance to this tomb was found on Apr 30 long  
 show of disturbed earth in the trial trench. On  
 May 7 the door was found in place as on the  
 opposite page, of large & irregular stones, partly  
 fallen, but standing, 1.60 high & 1.60 wide.  
 The door, 7 m. in <sup>total</sup> length, is of a metric in  
 width at the bottom, but widened irregularly  
 above by careless digging or original accident.  
 Its height at the door is 1.60 - 1.80 owing  
 to collapse of the whole ledge over the tomb  
 drums & a dip in the surface level.

A bronze knife blade .9 centim. long with three holes  
 and one rivet was found on the drums at the door  
 in the grave later an iron bar and paste bead.

This was dug from above as the door was found  
 fallen when the stones were removed. The ledge  
 was cut back for safety as the grave was found  
 to extend under its decayed remains.

The grave is unexpectedly large in relation to its  
 drums, had reached tomb by May 13 but waited for  
 knife workers until May 18 when stones bordering a  
 cist were found in the NW corner, about 1 x 2 metres  
 and from 35-50 deep. The stones <sup>in two courses</sup> are roughly built &  
 two to three thick. The rest of the floor space was covered  
 with stones fallen from the door. There is a  
 large heap of bones along the W wall and along  
 the back part not taken by the walled cist.  
 Upon the removal of fallen stones the floor presented  
 a confusing mixture of stones, bones, & shreds of an  
 undistinguished generation.

The grave measures 3 x 4.60. The large cist con-  
 tained bones only. A figurine and needles and 2  
 rough unperfected jars were found in the bones  
 which extend from the stone wall eastward and  
 along the east wall. There is a cist with  
 bones in front of the heap of bones along the  
 west wall extending 1.25 from the outer wall  
 to the stones of the walled cist. In this was found  
 a large bronze nail or rivet. Under the bones  
 to the right of the door was a cist like depression  
 of considerable extent and uninteresting content. <sup>bottom</sup>  
 It seems to begin with, but at the bottom of the cist  
 5 pounders and four whitestones, showing that the cist  
 was once a man of action. The depression contained 2 cist.

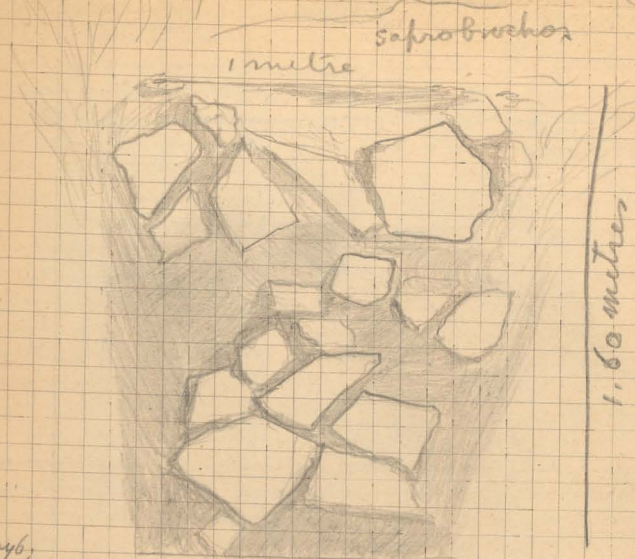

maybe  
 open door fallen.  
 fragment of figurine on stand





114 ✓

Tomb 24

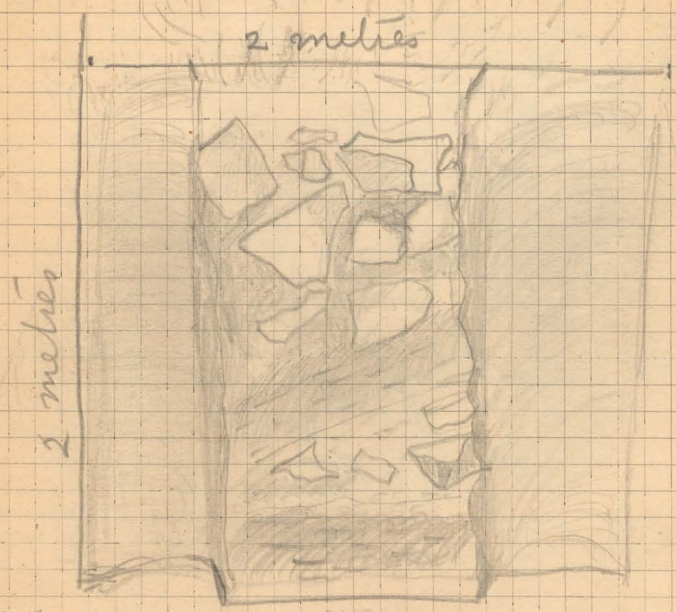

May 4

Projecting FALSE FRONT - removed.  
 door found, from which these stones had been pulled  
 very large drums  
 lengthen opening  
 same measurements tall than door  
 in middle of wide drums.

75

May 4, 24 men ~~to take~~ 115-  
 Tomb 29. ~~head~~  Breadloaf  
 of steatite.

31. bronze



fragments of other possible head & ring

27. fragments of iron bar

30 difficulty in finding or following drums  
 complicated by direct action bar opening  
 shaft to hole which is a small  
 recess ~~in~~ in fallen ledge -  
 is now a small grave with door sill,

22 stones of doorway show at depth from  
 surface of 2.30. in main drums

30

 ← sketch  
 (two of them about same size) 3 for 31)

✓ Next time... shards & obsidian  
 note arrow head, a box  
 white flint,  
 handle of large pot  
 incised black shell of some size

30

116

May 5 Then 24

30. present appearance



The x dirt is all soft  
A. perhaps a small grave

- ✓ 29 lengthen dromos. stones of door showing at both of trench .80 wide superseded. → 1.40 to stones
- ✓ 28 1.60 wide under ledge without stones, lengthen dromos, possible doorway
- ✓ 23 sill removed & left on location of traces of a skilled digger
- ✓ 24 sill showing, already 3 meters of trench back from well & 3.20 sideways go no lower without skilled digger
- ✓ 25 lengthen dromos
- ✓ 26 careful digging in small space undy collapsed ledge, remove part to E.
- ✓ 27 lighten, with dromos & enlarge tomb
- ✓ 22 note dromos not straight, door nearly clear

Neolithic

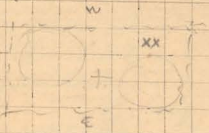

not shown in circles, obsidian at cross circles imaginary area with few sherds & 4 scraps obsidian. The sherds had as before but show handles and abortive handles

Tomb 31. x. summary to May 4 = 117

Digging began here as elsewhere at variation in bottom of trench. In black earth layer of stones found instead of dromos. The stones, rather a fill than a layer of large stones a meter in depth in black earth. There were no dromos but unmistakable white stones in which was the pit from which the stones have been removed. The pit ran of sapro-broches as dig one findings of stones which at first seemed to be possible door with black earth. The width of this pit is about 2 m.

Under the stones first removed were two sherds after which a grave was expected. The sherds found among the stones removed were of good Mycenaean style, some "palace". Under the stones was a bone.

The workmen here were feeble in mind and body and work was interrupted until a more reliable man was available. He immediately found an arrow head & fragments of another of a size 20. It seems that the width of this pit was of a wide dromos & that its lack of height is due to a collapse of the ledge of rock whole.

May 5 The soft earth proceeds under this, especially on the east, and removal of the ledge (to be needed) fragments of flint with line of dots and of knife with rivets

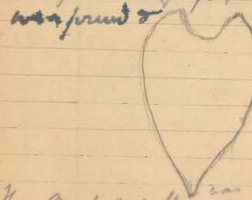

next the knife at the back to the west a broad arrow head of obsidian, good sherds as before encouraged expectation of burial in the grand style which the sign of the pit and its filling of stone had not at first encouraged.

No good work removed until dromos found perhaps under a collapse of stones when it should be visible but was not. Further digging in space 3.23. (the original area having been increased by digging from above and removal of dangerous overhang) uncovered in the soft layer (with a black earth), a bears tusk, spearpoint (bottom), with shank inside, point of an arrow head, part of tweezers, arrow heads, part of knife blade, and another knife. The find of a gold pin head (antique sided bar larger toward middle where bronze remains from a former pin) seemed to justify the interest aroused by the

1174

May 6. Men 23

- 18  
26. Dromos, bronze arrow head  
and piece.

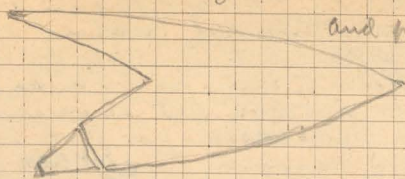

27. opened fallen

22. Miss Cox draws door, & measures,  
opened through fall of stones (& door)  
fallen, (p. page 140. D.C.)

29. paste bead.

30. large fallen door to larger tomb, began  
digging from above.

31. boar's tusk

spear point with wood, broken, bronze  
heavy.  
point & arrow head, & end of notch  
fragment of bronze implement  
possibly two-layer points



Review Neolithic area

In digging a trench for tombs on the west  
hill of Garogalis, west of the Argive Museum  
a strata of small stones and black dirt was  
reached shortly below the surface. The area was indeed  
on the surface of this, between the stones, and  
under them were found Neolithic sherds & obsidian  
especially in two pockets (A & B), in which  
the black sherd-bearing <sup>soil</sup> was deeper than elsewhere  
but without regular outline. The area was  
irregular, but roughly tetragonal (2.60 x 2.80).  
The deposit in some places was as deep as the  
edges as anywhere, and in others became less  
deep as the edge was approached, and also more brown.

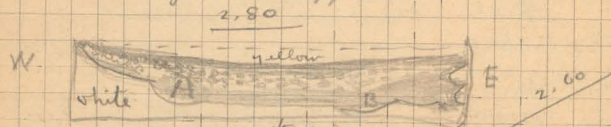

Sherds were found in the brown earth as well as  
in the black, almost grey-looking dirt, and seemed  
of the same quality throughout. When between the  
stones, they had become almost part of a conglomerate.  
The quality of the sherds was very poor and they  
dull like and their condition miserable.  
There were a few sherds of black ware with incised  
runs. Painted patterns could be seen but not de-  
scribed. The polish was good in a few cases only. The  
handles and rims were of characteristic neolithic de-  
sign and there were no sherds of other periods.  
The obsidian ~~was~~ was of the type found at Minus  
and included a good arrow head & 80 blades or  
fragments. There were fragments of bone but no ashes.  
The few larger stones in the deposit were without  
relation to each other or to a building.  
Our knowledge of neolithic architecture is not advanced,  
but it is interesting to have our knowledge of the antiquity  
of human habitation in this neighborhood confirmed.  
and the venerable antiquity of even a late neolithic  
pottery evokes an interest which their appearance  
does not allow. These humble fragments have  
their part in the history of man, and his necessities,  
conveniences, and art; and the archaeologists have  
a present value for comparison with the few neolithic  
deposits known in the world.

120

May 7. Men 25  
states of the graves & the

- 22 digging within door shows full to be general must dig from above.
- 23 opened and empty. narrow
- 24 drums to be lengthwise going to a meter depth on outside of door, grave still to be dug near v. large & promising
- 25 deepening drums, doorway showing 3
- 26 pit half under ledge, fallen, good shield 3
- 27 deepening drums 4
- 28 opened, fallen in, post found 4
- 29 door exposed v. steep, deep narrow 2
- 30 digging from left to level of fallen door

31 bronze arrow head & part of knife  
blade showing rivet hole  
2 more arrowheads on showing rock holes  
all at location of post, & parts of them

June 29

121

very steep deep narrow drums

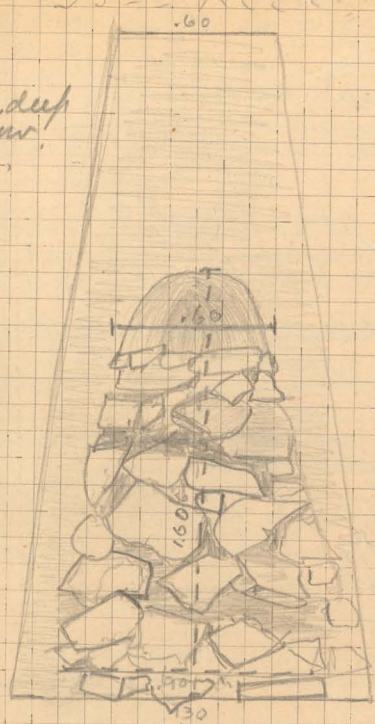

Drums at top .60  
" at bottom 1.30

stones fallen out at top  
top stones .60  
bottom " .90  
height of door 1.60

built forward at the bottom

May 7. remove stones double row at 11.45-  
chamber intact floor covered with extremely  
loose silt to apparent depth .05-10.15  
No fallen stones except at extreme right of  
door where there seems to be a small side  
chamber. At the back of chamber appears a  
great heap of bones. In the right corner is  
a large pit. Further to the right a still  
larger pit. In right corner many traces  
of wood, brown, carbonized, seems to extend  
over well defined area c. 1.20 m. long x c. .90  
wide. The first mentioned pit is within this area  
the possible remains of a coffin. To right of this  
is another area containing remains of wood, looking  
almost circular, but perhaps part of first area.  
The decompositions of wood come between the pits  
and are rotted not burned.

122

The wood may be either a birch  
 than coffin and the extensions from the handle  
 The grain shows on the rotted wood and on lime accretion.  
 Main box measured and drew the outlines  
 of rotted wood and with the help of the diast  
 of grain has made out the use of 18 in planks  
 & heavy corner pieces.  
 As Mr. Blegen was leaving the door was replaced on  
 May 12 found:

- near door to left, paste beads, small dark  
 within the door many bones & some shells, clay  
 beads. At the back two figurines (a woman  
 and a bull).
- Cists ~~2~~ ~~in the center of the right hand side of the pot~~  
 in the center of front the door c. 25 down  
 flat stones extending inward & possibly over cist.  
 13. 2 small out cists & pocket of bones with shell  
 in SW corner.
- RECESS ~~13~~ ~~many buttons including~~  
 a hollow set of conch shell & large paste bottle (broken)  
 a broken alabaster for fragments of, small paste bead  
 13 balls ~~lime accretion~~
- 24  
 bronze with rivet, lead wire  
 Small paste beads  
 with presence of Early Helladic spool  
 figurine 2" feminine, ~~in~~ in back cist off door  
 chryseid bead
- cists 18 cist to left of door lined with fine shells  
 A native TC table a birch shanking slate in cist at back  
 An Egyptian sherd with a red Orantides raise  
 the average of the pottery

In the recess to the right covered by the only fall  
 of dirt in the tomb (save the light dirt sifted  
 down) were two large L.H.D. pots, a bronze  
 mirror, fragments of an ivory comb, a broken  
 alabaster box or bowl, and a bronze bowl, together  
 with objects bracketed above to "RECESS".  
 There was a black deposit under the bowl  
 also under the mirror. One of the large pot  
 had a cylix for stopper & cover.

Tom 6 25 ✓

123

doorway 2.30. 70-75 cm width. 50-110 bottom  
 width of doorway 2.10. at bottom.  
 height of " 2.60

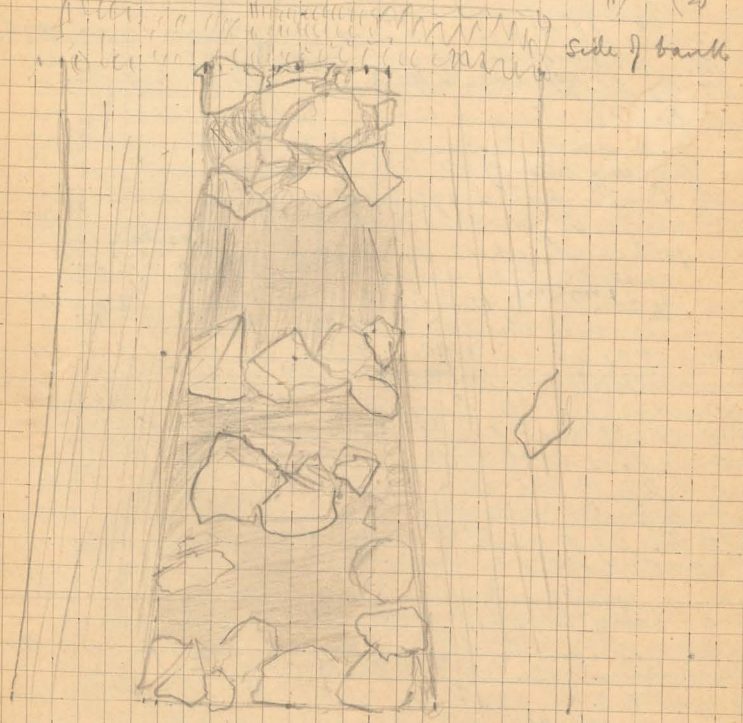



12/6

May 9. 24

27. opened, fallen & waiting  
for clearing

26. wide dromos being deepened  $\frac{1}{2}$   
fallen doorway & high level of  
gravel dirt within

dig from surface between 26 & 31

31. g.w. drainage in narrow area  
from earth crushed under  
ledge

$\frac{1}{2}$  door to right, from remove  
stones

25. dromos & doorway, being  
dig from above

24. dromos ready,  $\frac{1}{2}$  door &  
within earth a mile from level  
of dromos to level of grave

23. narrow, small, empty  
and disappointing

28. dromos ready &  $\frac{1}{2}$  m. down  
left with cart inside well  
below dromos level.  
left on better digger

29. walled up dummy NB's  
absence

30. dromos with  $\frac{1}{2}$  door  
and cart in grave at  
high level. also in  
pocket to left

left for the present

22. dug from below as far as safe. dig from  
above, hill wounded by falling stone

May 10. Men 25

26. V. principal piece of plane, bronze  
from front but broken.  
kicked up in dirt in dromos

127

3hr.

27. narrow dromos, fallen ~~ledge~~  
necessary to cut back ledge from  
-left

26. 1.25 metres up inside, deep & wide  
dromos

31. no more black earth, stones of door to right  
digging level over it to 26 which is may  
enter from within NB. 31 was heavily  
built over in front with flat form of rock (and  
has no apparent dromos)

25. digging down from above to top of door way

24. men deepening within now removed to look  
for beehives on the horizon bones in view  
very large 4.00 across and nearly  $\frac{3}{4}$  back  
from door ~~rock~~ fallen & removed  
half way overhead

23. a miserable pocket

28. earth down within to about .25 above  
steres level in dromos which narrows  
towards entrance, rock fallen and re-  
moved overhead  $\frac{2}{3}$  of the area which is  
3 m. across and 2. x 0 back. intended  
knife man did not arrive

29 & 30 as before

22. work from above approaches excavation  
below, dirt falling continuously, at each  
blow of pick all day

no 28 is the best of tombs for a resurrection

128

May 11. 24 + water by

- ✓ 27. turning into a large tomb, with N. at W. a metre deep towards 26 larger to W than E = mistake
- ✓ 26. 5.50 am. to back of it and loose dirt as if to join 31. men out. fall of rock
- ✓ 31. with door apparently to 26 clear from top between 26 & 31
- ✓ 25. going down from above, removing stones on p. 123, photographed also
- ✓ 30. Bill digging, perfect wire lead pot.

all one tomb

23. 4. 8. 9. waiting

✓ 22. cleaning from below dirt from shaft from above

✓ N.B. graves in field below ridge probably middle Helladic  
 expected pits. Sherds from above rather recent of plough

May 12. Men 27

129

- ✓ Trench begun to E of 27
- ✓ 22. small thalamos, nearly clear 4
- ✓ 27. clearing thalamos, digging with knife for walls of room but shed found 4
- 31 } removing dirt and fall of rock 4
- 26 } between them
- 26 } remember stone of door to E of 31 2
- 25 } down from above nearly to floor level 4
- 25 } possibly not far enough back
- ✓ 24. working & ready for good digger, but find small pot
- 23. fit to hold zumbela
- ✓ 28. two good men going to floor level + boys 4
- 29. closed
- ✓ 30. 9 pits showing & cleared floor 3
- ✓ 30. paste beads & fragment of bronze ring
- 29 " beads } CB, main box, small clay
- 29 " lead wire }



130

GRAVE

XI

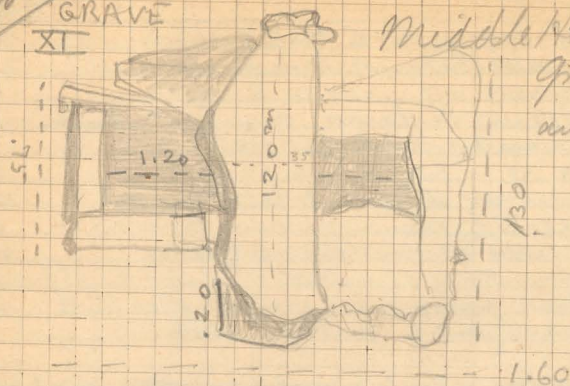

grave XII. to the S. W

" XIII

XI. grave built of stones with  
cut from N to S. made of  
large and small slabs of  
limestone. Slabs set on edge form  
grave, approximately rectangular.  
Inside dimensions, 1.50 wide  
1.18 long  
outside - 95 x 1.55  
one cover slab still in place across  
middle, running transversely across  
middle of grave.

P.C. button, large & small pebbles, stone under



bowl, with handle gone, perhaps middle of

The grave contained bones of an adult  
and child.

May 13

June 24.

131

30. note bones swept aside but no  
central interment  
8 pits with  
cleaned to stress except in bone pile

29 Sep 122

30. 4 cleaning, Two coarse lab. pits. Many other

27.

24. 2 " very high for knife work, we find  
flint tools for

25. 8 going under the cut from above, but at high  
level. part of tropical bones. cut from above

26-31 cutting to 26 from side & behind

31 cleared of  
rock fall  
cut from above. Middle Hallade seen in 36

27 ready, dug to bones & left

27 - tunnel E. 22 & 23. Shallow ditches 4

22 4, cutting down gently to remove weight  
from chamber ceiling; nearly done.

1 working tools & 1 case

May 14

28 + 1

- ✓ 33 digging to down } 4  
 32 } 7  
 26-31 removing "cluck" fallen above  
 ✓ 23 digging from above to avoid risk of fall 4  
 24 } 5  
 25 } 3  
 22 } 4  
 21 } 1  
 20 } 1  
 19 } 1  
 18 } 1  
 17 } 1  
 16 } 1  
 15 } 1  
 14 } 1  
 13 } 1  
 12 } 1  
 11 } 1  
 10 } 1  
 9 } 1  
 8 } 1  
 7 } 1  
 6 } 1  
 5 } 1  
 4 } 1  
 3 } 1  
 2 } 1  
 1 } 1

work interrupted afternoon by heavy showers

- ✓ 30. small grave to left of drains opened during my absence had beads only, seems paved with small stones

measures, width of door .80

2.40 height of drains at base

thickness of door 35-40 in center of drains

stands in place c. 80 high

width of drains c. 60 up to 1.10

length 7.10

glaze 2.10 deep 2.35 wide (paved corners), with inside to left of door

The careful nature of this stone construction and the apparent custom of superimposed burial had led to expectation of a lower burial within the stones, or at least a cist below. Nothing however was found, save on the floor level (when the last stones were removed) within the rest of the floor of 31, one J.C. beetle and 1 very large staphylinid beetle. Also fragments of a NE corner L.H. pot against the N wall c. 65 from the floor. This disappointment was allayed to some extent by their appearance of built stones about 60 above the floor, as if opening from the level of the removed platform of stones, in the N wall of Tomb 31 at the NE corner. The door of small round stones measured .80 x 1.00 and seemed after removal began even larger. More stones in black earth were behind and then more stones and stercos.

This was possibly a support for the N wall of 31 but as they needed no support may have been an attempted mausoleum chamber in which to bury the upper skeleton (St. Sebastian), abandoned on account of the hardness of the stercos and then built up again.

The present shape of T 31, as quadrangular with this niche 1 m. in diam., 2.60 deep and 3 wide (the depth being from the door from T 26).

But fallen a filled earth shows in the west wall and may hold other fragments of the large palace style ware which appeared at many places. Anything possible in T 31

The relation of T 31, as an inner chamber of 26, to the fill of stones and black earth with finds (page 117), which was reached by following the usual signs of a usual drainage from the trial trench, remains unexplained and there are no measurements. Some stones remain in the top of the S wall of T 31 which were part of the fill removed.

There is a rise of c. 20 from T 26 to T 31. The door was plainly not opened at the time

when T 26 was emptied, but the presence of 19 gold headed rivets only shows that removal had taken place.



136

27, nearing floor, stones bordering cist at back, 4  
to left

32. small, digging in the door, 1/3 fallen  
x well walled but irregular, large stones at top  
33 " " " " mostly "

22 nearing bottom from culagid top (3)

occupying nearly width of dromos 1.20  
x large stones at right side  
32 ✓ width 60-80 height 1.20 in place  
thickness = .90

29. pendant shaped carnelian bead  
opposite door 2 = cist  
inward

26-31 earth between removed revealing  
wall of large stones fallen in  
on 26. The well built wall  
against the door c. 2 meters high  
31 ✓ arrowhead with door in 31

33. .60 in height left x superseded.  
.70 wide  
as yet bottom stones above dromos level, 1.10.  
dromos width 1.65 at bottom  
1.45 at top of remaining stone

width of stones  
at bottom  
= .90



later: -  
height 1.50 of door from  
bottom  
thickness  
width at widest 1.10  
the upper stones  
project, the lower  
show appearance  
of courses

Dromos, floor remains 5.35 long  
width at entrance 1.35

T 33

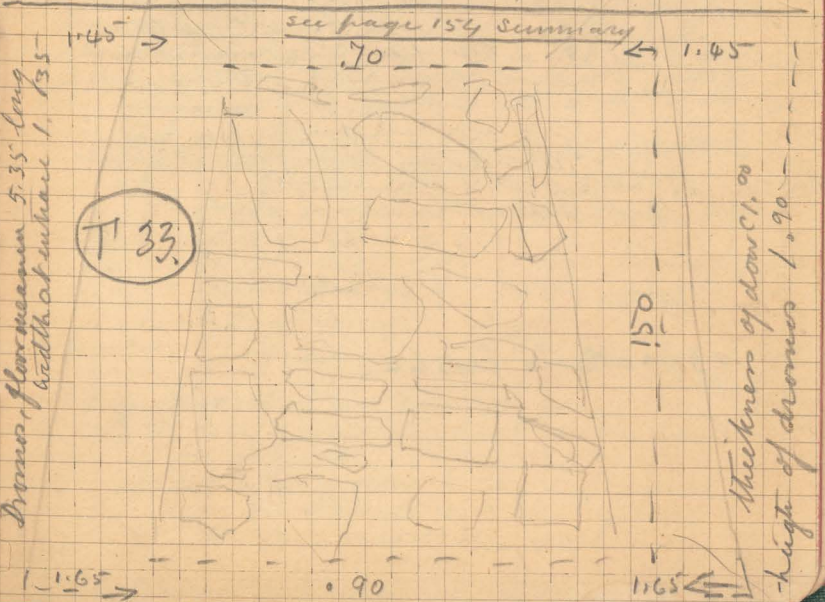

May 19, 1927 26 + water

137

30. emptied  
29. Basil & Athanasius cleaning cists, seven, (2)

28. Drawing finished, undisturbed area under pits

23 as before

24 " "  
25. Clusters, short sword broken, .28 1/2 length (1)  
double ridge narrow & sharp, pieces broken  
good substrate fabric, matt painted limestone shell (6)

26-31. clearing fallen wall  
network of stones on floor? calling small

27. cists, large one to NW cleared - bone only,  
figurine, fallen inside of door on floor (3)  
32 digging down inside door (4)

33 " " (6)

Grave XI. Stone pavement under upper part  
woman and child.  
22 ✓ Child imaginary  
Miss Cox draws grave 22 (3)

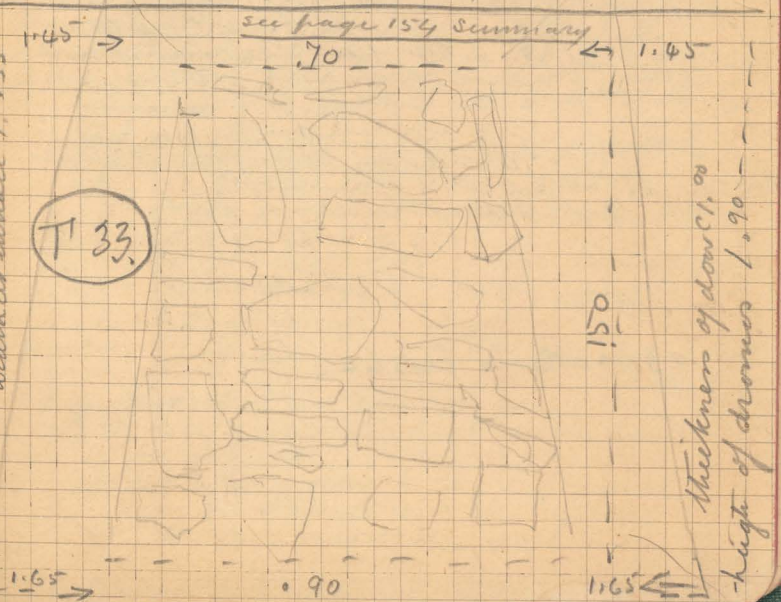

28. 2 beattons, T.C. note  
 proximity to skulls  
 good Egyptian pot with rosette shading
- 26-31, large stone, probably from dromos  
 door C. 70 x 50  
 both door and part of wall fallen inward
- door C. 1.20 wide at point .50 above floor of dromos
22. reach paving disk
25. extreme bedders of fall surrounding  
 mott painted vase

26-31 ✓

x the left hand door jam reinforced by well  
 built wall on inside  
 has thickness of 1.35 & slopes inward toward  
 top undoubtedly giving one side of the door of 26  
 The door is symmetrical with relation to  
 dromos, each jamb having face of C. 55.  
 The right hand jamb is fallen away so  
 that we have not the thickness.

In removing the wall between tombs, ivy-pattern  
 sherd and bronze arrowhead were uncovered  
 another "

- It is a door 1 meter wide, 1.40 from outer  
 wall of 26, over 1.20 standing, very regular  
 & well built of large flat stones, esp. below
26.  $4.15 \times 3.86 =$  area of 26
31. inside door: bronze <sup>dagger</sup> ~~knives~~ & <sup>left</sup> 2 pieces  
 tweezers, broken but complete
29. glass beads from back of tomb

26 Dromos. Cylind. 2 outside door.

3 arrowheads CWB 62

- 33 digging out grave under ledge 8
- 32 ✓ 4
- 27 ✓ cleaning between stones 4
- 26-31 ✓ cleaning doorway between ~~4~~ 2
- 25 ✓ cleaning Molt pot in corner very far 3
- 28 ✓ Sift <sup>bottom</sup> & sword rivet. + built on 1
- 29 ✓ collect boxes of wood: cypress & lime coating 3
- Seive 2
- 22 ✓ reaches paving disk and pen pots 4
- 26 ✓ arrowhead from under fallen stone of  
 inner door, put by men with 136 from 26.
29. TC table found, figurine  
 and bronze knife. 18 1/2 long, for  
 stabbing. 3 rivets in place



9 cists in floor

note that one skeleton had rested on  
 remains of wood in right center,  
 also large broken pot with upright  
 lines 1.40 from roof to top of pot in  
 original place  
 The shape of the tomb is roughly  
 as follows, showing cists, of which the wood  
 was over 102

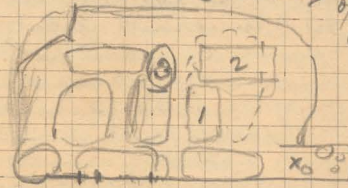

finished

the large pots  
 at x.

The figurines  
 at 3.

25. good ivy leaf and other pot found  
 to left of door in what seems hard  
 conglomerate,  
 apparently a door to the left and  
 possibly opposite to the right,  
 as the centres of the walls

I measured with my six 25, 24, 23, 28, 29

## Tomb 24. Review.

Traces of disturbed earth and shreds were found in the trench opened on Apr 29, which led to the discovery of the dromos to this tomb. On 30 May 2, 3 the dromos was dug, 2.30 deep at door and 7 m. in length, and in width 2 m at top & 1.80 below. The appearance of the door at this stage is noted on p 114. The door measuring .90 is not in the center of the dromos but has .70 on one side and .40 on the other. The joint measurements rather than the door narrowing at the top. The removal of the illustrated stones, pushed forward by fallen earth within, showed a more regularly constructed door, about .80 thick, 2. high, .90 wide. The ledge above which the tomb had been dug had fallen to half its <sup>height</sup> ~~width~~. The tomb was found to be roughly square at the bottom c. 3.20, narrower at the N. W. corner. It widens shortly above floor level to 4.00. Digging was done from above and delayed at a mud brick level for skilled knife digging. The bones uncovered proved animal and the true level was found by a trial pit. Further digging uncovered more than 35 pots and fragments, most of which were of late period, poor quality, and plain. The six large embossed pots were of this kind. Fragments were also found of a good rosette pattern in heavy black redish brown spot. 19 buttons of different design (p 135) were found. Half of a bronze incense. Part of a bone pin, there was a skeleton at the back, NE corner under a heap of pots. There is a large chest opposite the door and to the right a small one. Between them and the wall was a heap of shreds at the bottom of which was the good pit just mentioned. Along the edge of the chest and bounding it from the heap of shreds were three small stirrup vases & two larger pots. The vats measure 160 x 90 roughly and 60 x 40. A cylindrical incised paste bead & a death button were found.

This large grave has been a disappointment as to the quality of its contents, but should assist the evidence for normal burial in L.H. III.

\* At the bottom of a chest.

## Tomb 30. Review

On May 3 - in following southward the turn in the ledge above which the path runs, disturbed earth was found. Following this towards the ledge a small hole was found at a high level to the W. but the lack of dromos to the east left a presumption of disturbed earth in other directions led to further exploration. A large dromos was found almost parallel to the first exploration trench. The small hole was found out to be a walled fall in the left side of the new dromos or a small grave as it later developed. The large dromos ran 7.10 to depth of 2.40. It was 1.60 wide at the bottom and 1.10 at the top. A door was in place in the center .50 wide, .35 x thick to a height of about .80, being the remains of a fallen door.

By digging from above a small tomb was found, at the deepest from the door 2 m. and 2.35 at the widest. The tomb is wider to the left than to the right of the door and the shape more that of a quarter circle than round, but rough at that. After work on May 4-5, digging was delayed for a man with a knife, who on May 11 - found a large and beautiful pot with ivy leaf pattern. Fragments of nine other pots were below this standard. Paste beads and frag. of a bronze ring were also found.

The small grave in the E side of the large dromos contained beads only, but may prove larger as the stones of its floor construction extended along the dromos for 1.30. The height above the dromos level is 0.50 & the present measure of the grave or walled chest (which seems paved with small stones) is .80 x .55 in one thickness flat faced stones. The absence of bones in the walled chest and sweeping aside of bones in the grave without any new interment might indicate some change of plan or funeral policy which can be noted now but not explained.

The entrance to this was found in the  
 trial trench running below the cut crop of floors  
 and the path, shown by soft earth & the presence of  
 shreds. Its real width was not discovered at first,  
 near its entrance 2.30 at the floor 1.30 above,  
 near its entrance 1.45. Its length is 6.70 (floor)  
 The left door jamb is .70 & the right .50. The  
 door believed being 1.10 at the floor. It is built  
 with large round stones and irregularly, and  
 large stones are built or natural in the jamb also.  
 By May 7 the dromos was deepened and Cleopatra's  
 Southward across the trial trench. Digging  
 was done from above on account of the softness of  
 fall of the ledge and the softness of what re-  
 mained of it. As the grave was of unexpected size  
 the dig from above had to be enlarged.  
 In this wall bones and part of a stirrup vase  
 were found a metre from the surface.

At about a metre above the dromos door level  
 at the left was an extended skeleton, the presence  
 of whose ribs was unusual. There was a small  
 broken bronze disc with the bones and Mycaean  
 shreds with wave pattern and fish scale.  
 In line with left side of the door towards the  
 middle of the grave was a short sword, broken  
 28 1/2 in length, narrow and sharp with a  
 double edge, of good substantial metal  
 fabric, complete with haft for wooden handle.

After the drawing & removing of the skeleton a platform  
 large matt painted storage jar of polychrome  
 technique, showed in the NW corner, con-  
 bedded in very hard earth & stones. There was  
 several at least one other bit of similar technique  
 (together with a late cylix) appeared on this  
 side of the tomb, which seemed otherwise empty  
 and floored with stones.

The very hard surroundings of the above  
 put make it reasonable to suppose that  
 floor level was not reached, because the floor  
 was hard, as shown above the dromos door level.

The walls on each side contain stone  
 construction perhaps for support of the  
 ledge but at the SW, especially  
 (unwilling as we were to admit this of the East  
 excavation)

Upon further investigation of the exceedingly hard  
 walls it was found that the grave was not  
 round as at first supposed but square.  
 In the SW corner was a pile of pots including one  
 bowl shaped pot with wavy pattern and other fine  
 fabric pots of early date, some much broken and  
 all in the hardest milieu, some fine pots in all  
 when quarried.

The inner doors (measurements Miss Cox. were  
 removed. In the stones of the west door were a shell  
 sherds and fragments of a bronze disc were  
 found to the right, at about .50 from the floor.  
 This door was well built with thickness of two  
 and three stones. The presence of bones in the  
 doorway made it probable that this was a  
 cist in the wall built up with stones.  
 To the left was a bronze knife with rivets and  
 an extra rivet of larger size as in T31.

The cist was enlarged until it measured 2.80  
 upwards and 2.40 across. The thickness of the doorway  
 was . . . . . doorway 1.70 x 1.20 (centre). Thick left .60, R. .60

In the roof to the left was lodged a feeding bottle,  
 the floor were three broken pots, all of the  
 the door were many fragments together of a large  
 deep jar with bridge spout in the place where squares  
 (LH1) and LH1 behind it also.

The stones to the north when removed proved to  
 have masked the entrance to a chamber 2 mch  
 inwards and 2.50 across. The door, 1.80 x 1.30  
 (centre) was .30-.40 thick.

At the door was a cylix and shreds were found  
 high.  
 In the north chamber were 43 small fluted  
 beads, 1 plain, 2 long amygdaloid beads, 1 long  
 past bead, 2 small spherical parmelian beads,  
 & 1 shell bit.

The pottery of late & poor -  
 In a small cist were bones and a bronze  
 sword & dagger (see p. 168) whose discovery  
 on the last day of the excavation may  
 well become a dramatic legend.

The East chamber - continue p. 146

The dromos was found in the corner at making the southward turn of the trench to follow the ledge of poros. It ascends from 120 at the entrance to 165 at the door, narrowing slightly at the top towards the door. The door is to the left, .35 from the left wall of dromos, 1.80 wide and 1.30 from right wall. The dromos is 5.80 long and 2.20 deep at the door. The size of the grave is 3.10 x 2.40 wide.

The digging of the dromos proceeded as usual, widening, deepening and lengthening. A blue paste bead was found in it.

The lower part only of the door was in place for .50 in height.

The roof of the grave is fallen or removed for  $\frac{2}{3}$  of its way back from the door.

Owing to the kind of shapeliness perhaps, much was expected of this tomb and its digging delayed. A knife work several times, but a last small <sup>chamber</sup> in the center was reached with several pots and beads and an amethyst bead May 14.

By May 16 this had been dug down; the 3 wall pots were on the outer edge of a pile of sherds & bones.

One of them was a stirrup vase with iron pattern than usual. Fragments also of a fine large atticus jug with spout and handle were found. Some blue ware, a cup and "lepot" seemed Mycenaean, the former in shape also. A bronze knife was found. The pots and fragments amounted to over .35. A good Mycenaean pot (or sherd of it) with rosette surrounding the spout was the most interesting, but the date and quality of the <sup>many</sup> ~~many~~ were both disappointing. A terracotta buttons and a sword rivet were found also. The proximity of the buttons to two skulls was marveled and a suggestion made that the buttons were shoulder buttons for some kind of robe fastened at the classical Greek. In the floor level (below that of the dromos) is a large cut from door to opposite wall. To the left of this a very small one.

\* Late Helladic 1 & 2 were represented, chiefly by small cups.

The beauty of the scene from these passages is especially remarkable in this case.

This tomb is above the road and ledge where the rest of this group are situated & more on the ravine slope eastward. It was found by looking from an opposite slope for clumps of prepared brick said to grow in the loose soil of grave. This Cretan method was more successful here than at other points on the same hillside, and more successful than profitable, as the tomb seems late and poor and its excavation was difficult. Apr 30 - May 19.

The presence of gold sherds and a piece of cobalt in the dromos and the great depth of the (3.50) dromos led us to expect a large grave.

The top of the doorway was at 2.30 from surface then six diam and measured down (plate DC) 140. It should be noted that the dromos though nicely arching was not straight. Removing the standing load fallen stones within the fallen earth was found too soft for safe excavation which was therefore begun from above.

The wounding of one of the workmen by a falling stone showed the possibilities of accident and as the pieces fell above dirt contained <sup>chips</sup> of flint within the excavated cavern. When at last the floor of the excavation from above fell through it was removed through the dromos, further excavation of the sides was possible. The grave was found to be larger than expected and a second cutting from above necessary. When the sides were again enlarged the grave was found square and not round as had been supposed. As No 22 has so little else to justify us, it may be cited to illustrate the difficulty of telling disturbed from decayed rock.

When the floor was reached the small and poor pots rewarded so much effort to reach them, and a dozen other artifacts added to the toy pottery produced a nursery effect. One gold cut bronze paste ornament was found. There was also **two charits with lions & drivers & cow shells** and a single skeleton, with four bones only supposed displacement of these of them. The tomb measures 3 deep x 2.40 wide. The floor is some 5. from the surface. Facing, opposite the doorway is .40 from the left & 1 m from the right. Though on the outside symmetrical with the dromos. Thickness of door 1.10. Height 5.70.

DROMOS 22. Length 7.20. width of door 1.10. at top 1.10.



## The East Chamber of Tomb 25

The stones in the east wall were found to rest on alternate layers of dark and light calcareous filling, of which a rough diagram is given p 15.

A bronze spear head, pointing upwards, made of evident in the very hard white earth, practically solidified, was not stored.

A mirror also was found, much decayed, (rough diagram on p. 61)

In the roof to the right of high outer wall was a skull, as if to mark the position of the feeding bottle on the opposite chamber.

There was a cylinder at the door.

Near the door & at a level approaching the floor was another bronze mirror.

In the NE corner was a large Matt painted platform, 1 m. above outside floor level, approx. 4 ft 3 sq ft, with straight sides & 2 handles. Also bones of the same level, nearer the chamber wall.

These had to be removed to enable further digging.

The presence of Matt painted and possibly wooden ware underbrush in a grave with latest pottery seems to show that the collapse of the stones was of early date, in this chamber were found shreds of a fish scale pattern matching & joining some found on the platform along the N. wall of the main chamber.

This might form the level well have been brought into the chamber after the older items were hidden.

As for the relationship between the differently placed shreds of fish scale pattern, all that can be said with certainty is that the disposition however unexplained was not accidental of sweeping from the grave outward, by which so many shreds have found their way to the surface. Perhaps the fish scale had belonged to the skeleton previously laid on this platform and removed with half his possessions to the chamber.

The appearance of Mirnyan is unique. It is found on the upper of two skeletons.

May 21, 1927, 28 men. 147

- ✓ 25. quarrying good pots in SW corner 2
- ✓ 26. clearing cist, mixed glass beads cylindrical. and oval in button. sifter 2
- ✓ 27. after the removal of the door the floor 5
- ✓ 28. was dug through (apparently stones) to bones 5
- ✓ 29. Mirnyan in floor of 26, cist late pots in wall 3
- ✓ 27. all stones removed but cist wall 3
- ✓ 32. soft point in E wall proceeding both black dirt 4
- ✓ 33. fallen stones & sides cut in stones as passage 4
- ✓ 33 ditto less clearly to W. cut from above & within 8
- ✓ 33. Black earth from .50, then black, no shreds.
- ✓ 22. a whole barnyard of pottery offerings 3
- ✓ 22. paste ornament (broken). 12 counted. 1
- the later count was 10. rego

- 27. cist outside pile of bones & against outer wall of built cist. bronze nail or large rivet found on skull.
- 26. cist to right of door inside. shells & centipedes of large stones left at the back (as possibly covering a cist).
- 32. shreds of late Hellaori 1 in cist
- 22. Many of which were fragments of chariots and horses. from which one equipage has been reconstructed. probable that of these whose discovery underground with the chariot had been dreamed of by a village maiden.



The left hand door jamb (as reinforced) has a thickness of 1.35 and slopes inward towards the top, giving one side complete of the door. As the door was symmetrical with the drums the jamb faces were equal, both .55.

Geometric sherds were found at a meter above the drums level at the back of the chamber together with 1 mesomphalic plate. Dashed with late Helladic III from a chevron ~~is further evidence~~ is further evidence of the continued use of this tomb, in whose inner chamber is small painted ware of Middle Helladic date.

*Slipping probably to the left*

This was numbered at the time when 31 was thought to be a fill of stones and, as 31 has turned out to be a side tomb of 26, seems correctly numbered after all.

The drums were seen to be a large one, 2.25 wide of long floor, 3.25 deep, with central door 1.75 wide and a bronze arrow head was found in the drums. Shards of a good oolypus pot were also found. Digging inside was soon found dangerous, as the tomb ran back under the ledge and this was rotten. It was cut back from time to time & at one time fell, causing the shed to gather to date and ~~crash~~. The door was only half standing. (The men had just been covered out)

As the earth towards 31 seemed fallen or soft, digging was done here also from the surface. The wall of door uncovered here was removed as described under 31. It presented an appearance of having fallen all at once inward, in courses almost, into 26, 1.25 being left standing & well built. The grave being now equidimensional measures 4.15 x 3.50.

Inside the main door on the left is standing a well built wall of flat stones 2m high, at first thought a pier to support the ledge, but afterwards seen to be the inner portion of the door jamb, 60-70 cm high wall and 35-40 cm into doorway. In clearing the fallen division door, a bronze arrow head of the kind found in 31 and in 26 drums was found almost as if to draw attention to it, having found an entrance to 31, not provided from the outside, or destroyed by the fall of ledge (above and below either in permanent wall plate in Mycenaean times), or by the fall of stones.

The relation of 26 and 31 require careful study as it is possible that the inner entrance was made at the time of the fall of the ledge to take the place of the more usual entrance then obliterated.

There were large stones at floor level at the N. back of this tomb, in appearance a ~~platform~~ platform. ~~Shells~~ shells were found in a pile against the east wall centre. The presence of a very large stone 70 x 50 was remarked, causing more fallen from the two doors.

All of these stones were removed except those at the back which were found to be the wall of a ~~thrust~~ thrust.



The signs of an entrance had been noticed in the trial trench for some time before. Time could be promised for excavation. On May 14 the small red short drum was carried to the door, 5.6 (1.20) wide at entrance .80 at door 1.20, deep 1.80. There is a large stone apparently in steres to the right of the door.

The door occupied nearly the width of the drum (1.20). Only 1.20 of its height was in place. The stones were large and irregular, 2 from .70 - .90 the thickness of the door.

Half of the roof was fallen or removed as rotten. From the centre of the W. wall runs a passage to the back of the east wall of 33. It was evident from the beginning, being of black earth, which however contained large stones, apparently unrelated.

It widens above floor level from the original passage marked by a cutting in steres. There is however no shred or bond or evidence that this opening in the steres was other than natural. It seems probable that the front wall of the passage fell at some time for that the passage represents an cartilaginous walk, subsequently filled by black dirt and small and large stones.

The main chamber is quadrangular, 3.60 deep, 3. wide (at the back of the chamber 2.40 wide, at the door 2.90). The door was fallen inward for 1. meter.

The tomb was small, plain, and easily cleared to steres.

Along the walls of the NE corner was a pile of bones. In the floor were 5 cists of bones. Between the bones and the back centre cist were a string of 20 cyles, and some other or plain thing small pots. Slab buttons on floor. They are sherd. A large plain pot and at the door the bowl of a cyle.

Now that the possibility of a connecting passage between 32 & 33 is given up, the presence of L.H. 1. sherd in a cist at the back seem the most interesting find. Most of the tomb at T.C. but as I have seen

It has to be noted however that discovery of a frag. of bronze ring on the floor of the passage in trench 20 from the chamber makes the rejection even difficult

This tomb with 32 was only undertaken within the last quarter of the time assigned for excavation in order to complete the line of tombs in this ledge discovered by our trial trench. The general measurements of its drains and door are illustrated at the bottom of p. 137. The first miserable appearance of its projecting stones being shown on p. 136. The ledge above was fallen or rotten, so that the tomb remained roofed at the back only. Its most remarkable point seemed to be the passage to or from Tomb 32 if it was possible. There was an ~~apparent~~ <sup>at first</sup> fallen stone construction and a few flat stones remaining in place, as if of a door, to this passage. The entrance was not as evident as that from the other end, but bore more an appearance of a change in stratification. There remained a large stone in the center, which seemed natural to a fall of rock than a passage. It measured a rough triangle 70 high in base, 70 x 50. Removal of the stone and continued excavation left the passage still doubtful but revealed a side chamber (as an extension to either side of the supposed passage). It was entered through a doorway 1 m wide, 60-50 thick, in which four courses of flat stone were in place. From it stones were fallen a meter forward into the main tomb. The side chamber measured 2.50 (N & S) and E & W, to the left of the door, 2. to the right of the door 1.40 (being thus shoe shaped). The distance through the passage (if it was a passage) was 2.20 to Tomb 32. And if Tomb 32 had a side chamber, the thickness of the opening between the two side chambers was nominal, so that the two, if there were two were back to back & communicating without a passage. It seems probable however from evidence given under T 32 that the black dirt which the diggers followed upwards more easily than they went sideways to discover the walls of the side chamber was natural & not the fill of a passage. The main tomb was roughly 3 meters square with the two doors each in

the center of its wall. The front door also had fallen into the tomb in a distance of a meter. The falls from the two doors covered the SW quarter of the room. The west half was heaped with fragments of the disc type (see p. 17 in number) some small children's cups. In the NW corner were three sets of good toys, one of them a kind of yao-ti bowl with his handles at various stages.

In the side chamber was insignificant pottery, half of a pair of shoes, a good bronze tongue shaped knife (.21 long) two engraved beads of translucent white stone, a bronze chisel. One of the guns portrayed a figure standing between two lions (one of which is broken away), apparently holding them by the throat. The other shows the cow and calf scene, an equally familiar type but an unusually eager calf. Of steatite buttons, black stone & red stone beads, 4 or 5 carnelian beads, one of them cut. There was also a large steatite bead and a melon gourd, paste bead, then accompanied by an interesting ivory disc with a rosette pattern, unfortunately in fragments. The presence of lead wire in both the main chamber, and side chamber was not lead to its explanation. It was not until the last moment when the knife was taken up that it was found to be a saw.

An east of the back of 33 were

33. (6) doors fallen inward, stoneli  
 ✓ 1 metre in each case inward from  
 visible & calyx eat inside of each  
 ✓ In NW corner stumps, long plain & sprouts (and with  
 handles)

✓ 32. (2) skeletal button.

✓ 31. (2) cleaning skeleton, on platform and then  
 arrowhead & boars tooth  
 arrowhead at .58 perp. to line at 60 from the E  

"	.46	"	"	.37	"	"	E	} to } Mess
"	.25	"	"	.25	"	"	"	
"	.21	"	"	.10	"	"	"	} Cox.
25 pins	.30	"	"	.70	"	"	"	
	.25	"	"	.80	"	"	"	} box 2
boars tooth	C 20	"	"	.75	"	"	"	

(25) (2) open door front, sherds and a  
 bronze ~~disc~~ ~~plate~~ broken.  
 N ✓ found between the stones on right  
 side of door C. 50 above floor.  
 also shell, and bones  
 v. bring keep found & broken on floor to left  
 13-92 passage, 1 metre in led wire and  
 sherds

31. ~~25~~ piece of late Helladic 3. bowl (chevron)  
 & " " " " cylix stem inside  
 ✓ door - both in study

24. probably, a head from this tomb was found  
 along the syle, and not otherwise noted but  
 this undressed

- T29, Cist 4 large broken beads
- " 9 with bone pit at back { 2 small white  
2 small beads }
- T. 24 bead, from cist 4, found misplaced
- T29. paste bead from recess. boxed
- T29. cist in front of door, 1 whole, 2 frag. bronze

later gem p. 160  
" "

- 25. open thro other doors or Stone covered cists 25 2
- ✓ The E. door being straight 32 2
- ✓ The N. & c. door low & sheds high <sup>a meter in</sup> semi 2
- 31. ~~removed~~ skeleton on layer of stones reveal large bone undecayed stems. 12
- 32. boys continue work until in floor
- 33. enlarge passage outside. iron figurines & the rest, disc shape <sup>metal</sup> 8
- ✓ led into bronze tweezers in cell chamber engraved seal stone. Knife 4 " 21 long <sup>bronze</sup> <sup>shaped</sup> <sup>chisel</sup> 06
- ← have nothing lions at arms length
- 31. walls cist to the right has slab covering uncover door of stones to the right above walls of cist to right of door in wall measure & draw and take pots
- ✓ 2 bronze discs from scales, note holes for note c. stems for covers to N. H. pots in W. corners, seats under pot in NE corner below platform
- 31. The bones under the skeleton removed rested on a layer of pebbles on the slabs of the built portion. When the top slabs were removed other stones of rougher construction filled the space. The platform was 40 above floor. ✓ of inner chamber 2 from 80 95 wide and 2.65 long
- ✓ The bottom layer of stones was of fairly good material in. upon which small ones had been placed to level the setting of the 4. course

160 May 26 22-23-14

33 in side chamber



left standing in courses flat stone  
deduced through passage to 32 = 2.20  
to side room of 32 = .10

Seal bead with cow and calf found near dump, same  
sup. positions as former seal

32 remove stones of doorway, 12 rough ones  
fallen in 1 meter  
bones in corner to left

✓ cist opposite, bones piled along back  
with 2 cycles & slumping gap between  
them and cist.

31 remove stone of side door, floor level  
of inner chamber C 20 higher than 26.

✓ ITC 81 w large shale bead underneath  
~~seal~~ platform even with chamber  
also frags of L.H. pot near innermost door  
against wall .65 from corner

26 removing outer door, base  
from outside (as if from

door seal) & shards of pottery  
W. cist frags garnished base 2.11

31 above platform door of  
small round stones .20 x 1.30  
above platform, .60 above floor

Remove stones and find more stones  
with black earth, more stones and  
finally stones all around.  
Possibly a support of the wall.  
but not probably, as we will have no  
been in need of support

25 remove spear head from E niche

- ✓ bones at level of spear head = .65 in
- ✓ W. chamber 2 metres in x 2.80 wide  
dog 1.80 x 1.30 (60 centes) x 2 (thick .30-4)
- ✓ E chamber = skull at door & cist

The openings on all sides of 25 give  
it an archi-lectural air.

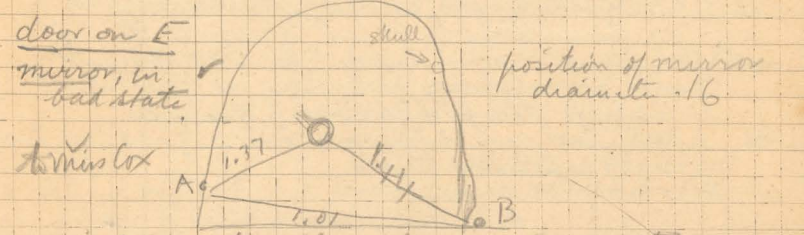

on the north side of the mirror there  
seem to be remains of a wooden handle  
note skull in roof to right.

Doors on W. feeding bottle, against  
wall at that back, high  
roughly 2' deep, 2.40 wide  
✓ door 1.70 x 1.20 centes, slight base, thick  
thickness left .40, right .40

31 frags of walled base above W  
end of platform.



- 33 (2) leadware in chamber and tomb pieces boxed. button from floor at back (with wire box)  
broken ivory disc with rosette pattern
- 32 (4) floor largely occupied with scists and bones. The passage probably made by an man in following - fill of dirt with chance stones
- 27. Mix for drawing, clean scists & new figurine, button & bead of black or purplish steatite
- 26 (1) remove stones <sup>fallen from door</sup> but carrier to right of door & find shield of copper in left corner also find bones. In both corners small niches have been dug at floor level perhaps for reception of vase. ~~charcoal~~
- 27. Lifting and cut digging. obsidian point left cut 2 buttons N. cut. Boys take pots & shirds

- (25) (3) pot to lift in roof of niche
- 33. roughly 3 metres square. red stone bead both doors roughly central. frags of lead core. <sup>bitthal</sup> scraps of bronze (boxed)
- 32. roughly 3 metre wide & less at inner end  
" deep 3.60  
at back chamber 2.40 wide at door 2.90  
quadrangular, 1 steatite button. floor left door
- 2.50 deep 3. wide, quadrangular

(33) figurines increase to C. 18  
2 carnelian beads

- 25 (10)
- 32 (2) 32. sifted steatite button <sup>5</sup> button from circ & v. small figurine. I.T.C. " "
- 33 (2) 33. ~~28~~ carnelian beads. <sup>fluted</sup> <sup>with iron</sup> iron disc with rosette & 6 small <sup>in</sup> <sup>pot</sup> <sup>pot</sup>  
3 large steatite buttons  
4 stone buttons. 1 large steatite bead
- 25. W. chamber, fragments of large deep jar with ~~small~~ <sup>off</sup> bridged spout  
L.H.I. in place where squashed.  
fragments of other L.H.I. pot
- N. ch. 43 small fluted beads, 1 plain  
2 long amygdaloid bead  
1 larger pale bead  
2 carnelian, 1 steatite  
1 small <sup>eye</sup> <sup>lens</sup> <sup>lens</sup> spherical
- 27. <sup>W. cut</sup> in cut. 5 poulders and 4 whetstone cut divided into two

25 W. bronze knife also (31) has extra rivet larger size

May 29, Mon 12 165

25. (3) bronze mirror made don 2725E  
E large ~~white~~ painted pot, NE corner  
c. 1 meter above outside floor level  
small 2 1/3 squat jar with straight  
sides & 3 handles. Also bones near  
main wall. Probably Urinyan.

Sifted (3)

analysis (2)

32. (2) Vasilis cleaning cists  
carnelian beads  
steatite button  
one baby "  
2 paste like ornaments, 1/2 ivory in the  
superficial beads  
a small quartzite fragment another figure

33. sifted gem.

92. 2 with sieve

32. 20 from edge of tomb in passage  
so-called Gray of bronze wire or  
ring in the ~~stair~~ floor  
note that the digger of this passage  
or other passage had reported a bone  
which was not known seen

T.S. buttons 2 1/2  
1 bone pin

May 30. 9.

166

35E LHI pits, similar to those in 38  
TC beads - in box in cont.  
knife taken up. 2 fragments. 2 small  
of larger size.  
skeletons lying  $\rightarrow$  E. Mycenaean pit on top one

33. cleaning cists  
160 carnelian beads  
1 large striped part. 2 small  
more in final cist  
beads

32 " " bone needle from NE cist

33. side chamber

measured etc  
the knife when taken up proved  
to be a saw  
taken up with chisel and pincers  
broken but complete

(17) earth brought in from pit 3. or ashes  
for analysis.

Old terrace temple sherds. 167

W. Pit.

- level I. nondescript surface mixture. Mycenaean
- II-III " " " " " "
- IV mixed from Geometric & E.H. " "
- V " Corinthian, L.H., Geometric. " "
- VI Geometric Mycenaean - E.H. " "
- few sherds.
- VII Geometric Mycenaean. M.H. E.H. " "
- VIII " L.H. M.H. " "
- IX " Mycenaean, possibly P. Corinthian " "
- I E.H.
- ~~X~~ Only Middle Helladic " "
- I E.H.

E. Pit.

- 1. Surface nondescript " "
- 3. Corinthian, Proto Cor., Geometric " "
- IV Geometric " " " "
- V " Mycenaean, M.H. " "
- VI " " " " " "
- VII choice Geometric sherds  
Mycenaean
- VIII Geometric, Mycenaean
- IX Geometric, Mycenaean, Proto Cor.
- X Mainly geometric

Hole in E face of terrace

Only a few sherds. They are mainly  
geometric but include one or two fragments  
of Mycenaean

S. face of terrace

Sherds mainly Mycenaean, one fragment  
probably seventh century Corinthian.

May 31. - 6

T 33. sideroom, 4 sided bronze pointed  
at one end broken at other

T 25. W. measure and draw  
sack three pots  
note that the lip had cut down  
into the stores when the fall  
occurred which broke the  
cist

N. measure & draw 2 beads  
& gather contents  
In cist sword and dagger  
with 9 loose rivets from hafts

E. the so called bronze mirror in  
the entrance is decayed beyond re-  
cognition but retains traces & even  
threads of cotton  
Remove & box fragments and frag.  
with dirt as far as possible

N. cist in excellent condition = 1 good heavy make  
sword blade & handle 46

spread of handle guard .66  
width of blade 3.50



dagger. long 30 1/2  
handle 9, to rivets 10 1/2  
width of blade .06. min. 4.50



measure distances for D.H.C.

94 The rivets were found along the handle  
with raised edges & the 9 other were under.  
The end of the sword handle was not  
recovered.  
The hand bones were attached to the handle

"A small boy, Dimitris Dimaites, was  
present at this memorable discovery and  
should long remember the exclamations  
of triumph and admiration which  
were uttered when he

greeted the archaeologist."

May 30 C.W.B. to Athens  
" 31 R.S.D. to Spilios

Miss Cox remains to draw the curtain  
and meanwhile the Mycenaean cup  
whose discovery in a Mycenaean tomb  
is the most interesting of this excavation

Temple Terrace. 8 br. pins & spits <sup>N.D.</sup> p 82-87  
 sheet with human figures 95  
 4 rings 71.82.83  
 sheet from within walls 95  
 frag. of bronze spits 95  
 large steatite shell 92  
 bronze headless horse April 26  
 large paste bead p 87  
 bronze disc  
 broken ring } p 87  
 blade <sup>of obsidian</sup>  
 three bronze discs and frag 92

Neolithic, 80 frag. obsidian.

T. 19. ✓  
 ✓ 1 bronze bowl p. 130 ? D.H.C.  
 ✓ 1 " funnel " " "  
 ✓ 1 " bowl p. 132 " "  
     unwrapped } fluted.  
 frag. of a disc May 4. D.H.C.  
 18 paste beads " 10 " "  
 ✓ 1 large " " " "  
 ✓ 1 button " " " "  
 ✓ T.C. figure. " 4 " "  
 ✓ 1 and 2 past beads p. 136 " "  
 ✓ 1 steel button and D May 5 " "  
 ✓ bronze frags. 2 shells, " " " "  
 ✓ large steatite button May 9 " "  
 ✓ 6 whorls " " p. 146  
 ✓ 109 beads.

T. 18. ✓  
 10 weights & buttons. Apr 29. D.H.C.  
 144 paste beads May 2. D.H.C.  
 13 T.C. buttons & frags. Apr 30. "

T. 17. ✓  
 paste beads. } 2 bone pens } May 2 }  
 1 Knife } D.H.C.  
 3 whorls. }  
 4 " } p. 148  
 1 tweezers } D.H.C. May 2  
 1 bead }  
 4 round beads 2 long. } D.H.C.  
 1 steel can blades }

T. 16. nothing.

T. 25  
 ✓ spear head. E. cut. p. 161 R.D.  
 2) high level frag of bronze disk p. 131  
     possibly T. 31 which box was labelled  
     (it is mentioned in clay book under T. 25 and  
     not under T. 31. possible confusion of  
     figures T. 31 and p. 131. found in R.D. chamber  
 E ✓ bronze mirror fragments. p. 161. R.D.  
     N. chamber.  
     ✓ 4 small fluted beads. p. 162 " "  
     ✓ 2 amygdaloid " " "  
     ✓ 1 large paste. ✓ 1 steatite. " "  
     ✓ 3 small spherical carnelian " "  
 (2) ✓ bronze knife. p. 137 " "  
 2) W. ✓ " " rivet & frags p. 166  
     ✓ " dagger & 18 rivets p. 168  
 2) N. ✓ " sword " "  
     ✓ 1 bead " "

T. 24. ✓  
 12 buttons. p. 135 R.D.  
 1 bone needle " "  
 1 piece of tinnyess. " "  
 1 heavy sword rivet. " "  
 1 bead p. 147 " "  
 1 whorl " "  
 1 " from sifter (?) 157 " "

T. 23. ---  
 T. 22. ✓ 1 paste ornament p. 147 R.D.  
     3 steatite buttons sifter  
 T. 21. ✓ 1 paste bead. D.H.C.  
 T. 20. ✓ 1 paste bead p. ? 135. D.H.C.  
     ✓ 1 loon weight p. 131 " "

T25. 1 blue bead p. 109. RSD  
 1 broken T.C. button  
 bronze knife p. 135 "  
 6 beads 1 crystal.  
 1 large, 1 small figurine with frags. ?  
 1 amethyst bead - ~~about 1000~~.  
 3 paste beads

page 132

T27. figurine p. 162 "  
 button  
 1 black  
 1 red  
 2 carnelian beads  
 broken blade from dromos p. 109  
 bronze rivet p. 47 "

T26. Arrowhead frags. w. cut p. 160  
 2 buttons w. cut. p. 162 "  
 obsidian point w. cut. p. 149 "  
 38 sea shells  
 part of bronze tweezers  
 and sifted fragments.  
 4 buttons w. cut p. 151  
 1 bronze rivet "  
 fragments of boar teeth "  
 part of pincers broken p. 118 "  
 dromos bronze arrowhead p. 118  
 2 " p. 138  
 fragments of bronze bowl. CWB p. 62

(31)

(31)

T31. (Continue on page 176) 175  
 Lt. C button mapped on floor p. 151  
 3 arrowheads, bronze. p. 138 - CWB 62  
 bronze knife p. 138  
 1 tweezers p. 138  
 1 gird headed rivet CWB 62  
 5 arrowheads, bronze p. 157 - probably  
 part of knife "  
 bronze arrowhead. May 4 = "  
 " " CWB 56  
 2 carnelian beads  
 12 paste beads (sifted)

T. 30.

2 carnelian beads  
 12 paste beads (sifted) } DHC Apr. 152  
 5 or 2 broken p. beads } "  
 broken bronze tweezers } p. 138  
 broken ring  
 4 wheels  
 7 beads & } May 30. possibility of  
 frag bronze ring } repetition.

T29 7 round paste beads & 2 flat sifted  
 1 wheel (10 small frags of bronze) p. 158  
 3 "  
 1 large broken, 2 or 2 broken small paste beads "  
 1 paste bead  
 14 round & 1 long paste beads p. 129  
 paste ring bead p. 118 May 6.  
 6 or 1 broken sifted beads. 4 spheroid p. 138  
 2 round & 6 v. small bead frags. & 2 flat "  
 12 very small beads  
 2 boxes of wood, 1 of lime - p. 122  
 1 carnelian & 1 paste bead p. 136  
 5 beads & shackle button. DHC Apr. 29  
 38 s. wheels & buttons, 2 or 2 broken paste bead, 2 or 2  
 1 engaged pin, 1 long bronze small beads.  
 broken ivory, & broken carnelian bead "

- 176 T33 engraved seal. p. 159 RSD
- " " " " p. " " " "
- frags of ivory rosette p. 162
- " " lead wire p. 162
- 1 button p. 162
- 10 " or whorls p. 163
- 41 carnelian beads " + 16
- 6 small paste " + 2
- 1 fluted " " "
- 1 ivory rosette disc " " "
- 2 carnelian beads p. 165
- 2 slate like buttons " + 5 " p. 166
- 2 lotos paste ornaments & large striped bead broken
- broken engraved seal p. 165
- infinite small beads p. 165
- bronze needle, saw, chisel, broken pincers p. 166

- T32
- slate like button p. 157
- 1 TC " " p. 163
- 3 slate like " " " " " "
- 1 v small figurine " " " "
- 1 ste. button p. 162
- frag bronze ring in passage p. 165
- 2 TC buttons " " " "
- bone needle " " 166

- T31
- 12 bronze scales pans p. 159
- 1 knife " " "
- 1 arrowhead bronze p. 157
- 1 TC button p. 160
- 1 slate " " " "
- 13 bronze arrowhead & frags p. 157
- fragments of worked bone p. 161
- 12 bronze arrowhead & spear p. 157
- bone tooth " " "
- arrowhead bronze " " "
- box of sifted bronze fragments May 23
- fragments of bronze and ivory " " "
- " of bronze buttons p. 117
- 1 one obsidian arrow " " "
- frags of bronze knife " " "
- ivory coil " " "
- gold pin head " " "
- frags of bronze knife " " "
- 1 bronze knife and handle " " "
- contains on page 175

- 177
- T33 broken glass. obsidian p. 165
- T33 engraved seal RSD p. 159
- T27 bronze rivet RSD p. 147
- Neolithic area, shell & 2 blades
- T31 2 scales pans RSD p. 159
- TT || large / small ring disc, 2 frags, terrace RSD p. 159
- T31 knife " " "
- T29 7 round paste beads, 2 small flat, sifted
- T31 arrowhead RSD p. 157
- T29 1 whorl & 2 small pop & bronze p. 158
- T26 W. dist. arrowhead frags p. 160 RSD
- T33 gem. (box of perhaps p. 159) p. 160
- T33 1 TC, 1 slate like button p. 160
- T25 spear E. dist. p. 161
- T31 3 arrowheads & frags. p. 120
- T31 TC button, marked on floor. p. 151
- T21 1 paste bead. DHC. p. 162
- T33 frags of ivory " " "
- T27 #10 figurine button p. 162
- 1 black & red, 2 carnelian bead p. 162
- Tomb 32 1 button. p. 162
- " 26 2 buttons, obsidian point. p. 162
- T31 or 25 high level frags of bronze disc. see T35 p. 131
- T33 lead wire and button p. 162
- T17 paste beads, 2 bone pins. DHC. May 27
- 1 knife, 3 whorls
- T25 E. Champs. Bronze mirror frag. p. 161 RSD
- T33 10 whorls from cist at back p. 163
- T33 41 carnelian, 6 small paste beads p. 163
- 1 ivory rosette disc
- T32 1 TC, 3 slate buttons p. 163
- 1 v small figurine
- T25 N ch. 43 small fluted beads p. 162
- 2 amygdaloid bead
- 1 large paste, 1 slate like
- 2 carnelian beads, small spherical
- T31 frag. of ivory or worked bone p. 161
- TT 2 small fibula, 1 spec & bead
- found in frame. p. 161
- 3 discs fragments
- minimum mesomphalic phial
- May 27. 8
- 3 rings, mix frag
- T33 2 Carn. beads, 2 slate like buttons. p. 165
- T33 2 lotos paste bead. 1/2 v. v. rosette " "
- T32 frag bronze ring RSD p. 165



Dryce Creek T22. 3 slate buttons & pins.  
 1 heavy, 1 crushed, 1 frags bronze bowl, DHC. 150, 151.  
 1 metal casing, thin, top 9 small rings.  
 3 for rings, 1 large, 3 broken pins, 2 frags. } p. 124 DHC  
 obsidian.  
 1 bowl, 1 base, 7 discs or fragments bronze  
 straight sided bronze bowl complete, 1 bent pin. } p. 160 CWB  
 1 ring and fragments  
 1 mesomphale plate complete  
 1 broken br. bowl, 2 bent & broken br straight sided } p. 141  
 5 discs a frag, 1 bent pin, 2 wires, 1 stable bead } DHC  
 1 iron disc, 16 bronze pins, frags wire etc } May 67  
 1 bronze alloy coin, 6 rings } p. 137 etc DHC.  
 4 bronze bowls, TC ring, 4 discs  
 3 rings, ornaments bronze bar } p. 150, 151. DHC  
 5 bronze bowls & 1 disc or fragments } CWB  
 2 " " 4 rings, 2 pins, 1 disc, frags } CWB p. 63  
 double headed snake handle  
 bronze bird, frags 2 bronze bowls, 4 discs, 5 pins } May 13 " p. 48  
 7 bronze bowl } T19 p. 120 ? DHC  
 1 " funnel } T19 p. 130  
 38 slate buttons & buttons, 22 paste beads }  
 1 " engraved pendant, 1 wire } T29 p. 122 RSD  
 broken carnelian bead, 8 sub small " }  
 broken wire piece }  
 TT 1 large bronze bowl broken DHC. Apr 30  
 box of fragments of bronze bowl " "  
 parcel of long bronze spits loaded Apr 28. RSD.  
 TT bronze pin, wire, 2 frags } p. 128 DHC  
 " bowl bronze unwrapped } T. 19, p. 132  
 TT 3 discs, 1 bowl & fragments  
 1 figure plaque or Mulda a Fine Art p. 106 DHC  
 1 bowl with spout & frag with fluting. DHC p. 153  
 small bronze bowl, 2 carnelian beads " Apr 19  
 T29. 8 wheels 1 large hole, 2 small beads RSD p. 158  
 T20? 1 " from sifter RSD p. 157  
 T32. 1 " from sifter RSD p. 157  
 T26. Shells 38 RSD p. 149  
 T31. p. 157 RSD. 2 bronze arrowheads & pieces  
 T26. sifter, parts of bronze tweezers & fragments  
 T31. boars tooth and arrowhead p. 157 RSD  
 T26. p. 151 RSD 4 buttons and bronze neck wire.  
 T31. box of sifted bronze frag. May 23  
 T26. frags of boars tooth p. 151 RSD  
 T31. " of bronze & wire  
 T29. paste bead. RSD p. 158  
 T33. 20 fine lined beads. 160.

T32. 2 1/2 TC buttons p. 165 RSD  
 Tweezers & blade, p. 17. DHC May 109  
 frag, disc T19 " " 41  
 80 frag. Neolithic Obsidian RSD 119  
 3 bronze discs & frag. old terra RSD p. 92  
 T19 frag. iron disc. Tabach 16. DHC p. 114  
 " tweezers T. 31 RSD. p. 117  
 obsidian arrow & piece knife T 31 " p. 117  
 gold pin head & fr. knife & wire spiral T31 " "  
 bronze thumb & handle T31 " "  
 14 round 2 long beads T29. RSD p. 129  
 10 weights & buttons T18. Apr 29. DHC  
 44 paste beads T18. May 2 " "  
 B 18 small 1 large 1 button T19 " 10 " sifter  
 TT TC ring French 16 DHC. p. 114  
 paste ring bead T29. May 6. RSD  
 disc, broken ring & blade E. French Old Iron Apr 29  
 large paste bead w French Old Iron p. 87 RSD  
 " blue bead T. 28. p. 109 RSD  
 TC figure May 4 T19 DHC  
 12 paste beads, st. button & D " " p. 136  
 2 bronze frag. }  
 2 shell large st. button } T. 19 " May 3  
 100 weight T20. DHC. p. 131  
 p. 48. part pinces broken T26 May 10 RSD  
 Trench 16, Skyphos - Kotyle Apr 28 DHC " "  
 6 wheels. T19. May 9. DHC  
 bronze arrowhead T26. RSD p. 118  
 TT 15 small br. discs, 4 rings, " casing" T. 16. DHC p. 111, 114  
 large slate seal Old Iron. RSD p. 92  
 paste beads T20. DHC. p. 135  
 bronze headless horse. Old Iron. RSD Apr 26  
 small bronze bowl Apr 30. p. 120. DHC  
 heavy band, & frag bowl. DHC Surface trench May 4  
 bronze fish. DHC. p. 109. Apr 27  
 frog bronze bowl  
 " " and safety pins Apr 30 DHC. p. 120  
 ring of 115. 2 kg. pins. pin T18. p. 112 Apr 28, 77. 115. Apr 28  
 3 obsidian blades, 1 small bowl, 7 frags } DHC  
 small bronze mirror, pinhead & frags. French 16. " p. 189, 27  
 2 carnelian 12 paste beads (on 10) T. 30. DHC p. 157  
 Tomb 17. 4 wheels. DHC 148 T17  
 52 beads. broken bottles, broken ring T30 } May 16  
 4 wheels. T30 } DHC 157  
 109. Beads. DHC. May 9 T19. p. 146  
 TT long pins, safety brooch, DHC  
 small bent bowl & frags of another } (2 wooden p. 145 DHC  
 other bronze frags pins, bowls &



Ch. 13

a few marked 1 has been put in  
to show place where the  
bones were found (cf p. 38)  
objects # 9-14

13075.56

1925

1908

1570  
8 pieces in chamber

~~Tetrapoda~~ ~~Aspidochelone~~

Dipsosaurus

Pygmy  
Mongoose

Blue  
red  
blue  
blue

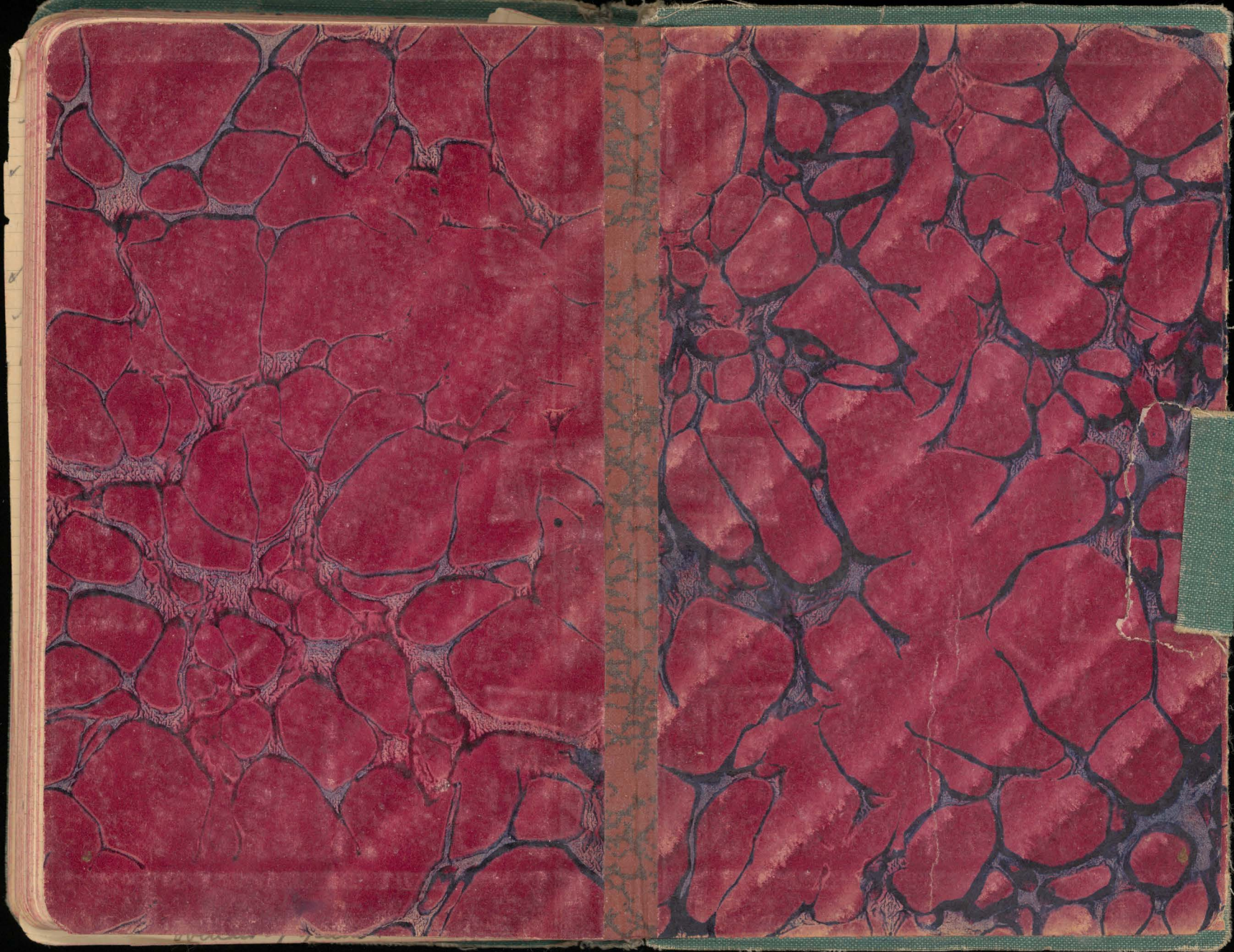

May 8 Friday

Trench 2

Cleaning floor

Just inside door to right, in tan  
clay - found -

1 bronze ring

1 " rivet head (?)

Fragments of bronze arrow heads

Part of bronze knife

3 pieces of obsidian

1 wavy rosette button or disk

May 7 Thursday.

Tomb 2

Cleaning floor

Just inside door to right in the  
tan clay found

1 gold leaf

2 bronze rivet heads (?)

2 fragments of bronze

1 bronze arrowhead + 1 small tip

