

Argive Heraeum

ATH

1928

111

H

A



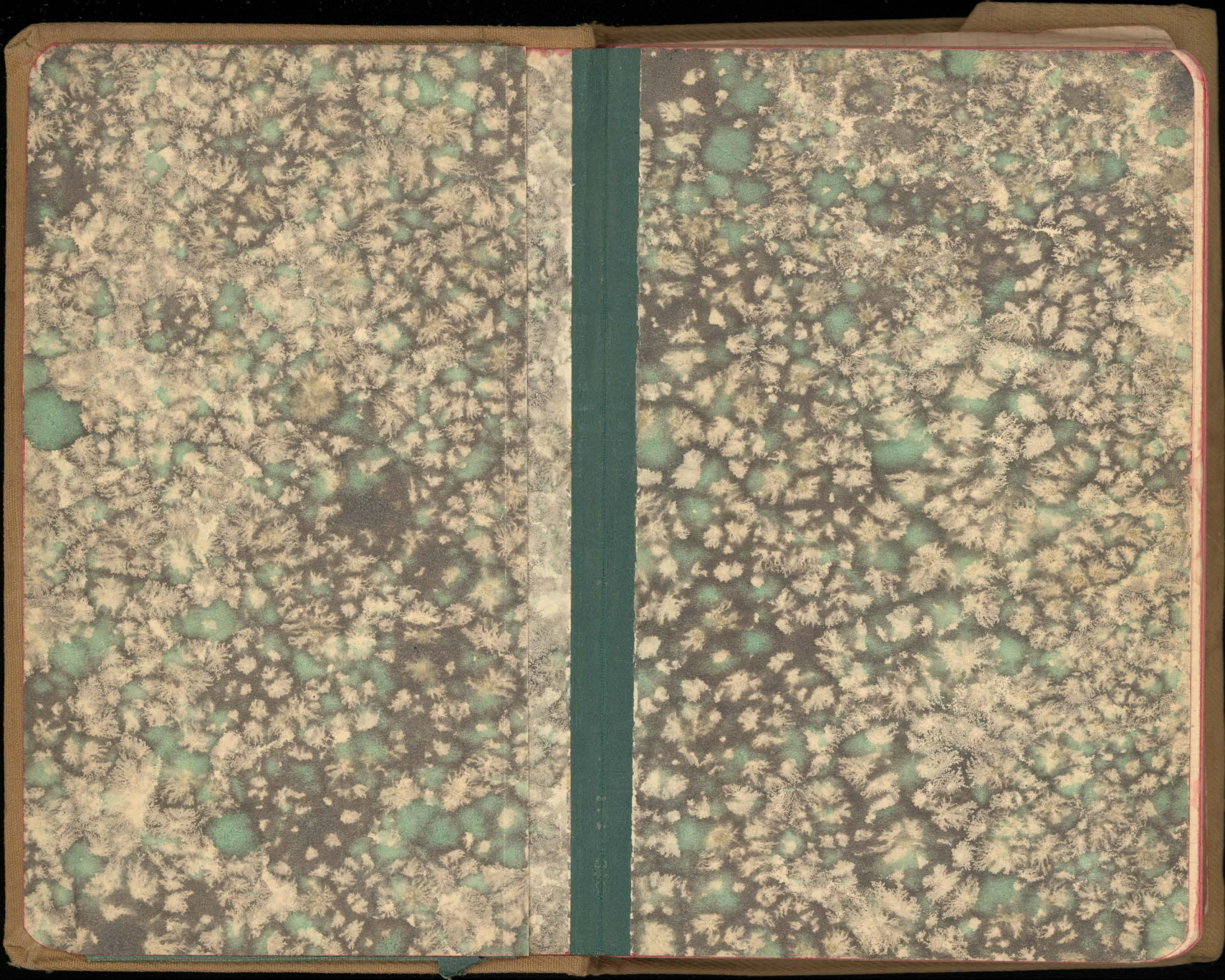



Apphia J. Hack  
argue Heraclum  
1928

①



Jamb VIII. pages 96, 99, 102, 104, 106, 108, 109,  
110, 112, 114, 115, 116, 117, 119, 120, 126,  
140, 165, 168, + Book II page 19

Summary Book III. page 27, 28, 29, 30, 31, 32

Jamb IX pages 90, 92, 94, 95, 98, 100, 101, 103, 105, 107, 111,  
113, 118, 121, 123, 128, 133, 134, 137, 142

Summary page 21, Book II

22  
23  
24  
25  
26

Jamb XXXIV pages 27, 31, 34, 35, 36, 45, 46, 51, 53, 54, 55,  
72, 73, 74, 75, 76, 77, 78, 79, 80, 81, 81, 24, 82,  
84, 85, 86, 87, 88, 91, 97, 127,

Summary - page 59, 60, 61, 62, 63, 64.  
Book I

Jamb XXXV. pages 13, 18, 41, 43, 130, 132.

Summary pages 65, 66. Book I

Jamb XXXVI pages 9, 16, 17, 19, 20, 21, 22, 23, 24,  
25, 26, 28, 30, 32, 33, 37, 42, 44, 47, 48, 50, 52.

Summary, pages 56, 57, 58.  
Book I

Jamb LII pages 122, 124, 125, 129, 135, 139,  
157.

Summary pages 178, 179, 180 Book I

Shaft grave handles E XIX pages 146, 147, 148, 149, 150,

151, 152, 153, 154, 155, 156, 159, 160, 161, 166, 170, 173,

174, Cutting above S. Stoa pages 152, 153, 159.

Summary Book II. pages 33, 34, 35, 36.

Shelf graves. Temple Terrace pages 158, 162, 163, 164,

167, 169, 171, 172, 173, 174, 175, 176, 177,

181, 182, 183, Book II page 20.

Summary pages 37, 38, 39 Book II.

Myc. grave (?) pages 90 (top), 93, 96, 143

Summary page 40 Book II.

Middle Helladic grave XIII pages 38, 49 Book I.

grave XIV. page 39, 49 Book I



2

3





Tuesday April 24, 1928

Tomb XXXVI

4 men continue to clear loose earth on right have reached .60 soil reddish - finding several pieces of medieval pottery - also several fairly large sherds of geometric

Before noon took down part of dirt wall between door and trench -

fairly large stones appear near dirt wall slightly to right depth 0.32

These taken out by men after lunch before our return

clearing then begun to right of probable cist leaving wall 0.30 between new clearing and earlier.

Earth around trench becomes black at depth of .80 numerous sherds geometric

1 piece of <sup>iron</sup> large wire with knots square section length 32  
1 piece <sup>small</sup> large wire length 14.3 cm. diameter .08

at depth of 1.25 meters found a probable cist several small fragments of mycenaean sherd

1 flat circular <sup>terra cotta</sup> ~~clay~~ with hole diameter 0.007 diameter of button 0.035 - sides slightly convex brown stone

small group of bones uncovered back and left of

continue page 16



⑩

## "Hole in the ground"

April 24  
Tuesday  
I man continues to find outline of small  
shelves each west of narrow upright slabs.

on right piece of small pit .45 below top  
of slabs - soil on right greenish, resembling  
shelves but soft. toward center, whitish particles

outlines on left of ~~the~~ curves and center arch  
cleared to depth of 1.10 by noon

in front of slabs N.E. uneven rectangular space  
cleared to depth of .90 below top of slabs

digging in to depth of fairly regular curved  
outline uncovered maximum height by night

from floor = 1.17

width from upright slabs = 1.72

## "Hole in the ground"

⑪

April 24  
Tuesday

125 cm width at hole door

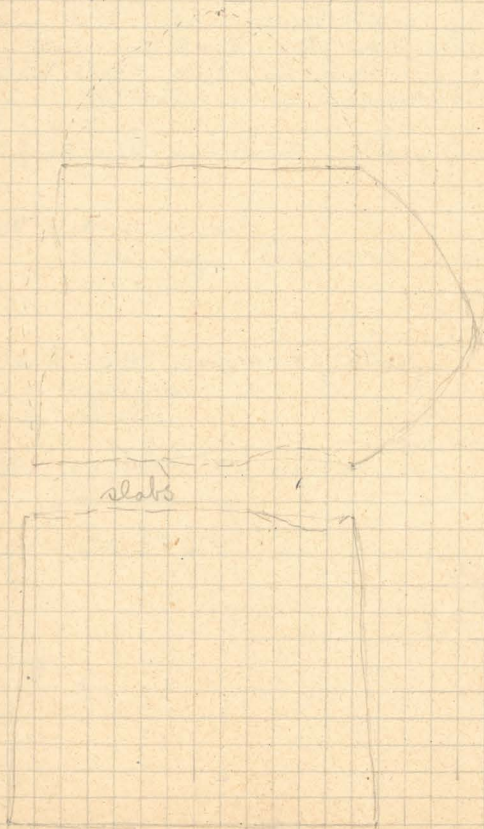
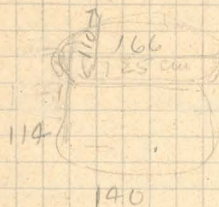



4 figs  
5 pits

April 24  
Tuesday

Tuesday April 24

Tomb ~~XXXV~~

afternoon central cist uncovered to  
depth of 0.20 m center. toward front 1 figurine,  
2 small figs, 1 cup.

toward back 1 beaker with figurine lying  
across, 2 figurines, 1 fig.

April 25, Wednesday Tomb XXXV

x central cist and 3 uncovered others filled with  
water. this bailed out, and work continued  
on central cist. shell with hole at inner end under  
a figurine - crystal bead 0.005 sq. 2 pierced shells 0.5 x 0.3 long.

left front cist uncovered. nothing found

right cist uncovered  
small fig, long bones

left back cist uncovered further  
1 figurine  
2 skulls

Earth removed for sifting

see page 18



(14)

wednesday april 25, 1928

2 men digging trench little E. of north  
from

for short time.

(15)

april 25  
wednesday



(16)

From page 1  
 Wednesday, April 25.  
 Tomb XXXVI

men digging to right and take down remainder of wall of trench, trying to find outline of possible chambers

1 piece twisted and broken bronze wire length 0.40

1 oval piece bronze wire - broken entirely from other piece  
 2 bits straight bronze wire (0.027) x 0.014

numerous fragments of iron in black earth at right anchoring from 0.35 layer x 0.077  
 11 x 0.02

By noon line of fairly large irregular stones appear at depth of 0.60 (large one on right edge) with slightly curving line

layer of blackish earth which began at depth of 0.80 is 0.34 deep

Shards (geometric) in earth at right

Digging in wider area to right and beyond trench begun

1 bronze pin length 0.65 width diameter 0.005

see page 17

Thursday April 26.

Tomb XXXVI

4 men working on continuation of clearing earth in front of line of large stones which now shows, at either end, <sup>the</sup> beginning of another line at angle of about 95°

in front of main line of stone small round jug found at depth of 0.50 below top of largest stone. Broken

1 broken infant feeding bottle  
 1 round pot with handles

this may be side chamber of tomb. Not removed for sifting

clearing of area to left of possible side chamber begun.

cave like mass of stones may be door width 1.35 between two large stones. cave mass continued page 19

(17)  
 April 26  
 Thursday



Thursday, April 26 - continued from page 13

(18)

Tomb XXXV

Tomb measured and drawn by Miss Cox

Articles removed from central cist.  
one piece of gray unpainted fig sand  
at outer end of cist. the other pieces at  
inner end.

Put no. 5 removed from right cist.

Bones removed from right hand and

left inner cist. Squirre removed from  
left inner cist.

Measurement of cists when cleared

Left outer 0.50 long, 0.45 wide, 0.30 deep

central inner and

Left inner 0.15 deep, 0.42 wide, 0.55 long

Right 0.60 long, 0.42 wide, 0.25 deep

central 0.84 long, 0.30 wide, 0.20 deep.

Tomb cleared - April 26

see page (41)

Tomb XXXVI

from page 17

(17)  
April 26

in front and between them  
Do the jambs and door?

Thursday

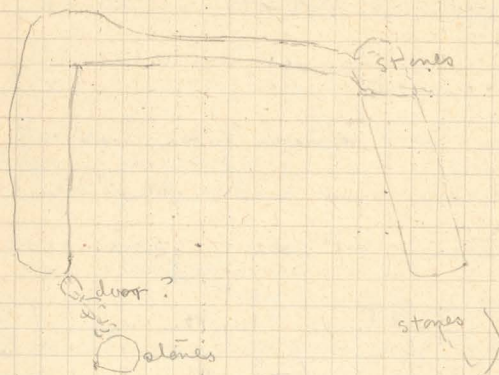

see page 24 for drawing

stones appears at 0.23 at left of  
possible fallen door.

see page (20)



(20)  
Friday  
April 27

from page (19)  
Lomb XXXVI.

4 men cutting down area between  
XXXV and XXXVI.

By room line of stones to left and back  
of possible door appears, also line  
of ruins back of  
(also oval mass of stones) (joint?)  
another line of stones to right of  
possible door and back of joint(?)

Distance between 2 edges 2.05

1 button of reddish green <sup>stellite</sup> found 0.40 distant  
from back wall directly in front of pat.  
and 0.40 to left of bones. double concoid  
+ reddish stellite button - double concoid  
large diameter 0.01.7, small 0.00.7 - length 0.01.4  
bits of paste beads

two cists begin to be outlined -  
inner one shows bones and skull(?)  
1 red brown button - right end - stellite  
concord  
long diameter 0.02  
small diameter 0.00.8  
diameter of hole 0.00.4  
length 0.01.2



1 reddish button - stellite  
long diameter 0.02.7



work now being done with knives by

3 men

see page (21)

Lomb XXXVI. from page (20)

west  
in outer cist bits of paste beads

2 carved <sup>paste</sup> stone bead 0.01.7 long  
Diameter 0.00.8 in center, 0.00.5 at ends



1 pendant paste beads 0.02.5  
pear shaped 0.00.7  
thickness 0.00.5



1 roundhead diameter 0.00.4

several large pills paste poor condition

1 paste bead 0.02 diameter  
0.01.4 thick



1 long paste bead (broken) 0.03.4 long,  
0.03.9 diameter



these cists appear to

1 black stellite button - chipped

1 rounded blackened bead 0.00.8 long  
0.00.9 diameter

1 small burned bone

327 } 1 reddish black stellite button

1 large red button 0.03 long  
0.03.2 large diameter  
0.01 small diameter

1 long glass bead - damaged 0.02.5 long  
0.01.4 diameter

see page (22)

(21)  
Friday  
April 27



22) April 27. Friday from page 21

Tomb XXXVI

numerous small sherds found. (Myc.)

4 pots uncovered by night

in sifting many broken pieces of bone

2 carved paste bead found near chipped  
0.01.6 long  
0.00.7 center diameter  
0.00.3 end diameter

area behind possible door <sup>to back wall</sup> as far as completely  
~~from wall~~ begun to be cleared and knife  
work begun on front.

1 piece of steatite black.

at now seems apparent that the  
left and right area separated by stones

may be combined to form one large tomb

chamber. If so, the top completely done -  
mass of bones appear at left + back of  
left area

see page 23

23

Saturday, April 28

Tomb XXXVI

1 man sifting and  
2 men working with knife and brush  
in left area of tomb chamber. Later

they take out back line of stones and  
pick down on right to level of bones  
and pots on left. This done to try  
to get definite outline of tomb  
chamber.

1 piece of bone implement found in  
further sifting of dirt from left  
area.

0.03.6 long  
0.01.2 diameter at widest end  
0.00.4 diameter at narrowing end  
0.00.6 diameter of hole



However, lump of stones appears  
back of another possible door - length 0.70  
x 0.30, and 0.10 high.

possible door = 0.70 long  
0.50 wide  
0.35 high

Pots in left area - numerous

Pots in right area - "

no bones as yet found in right area  
two tombs? One tomb and side chamber?



(24)

Saturday April 28  
Jamb XXXVII

scale 1 sq. = 0.20

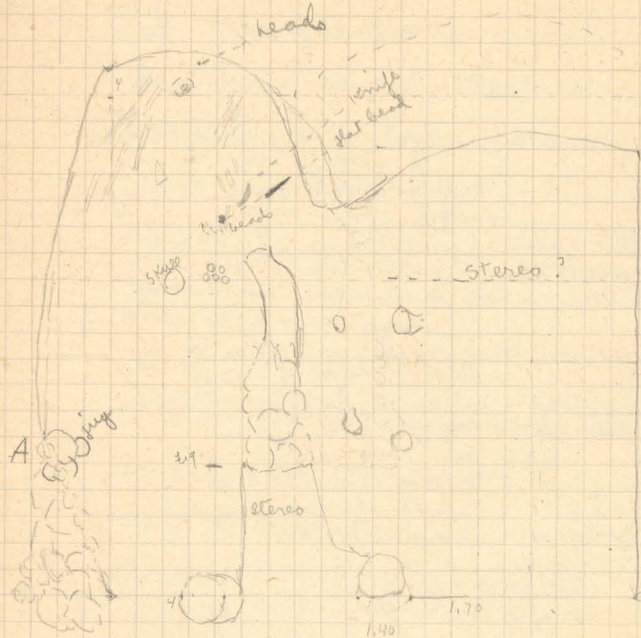

mass of bones in rear of chamber is  
approximately 0.20 above floor level

see page 25

(25)

Monday, April 30

Jamb XXXVI

Two men continue, with knives to  
clear left area. \* Bronze knife in  
poor poor condition found.

1 man sifts earth from right area.

part of paste bead found at back  
of left area <sup>later</sup> numerous pieces of paste heads

1 carved paste bead 0.01.5 long  
4 sides - each side 0.00.6 wide at center  
diameter at ends 0.00.3

1 round paste bead - diameter 0.00.5

1 round paste bead - diameter 0.00.8

1 steelite button - diameter 0.02.6

1 flat paste bead with 4 flutes -  
0.02.2 x 0.02.1  
0.00.7 thick  
2 pieces

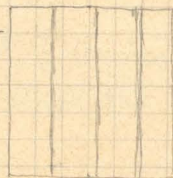

1 pendant paste bead (broken) 0.02.5 long

1 large round paste bead (broken) 0.02 diameter

1 sq. =  
1 centimeter

\* bronze knife removed. blade in two  
pieces. handle of wood or ivory with  
bronze rivet. blade tapers to a point.  
width 0.00.3

blade 0.18.3 - Handle at south west

from point to break 0.05.8

" break to handle 0.03.5

handle 0.04.4

beginning of handle to rivet 0.1.1

rivet to top .03.

diameter of rivet .00.3

see page 26





(26) Monday, April 30 Tomb XXXVI

From page 28  
In removing dagger blade separates into two pieces and handle breaks off into several pieces.

width of knife at break 0.01.8  
width of handle 0.02

see page 28

Monday, April 30

(27)

Tomb XXXIV. From M. Marion Rawson  
Seven men continue to clear dromos.  
Two men work with knives in chamber.

1 large unpainted jug uncovered.

1 small jug uncovered near center of entrance

1 large bone back of door near bronze bowl  
(see M.R.)

In the middle of afternoon bones of animal (?) uncovered. ~~Found~~<sup>at</sup> about center of chamber. Dirt near bones removed for rifling. Bones are 1.25

below surface of lowest point of chamber, and 1.65 below point directly above them

see page 31

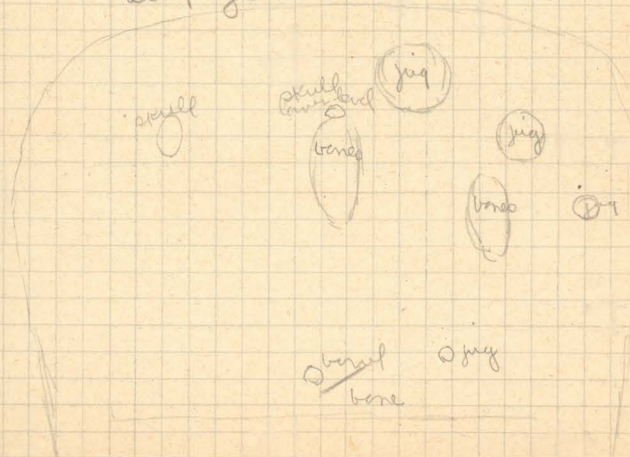



(28)

Monday April 30

from page 26

Tomb XXXVI

toward end of afternoon, a large mass of  
 paste approximately 0.06 long much covered  
 with dirt found in about center of  
 left area near skull

By night ~~three~~ <sup>four</sup> small figurines,  
 1 jay with three figurines under  
 base  
 1 round bowl with holes in sides  
 are uncovered. also two bits of bronze

see page (30)

(27)

Monday, April 30

Stones

middle Helladic grave <sup>XIII</sup> in front  
 of Tomb XXXIV again uncovered. (was  
 covered with earth from chamber of XXXIV)  
 Slabs removed. 2 large; 1 small.

Bones running S. to N. by E and two  
 small jugs appear by afternoon

The two large slabs were not  
 over what is evidently the main  
 burial, but lay with south end  
 over part that probably will be  
 feet.

see page (38)



(30)

Tuesday, May 1 from page (28)

Somb XXXVI

May 1 3 men with knives continue to work floor of left area.

- Early morning, were found in addition to broken (bits of paste)
- 1 pendant paste bead - broken
  - 1 paste bead cylindrical diameter 0.015 (broken)
  - 1 round paste bead (broken) " 0.01
  - 1 cylindrical paste bead - 0.03 long x 0.01 diameter
  - 1 round hard bead dark yellow diameter 0.007
  - 1 " " amethyst (?) diameter 0.007
  - 1 round bead amethyst diameter 0.009
  - 1 " " " 0.01
  - 1 brownish steatite button - diameter 0.019 x 0.017
  - 1 dark purple bead round - diameter 0.007

Figurine found on floor, face down, head to left on floor removed.

- length 0.07.7
- shoulder width 0.02.8
- diameter of head 0.01.9
- diameter at foot 0.02
- 1 crystal bead round diameter 0.00.8

C.W.B took photograph of west area

Higher mass of bones measures 1. metre from back wall directly in front and about below higher mass of bones, a large cist begins to be outlined in this are more bones, with skull.

another fairly large jug in west wall appears. So loose stones A on plan page 27 cut away.

Stairs extends 1.40 from South or outer line of stones to cist.

see page 32

(31)

Tuesday, May 1 from page (27)

Somb XXXIV

2 men with knives continue to clear floor of chamber - May 1

6 men work on dromos.

Foreman reaches Stairs on either side of door -

small jug uncovered 0.90 from outer line of chamber

3 fairly large plectrums (myc.) and several small found in dromos.

Floor of dromos reached at depth of 2.20 from top stone of door.

Height of door from ground surface 3.55  
Somb now measures 5.15 wide by 3.70 deep.

Level being cleared is approximately 1.80 above floor of dromos.

Directly to left of door a large bone, human? a little to right of door in 1.40 small jug  
Bones of animal 1.40 from back wall a little to left of door -

Inward left of these, remains of human bones. see page (34)



Tuesday, May 1 from page (30)

Tombs XXXVI

1 small jug uncovered from under loose stones at west wall of west area on floor.

Fallen door = 1.05 wide

all loose stones from door (now certain) to west wall cut away with knives.

This left or west area may now without doubt be said to be the main chamber and the right or east area a side chamber. The sides <sup>of left</sup> are straight, the back narrows in a curve.

at outer end stairs was reached at 0.75 below top stone of door and extends in 1.60. on this floor are two pots & figurine and a few bones.

The side door ~~measures~~ 0.65 above this floor and is 1.00 wide <sup>at top</sup>. It begins 1.10 <sup>from front door</sup>.

The line of stones across chamber breaks <sup>at</sup> 0.40 from west wall and a small cist with bones appears. Small bones on straight line of stones appears on upper level. <sup>East</sup> Larger cist with bones and skull found appears 1.50 from back wall

see page 33

Tuesday, May 1 from page (32)

Tombs XXXVI

two jugs, one with <sup>two</sup> three figurines under base and four separate figurines lie front and back of this larger cist on same level as front stones. at the back a large mass of bones extends all across the chamber. Bronze knife page 25 found at east side fourteen pits in all show on surface.

narrow trench 0.50 in front of door and extending about 0.70 to either side begun. a few shreds found stones reached at 0.50 - 0.60 below surface.

see page (37)



(34)

Tuesday, May 1 from page (31)

Tomb XXXIV

0.80 to right of small jugs, 2 more animal bones.  
 almost against east wall small outhouse  
 a large wine jar on their sides, turned  
 right back of chamber.

• Dromas measures 1.80 wide at door at top  
 and 1.85 at floor.

~~Dromas~~ measures 0.95 at top 1.00 at floor

Dromas measures 1.60 at outer end.

men had cut away 0.50 at right + in

1.85 toward door beyond actual steres

~~the~~ outer large jug has round flat  
 piece of pottery - is it a cork?  
 (later no)

see page (35)

(35)

Wednesday  
 Tomb XXXIV. from page (34)

3 men working, clearing floor  
 level.

May 2

Human skull is uncovered 0.40  
 to left of inner line of animal bones,  
 0.90 from west side of chamber.  
 and 1.00 from back - badly damaged.

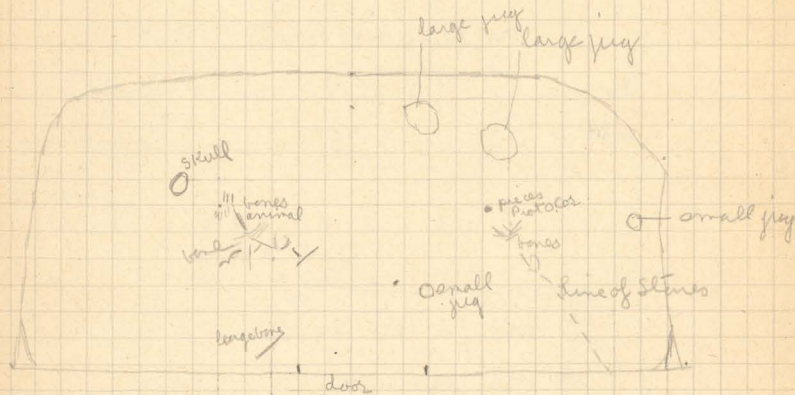

— 1 sq = 0.20

see page (36)



36

Wednesday from page (35)

Somb XXXIV

May 2 a band of red soil 0.30 from floor of  
Oromos runs straight across door embedded  
 in loose earth which forms a gap 0.30 high  
 beginning 0.25 above floor.  
 1 sq. = 10 centimeter

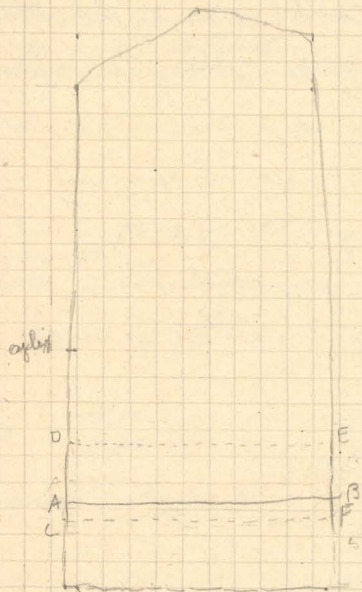

A-B = line of reddish soil 0.00.4 wide  
 area CDEF = soft earth - no stones in front -  
 C.W.B. photographs Oromos - afternoon  
 C.W.B. photographs chamber to show  
 two large frogs.

Three men work down level of  
 floor all day -  
 line of stones appears, running from  
 South East corner to <sup>right</sup> depart of animal <sup>legs</sup>  
 see page 45

from page (33)

Wednesday May 2 (37)

Somb XXXVI

2 men continue to work clearing  
 earth from door. one man shifts  
 earth taken from west area. 1  
 they also begin to cut down earth  
 out from trench (page 33)

Oromos is 1.84 wide  
 chamber is 1.97 "

Door is 1.20 wide

a number of sherds found (1 piece at  
 least of yellow Menyan), others L.H. III.  
 Shores reached at 2.10 <sup>South</sup> from door at  
 depth of 0.20 below surface

slab 0.06 thick, in  
 0.45 high  
 0.25 wide

is uncovered at left of door

Two men now work with knives  
 trying to find outline of cist  
 or chamber to the East.

It seems to be cist outlined  
 with fairly large stones.  
 from door it measures 0.70 deep  
 1.2 East to west and 2.00  
 wide see page (42)



(38)

May 2 Wednesday

May 2

M.H. grave XIII.

1 man continues to clear bones.  
The skull is badly damaged.  
The skeleton seems to be lying slightly  
turned to left side in cramped  
position.

cist now measures 0.45 deep  
1.40 long  
0.60 wide

one jug exposed at left of skeleton  
on line with shoulder. also

one cup - murex? also at left on  
line with elbow. Left femur shows.

Right arm shows entire, the left to  
elbow only. only one leg bone to be seen.

Skull points south west.

C.W.B. takes photograph - morning.

Earth sifted - a few small bones  
found and replaced in grave.  
see page (49)

May 2, Wednesday  
middle Hallabac grave  
XIV.

(39)

May 2



3 men remove  
top slabs covering  
grave.

1 man digs outlines of cist.  
finds bones at depth of 0.50  
By mid afternoon only 2 small  
pieces black & yellow painted Matt  
were found. and one small sherd.

By night - cist measures 0.65 deep  
at west end, 0.50 at east end, 0.55 wide  
1.28 long

No bones found. Presumption is  
that grave had been robbed.

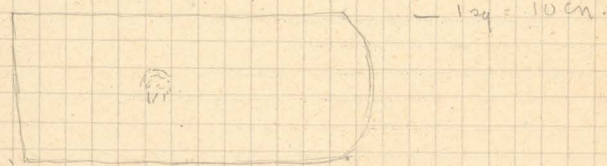

grave runs east to west. The few  
bones lie 0.60 from west end 0.20  
from each side.



(40)

Wednesday, May 2  
Middle Helladic grave XII.

May 2

cist 0.60 wide  
1.90 long  
0.20 deep at north side  
0.60 deep on south side

Skeleton lies East to West with skull,

badly damaged at East end. Bones of

pelvis seem to lie flat, legs turned

to right side, in bent position, left leg  
over the right.

Total length 1.38

Length of femur 0.38

Length of tibia 0.32

one man clears these bones with knife and  
brush and finds nothing.

A.T.H. begins to remove boxes  
and finishes - nothing found.

From page (18)  
Wednesday, May 2 Tomb XXXV (41)

May 2

Floor level of chamber is approximately  
1.20 above upper level (back)  
of Tomb XXXVI.

Is there another level in Tomb  
XXXV?

2 men sift earth (page 13)  
and find one small sherd.

see page (43)



(42)

From page (37)  
Wednesday, May 2.

May 2

Tomb XXXVII

Both the East and West sides are  
now cleared for photographs and  
drawings.

C. W. B. takes photographs of  
a) door,  
b) east or side chamber.

Miss Cox measures tomb preparatory  
to drawing.

see page (44)

Thursday, May 3

Tomb XXXVII

From page (41)

(43)  
May 3

- 1 man finishes sifting earth  
finds four seeds
- 1 piece twisted bronze wire 0.02 long
- 1 shell 0.05 long, diameter at  
greatest width 0.02.5

see page (130)



(44)

May 3

From page (42)

Thursday, May 3

Jamb XXXVI  
Mrs Cox draws chamber.

A.T.H. removes figurines and pots

#3, #5

under <sup>sample of</sup> Pot #3 found 1 brownish  
steatite button 0.02 long1 workman begins to remove bones and  
shards.

outer skull measures 0.9 x 0.15

Found directly back of skull were

1 paste bead round diameter 0.02

1 " " cylindrical - 0.03.3 long (broken)

1 pendant paste bead - 0.02.5 long (broken)

1 carved paste bead flat

1 piece bronze - bad condition 0.02 x 0.01.2

0.00.7 thick

1 pendant bead - broken

2 bits bronze wire 0.02.5 long

all dirt removed for sifting

In small cist at west wall (see page 32)

a skull appears

also a <sup>bone</sup> pot 0.70 from back wall and

0.40 from east wall.

1 paste bead round 0.01.2

1 carnelian bead round diameter 0.00.5

1 round paste bead diameter 0.01.7

1 round flat paste bead

thick 0.00.3

1 broken steatite button long 0.02.5  
diameter 0.00.91 flat paste bead similar to that on  
page (45)1 smashed paste bead  
see page (47)

Thursday, May 3 From page 36

(45)

Jamb XXXIV

3 men working with knives cutting  
below floor level.

fairly large pots. Cornelia

pot in many pieces found 0.70  
south of outer large jug.four pieces of same found 0.30  
back and 0.30 to left of small  
outer pot.In afternoon 5 men working  
By night they have reached  
level of 0.50 below floor and  
of 1.40 at back of chamberBone 0.30 long - rib (?) appears  
0.50 in front and 0.40 to right  
of skull

see page (46)



46

May 4

Friday, <sup>from page</sup> May 4 (45)

Tomb XXXIV

Four men with knives continue digging down level of chamber floor

1. Cox draws Eastern area (where large pots are)

in afternoon draws western half of chamber

2 large bones appear. No. 20 long running south from larger pile of animal bones the second is 0.30 long and lies at right angles 0.04 distant from first

Nos. # + 2 large jug removed (amphora)

3 wine jug removed

4 small gray jug

5 2 red sherds

6 small cup found inside large jug #2

human jaw appears 0.50 ~~west~~ of inner amphora

1 very thin piece of bronze, seemingly  $\frac{1}{2}$  of a circular disc with hole 0.005 in center diameter of disc 0.065, appears 0.80 from door - also several small pieces of same.

(after undressing) stones near amphorae and to right of door removed.

animal bones and two large bones to

left and right of door removed  
see page (5)

from page (44)

Friday, May 4 Tomb XXXVI May 4 (47)

1 man continues to remove upper stratum of bones and sherds -

By 8.30 7 more pots appear and ~~two~~<sup>3</sup> skulls, 2 bowls

1 man sifts dirt. 1 paste head found in dirt (round) 0.008 diam.

2 cylindrical paste heads 0.04 long

both broken  
4 pieces of paste

1 round paste head 0.009 diameter

1 flat round paste head 0.007 diameter  
0.004 thick

1 flat round paste head 0.006 diameter  
0.003 thick

# 328  
1 green gray ~~stearite~~ button <TC button>  
0.018 long, 0.019 wide

1 black ~~stearite~~ button - broken <TC>  
0.012 long, 0.018 wide

1 round paste head 0.02 diameter

inner large skull removed measures  
0.15 X 0.90

1 broken black ~~stearite~~ button  
0.018 long, 0.023 wide

1 piece bronze between back wall and skull - under bones

portion protruding from under bones  
measures 0.10 - probably <sup>the same as</sup> see page (48)



(48)

May 4

from page 47  
Friday, May 4 -  
Lomb XXXVI

- 1 paste head carved in flutes in middle - knobs on either end  
0.01 long  
0.008 diameter in middle  
0.005 diameter at ends

2nd cleaning beads was found in bag

- 1 bone spool diameter at bottom 0.03  
diameter at top 0.02.2  
diameter of hole 0.01  
length 0.01.9

Between breakfast + luncheon were found

- 1 pendant paste head (broken) 0.02.4 long  
1 rounded paste head diameter 0.00.7  
1 round paste head - bent diameter 0.00.5  
1 flat paste head - diameter 0.00.6 thickness 0.00.4  
1 cylindrical paste head - (broken) long 0.03.5  
1 rounded paste head 0.02.2 x 0.01.6  
1 reddish steatite button 0.02.3 long x 0.02.9 wide  
1 black steatite button - chipped at end  
0.02.2 long - diameter 0.02 (widest)  
1 black steatite button (chipped) 0.02 long  
diameter 0.02.2

2nd part of bronze tweezers (see page 46)  
both halves broken

length of one half 0.06  
length of 2nd half 0.06.6  
diameters at narrow end 0.00.7 and 0.00.5  
diameter at wide end 0.01.3

- 1 pale blue paste head 0.00.5 long Ⓞ  
spool shaped diameter 0.00.4
- 1 greenish gray steatite button  
0.01.4 long - diameter 0.02.1
- 1 flat blue black steatite button chipped  
0.00.5 thick, diameter 0.02.2  
see page 50

from page (38)

Friday

49

Middle Helladic grave XIII. 1 May 4

0.60 wide  
1.40 long

1 sq = 10 centimeters

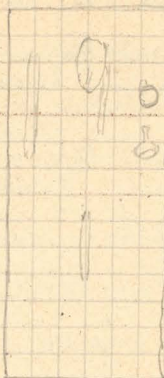

A.T.H. removes pots, and  
gathers bones -  
nothing found



(50)

May 4

Friday, May 4. from page (48)

Tomb XXXVI.

All sherds and pots removed and

all bones after

Dr. Cox has drawn them.

Chamber now cleared and

2 men remove door.

after floor is cleared, the outlines of two

cists are definite.

see page 56

all bones replaced on floor.

1 cylindrical paste head (broken) 0.02.5 long  
found in sifting

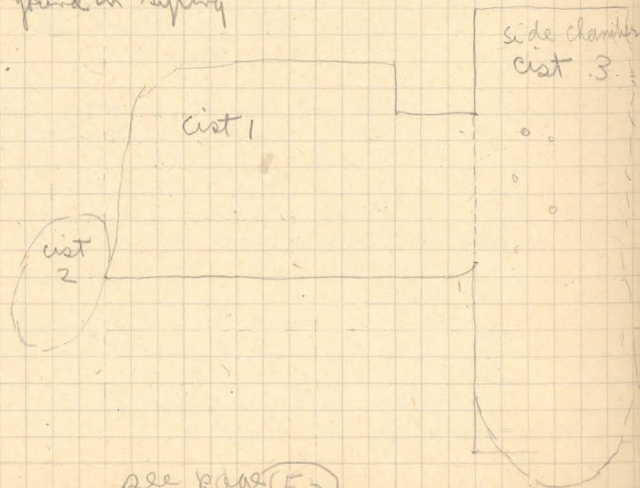

see page (52)

from page 48  
Friday, May 4, Tomb XXXIV.

(51)

May 5

Human skull, measures 0.18.07  
X 0.14.6 removed.

after removal of pots  
and animal bones and skull, four  
men continue digging with knives.

see page (53)



(52)

May 4

From page (50)

Tuesday, May 4. Tomb XXXVI

Door to side chamber removed.

Miss Cox draws side chamber

The four pots removed (removed previously)

In main chamber, in addition to the large mass of bones, two skulls were found and small pieces of 15 more, 6 piquettes, bronze tweezers, one bronze knife, 6 whole pots and remains of about twenty more.

In side chamber 5 pots were found.

For Summary see page (56)

(53)

May 5

From page (51)

Saturday, May 5 Tomb XXXIV

4 men work with knives, two with baskets, cutting down floor. The level has now reached 0.90 below top of door.

Two large bones and rib (page 45) which lie on this level are left in place.

C.W.B. takes photograph of door at 4. metres.

Door removed to 1.50 above floor of dromos. Stones lie throughout from men then continue knife work on floor from to

In this first level the finds (amphora, jug, oenochoe, and bronze) were geometric. One Proto-Corinthian jug found.

Earth is now carried out through dromos:

one piece bronze found into spot where circular disc was found (page 46)

Door now taken down to 0.85 above floor level of dromos. at 0.90 above dromos but at left were found pieces of

see page (54)



54

from page 53  
Lomb XXXIV

May 5.

cylix and one sherd of myc. fish net pattern. Stones at this level extend 1.10 in from front of door.

By room front of door is 0.25 below <sup>chamber</sup> floor level near door.

Two small animal bones appear 1.40

back of right side of door - removed

In the afternoon <sup>all</sup> the large stones from door are carried away. The door is taken down to 0.90 from floor of

drums.  
nothing more found in chamber by night

see page (55)

from page 54 Lomb XXXIV Monday (55)

4 men with knives and two baskets continue to remove earth from chamber - a few sherds (myc) found.

skull with scattered teeth appears <sup>3rd level</sup> long on its right side, jaw to back wall 2.20 from right back wall in line with left side of door. 0.25 below <sup>second level</sup> + 1.70 from west wall.

Bones on 2<sup>nd</sup> level human? 1.60 from back wall. 1.60 <sup>in</sup> from left side of door



Bone A .26 long .0.05 at wide end and 0.02.5 at narrow end:

Bone B .0.18 long X 0.03 wide

Bone C .0.13 long X 0.05 wide

Bone D 0.15 long X 0.25 to left of A

Bone E 0.27 long. front 0.70 from front of A. back 0.55 from back of A.

Point F 1.35 from side wall.

In removing pile under these bones, many small shells and bone stones, fallen not pierced found see page (72)



from page 52  
Jomb XXXVI - Summary

Dromos

Length 2.95  
width at outer end 1.12  
width at inner end 1.84  
Sides vertical  
Depth of dromos at door 4.00  
inner angle 45°  
slope of floor

Door

width of jamb right 0.34 left 0.46  
width of door on floor  
inside 1.00  
outside 1.00

depth of door 0.69  
sides of door vertical  
height of door 0.75

stones - small in general. one flat slab on left 0.45 high, 0.25 wide and 0.06 wide

Side Door  
chamber

width of jamb (left) could not be defined  
width of door on floor  
inside 0.90  
outside 0.93  
depth of door 0.46  
sides of door vertical  
height of door 0.65  
top of door - straight across  
stone wall closing door - small flat stones  
two large stones at bottom on left.

Chamber - main

length 3.40  
width at door 2.00  
at back 1.50.

ceiling not preserved. floor 4.00 from surface  
corners right angles.

Across the entire width of chamber and extending out 1 meter and up 0.40 from level of floor was spread a mass of bones, skulls, sherds and pots (remains of 15 skulls). Scattered throughout this area - chiefly at right were found potsherds, steatite buttons, 1 bronze knife, 1 pair tweezers.

In front of this area lies a cist with rectangular niche at back and with a small oval cist cutting off its western South end.

large cist measures 1.20 long (across chamber) (57)  
0.50 wide and 0.22 deep  
niche cut out 0.60 from west wall, 0.25 from eastern edge of cist is from 0.20 to 0.35 deep

In this cist were found more potsherds and steatite buttons and bones and a few sherds.

The oval cist runs a little north of west 0.25 deep measures 0.53 X 0.26 and overlaps larger cist by 0.18. In this were found bones and one skull.

The larger cist is 1.55 from door.

on the floor were found four separate figurines 2 pots (one with two figurines under handles) and a few bones.

Chamber - side to side 1.8. N. to S. 3.37  
Side door to back 2.30  
ceiling lacking

no bones or pots were found at back or sides of chamber.

one cist, roughly outlined by stones at back and left side and by curved line of stones at right measures 1.87 X 1.00 .05-.10 deep. In this were 5 pots.

Inventory of Jomb XXXVI

- Pots L.H. II

- many fragments potsherds
- 1 pair tweezers (bronze)
- 1 bronze knife
- 6 steatite buttons
- 1 bone object
- 1 cornelian bead
- 2 crystal bead
- 1 bronze pin
- 6 glass rings
- 3 amethyst beads
- 26 pots
- 17 shells
- pieces bronze (over)



In the main chamber  
Here was no placed skeleton. The two pots  
and four figurines and a few small  
bones found near door were probably of  
the latest burial.

The floor level of this tomb lies 1.20  
below that of 35.

The surface of the rock slopes up a  
little from level of 34 toward 35 and 36.

In main chamber toward front there was  
a stratum of blackish ~~the~~ earth 0.34 deep  
at level of 0.35 above floor. In this  
were found bits of charred bone.

Tomb 36 lies 2.10 East of 35.

Inventory continued

- 10 Terra cotta buttons
- 1 terra cotta weight
- 9 small pieces bronze
- 1 pierced bone implement
- 57. paste beads
- 23 round
- 11 cylindrical
- 7 large flat
- 1 cushion
- 1 small barrel
- 5 pear pendants
- 5 flat incised
- 2 fluted (1 round, 1 flat)
- 1 small double round
- 1 glass paste

Summary - Tomb XXXIV.

Dromos

length 9.50  
width at outer end 1.20  
width at inner end 2.00  
slope of floor - gradual  
sides - slight inward inclination  
depth of dromos at door 3.20 from surface  
inner corner - angle at  
sheds. Myce

Door

width of jamb - left side .55 right side .50  
width of door on floor  
inside 1.05  
outside 0.91  
depth of door - right side 1.86, left side 1.84  
sides of door slight inward inclination  
top of door - shape - curves <sup>down</sup> 30 left to center  
height of door 2.20 then down .10 to right.

Stone wall ~~above~~ door - stones at front flat, back  
rounded many fallen into chamber.  
cylid stones 2 in door.

chamber. depth - front to back 3.30  
side to side 4.15  
ceiling - fallen, a curve in rock begins  
2.60 from floor. surface of ground 4.75 from floor.

Tomb 34. lies 3.40 East of Tomb 33. It is  
cut into strata topped by thick ledge of  
conglomerate. The floor level is 2.10 below  
that of 35. The ceiling was fallen, making  
digging down from above necessary throughout.  
The chamber is rectangular; corners at back  
right 45, at front slightly curved. measures  
4.75 from floor to surface of ground.



(60)

Dromos

Tomb 34

There is an inight beginning at door + running out 2.50 a ledge of stones 0.25 wide, and 0.20 high. on left side of door and in center of dromos, stone rises gradually in a slope (height about 0.10). at first this depression was thought to be the dromos of an earlier and later chamber but floor level of chamber was found to be flush with this cutting.

The dromos runs at a slight angle to the chamber, <sup>coming in off axis near right side of chamber and looking</sup> this may be explained by the presence of Tomb 52 which although at a

higher level is of earlier date than 34.

Dromos had gradual slope to the depression.

In the dromos were found many sherds.

2 Mycenaean cylix stems in door.

The door was preserved to height of 2.20.

many stones had fallen into chamber.

The stones at front were flat laid in irregularly those at back were fairly large & rounded.

A line of reddish earth 0.04 wide run across door at height of 0.30. This line was later traced in right side of chamber and in cist under door.

Right hand protrudes  
0.15, for 0.50 from floor  
and 0.30 wide.

(61)

Tomb 34

This probably indicated fumigation of some kind. (Traces of fire in chamber also noted later).

Chamber may be divided into four levels.

The highest level was geometric and was reached at 1.40 - 1.50 above floor level.

At this level were found

- 2 large amphora at back
- 1 wine jug
- 1 small gray jug
- 1 Proto-Corinthian jug
- 1 small cup (wine amphora)
- 1 bronze bowl
- 1 small bronze circular disc (near door)

The second level contained only the bones of a goat lying a little to the left line of door toward the back of the chamber, about 1.15 above floor level.

The third level contained an animal skull, an human skull and bones and lay about 0.90 above floor level.

The following finds were made about 0.50 above floor level near

Skull of 3<sup>rd</sup> level

- 1 stearite button
- 1 shank of stearite button
- 24 round paste beads

see page (62)



(62)

June 34

- 1 carved paste head  
7 broken paste heads

at height of about 0.40 to floor level were:

A heap of bones and <sup>40</sup> pots beginning at right back wall going to center of chamber; extending 0.80 - 1.20 out from back wall

on floor level:

1. a placed skeleton lying near S. W. corner in contracted position - head to west lying on right side - arms in place ribs scattered, this probably the latest burial
2. 1 coarse red bowl 1.40 <sup>back</sup> from door
3. 2 bronze knives (one near skeleton, one between skeleton & heap of bones)
4. red pierced seal stone near skeleton
5. 1 bronze arrow head
6. 2 steatite buttons
7. 3 round paste heads
8. 4 obsidian arrow heads
9. 1 flint arrow head

5 cists and one niche were found:

cist I lies against anterior left wall measures 1.20 X 0.60 X 0.30 - 0.50 deep

contained 10 pots, 1 I. H. I. stand 2 skulls, large & small bones.

(63)

June 34

cist II lies against left wall (against part of niche between) cists I and III

measures 0.50 X 0.60 X 0.45 deep

Contained blackened (but not necessarily burned) bones.

cist III lies II to cist I, separated from it by cist II at left and

strip of stones on <sup>right</sup> measures 1.65

X 0.70 X 0.35 deep. Contained

2 pots, two skulls and bones.

cist IV runs 1.80 <sup>along right wall</sup> ~~deep~~ <sup>from</sup>

right front corner 0.70 - 1.00

wide X 0.25 deep. contained

15 pots and 2 skulls.

cist V full entrance completed only

when door fully removed as it

extended to within 0.50 of front

of door. measures 1.80 long X

0.70 wide X 1.20 deep. contained

2 pots, 1 skull and a few bones.

a niche outlined by six flat

stones is outlined in left wall beginning

in left front corner. measures 1.40 X

0.80 contained 10 pots and bones. sight over

slightly (64)

slightly (64)



Jamb 34 <sup>right</sup> from page (63)  
on the heap at back of chamber on floor

level were found two small charred bones  
and blackened earth was found at right of  
cist IV.

The red line of earth in door was 0.30  
above these other traces of fire.

Lying across Sims of stairs at a slightly  
lower level than skeleton in S.W. was  
another skeleton in place with head on edge  
of cist III and leg bones <sup>contracted</sup> on edge of cist I.

Inventory:

- 61 Pots
- 5 Skulls
- 50 ~~24~~ <sup>(47 round)</sup> round paste beads (1 molar, 1 pear shaped, 1 fluted)
- 11 obsidian arrow heads
- 1 flint arrow head
- 1 seal stone (steatite)
- 2 bronze knives
- 6 steatite buttons (1 damaged)
- 1 bronze bowl (broken)
- 1 bronze disc (broken)
- 3 pierced shells
- 3 bronze arrow heads
- 1 bronze pin (5 pieces)
- 10 pieces bronze
- 7 broken paste beads

Summary - Jamb XXXV

Dromos Length } no dromos could  
width at outer end } be defined.  
width at inner end  
slope of floor  
sides  
depth at door  
inner corner angle

Door - width of jamb } no jamb could be defined  
right side  
left side  
width of door on floor  
width 0.78  
outside 0.73 80  
depth of door - (front to back) - 0.80  
sides of door  
+ top of door - straight -  
stone wall closing door - small flat stones laid in  
Height of door - 0.45 regular courses (3)

Jamb 35 lies 8:20 from right side of chamber of 52.

Chamber - width - 3.17  
depth - 2.18 - sides curve gently to back  
ceiling - lowest point of rock after it begins  
to curve definitely, 1.35 from floor.  
no real ceiling preserved. 7 ft from floor to surface - 3.10  
Here are four cists -  
1. central - directly 0.45 back of center  
of door. 0.84 long, 0.30 wide 0.20 deep  
remaining North to South -  
contents  
4 squarines  
3 two small pins  
1 cup  
1 beaker  
2. Right - lies 0.40 to right and  
0.40 back of door  
measures 0.60 long X 0.42 wide 0.30  
deep



(66)

Tomb XXXV

2. Right cist

contained - 4 long bones  
1 small jug (No. 5)

3. Left outer. 0.70 from left of door on line  
with it.  
measures 0.50 long x 0.45 wide  
x 0.30 deep.  
nothing found

4. Left inner

measures 0.55 long x 0.42 wide x 0.15 deep.  
contained 1 figurine,  
2 skulls

## Inventory Tomb XXXV

- 5 figurines
- 6 plates
- 2 skulls
- 1 crystal bead (?)
- 3 pierced shells
- 1 stentile bead
- 1 bit bronze wire
- 1 shell

It was thought at first that owing to the high  
level of Tomb XXXV, in relation to XXXIV and  
XXXVI that there was a lower level, but this could  
not be ascertained. Tomb LIII is also at a high  
level.

(67)



May 7

a Middle Helladic grave

114.50 directly in front (south)

of grave III was uncovered

1927. see Robinson notebook page 130.

The slabs were moved and small  
stones removed. grave lies S.W.-N.E.  
only one slab still in place <sup>is</sup>  
Two men had remove one remaining

slab 0.90 x 0.63

Dig down in reddish soil to  
depth of 0.40 and reach stones.

cist measures 1.40 x 0.65

Later cist deepened 0.07 - 0.10 and

enlarged to 1.42 x 0.80.

Nothing found.



70  
May 7

Monday

Middle Helladic grave  
lies 6.50 to west of grave page 69

1 large stone 0.65 long, 0.30 wide, 0.35 high  
1 smaller one standing upright removed  
and two men dig down with picks

steros reached at depth of 0.40

Cist (?) measure 1.00 X 0.60

nothing found

Monday

May 7 71

1 workman digs up earth directly

To South west of large stone placed 1.10  
to west of M.H. grave XI dug

1927. Steros found almost immediately

Stone 1.40 X 0.70 X 0.30 thick

removed. Steros again reached at

0.20







(74)

May 8

From page (73)

Tuesday, Tomb XXXIV

next course of door stones cut away,  
these are laid edge across and back  
Back stones smaller and rounder than front  
ones which are fairly flat.  
Door now reduced to 0.55 above floor  
level of drums.

During afternoon a few sherds found near  
door.

Left inside of door cut away to width of 1.10

see page (75)

From page (74)

Wednesday, May 9 Tomb XXXIV

(75)

May 9

4 men with knives and two  
with baskets continue digging  
down the chamber level.

Floor level now about 0.60-0.50 above drums floor  
a few sherds found near door and to left  
myl. 2 of octopus pot.

During morning many more sherds Myc?

found also

- 1 purplish steatite button  
widest diameter 0.02.1  
length 0.01.1
- 1 paste bead - diameter 0.01.3  
diameter of hole 0.00.4  
length 0.00.7
- 1 round paste bead  
diameter 0.00.9
- 1 curved paste bead.  
4 uneven flutes  
length 0.01.4  
diameter 0.00.8
- 1 chipped paste bead  
length 0.00.7  
diameter 0.00.6
- 1 round paste bead broken in halves  
diameter 0.00.9
- 1 round chipped paste bead  
diameter 0.01.1

afternoon 2 1/8 whole paste beads diameter 0.00.9  
7 5 broken " "

these were found near ~~neck of~~ <sup>skull</sup> ~~button~~  
found in S.W. corner - lying S. to N.  
with head at South. skull cracked

- 1 Shank of ~~stone~~ <sup>steatite</sup> button - green grey  
length 0.01
- wide diameter 0.01.7
- narrow " 0.00.5



see page 76



(76)

from page 75 Wednesday

Jomb XXXIV

May 1

Dirt near skeleton set aside for sifting

found 5 bits thin bronze wire  
lengths: 0.03.5, 0.06, 0.018, 0.01.7  
& 0.015

1 ~~paste~~ paste head - round - diameter 0.00.8

against west wall 0.60 from S.W. corner  
on ball pot.

1 broken flat dish w. large red painted  
handle to right of this small pot.

1 bronze arrow head directly under  
outer edge of skull  
length 0.01.5, width 0.01.3

1 small red painted pot with  
handles directly to right of broken flat  
and to back of chamber.

1 red steatite button 0.01.3 long x 0.01.7

As more & more small bones appear, skeleton  
north and above seems to a mass of bones in a  
niche -

1 more pot appears -  
skull turns out to be broken pot.

Wall now cut away making niche at left  
side of door about 0.80 x 1.40

Skull appears at left back wall (0.40 from  
back - 0.60 from left wall). This may be  
whole skeleton. This is about 0.40 above  
floor of drums.

1 green unresistant paste head - diameter 0.01.5  
slightly flattened found in niche.

This niche is outlined on chamber side  
by line of 6 stones about 0.25 wide <sup>high</sup>

By night 14 pots are visible and  
2 skulls. see page 77



from page (76) Thursday

Jomb XXXIV

(77)

May 10

4 men with knives and two with  
baskets continue cutting down floor  
level of chamber.

On right side 3 pots appear  
2 about 0.90 from back wall  
and 1.10 from right.

1 about 1.30 in from right  
side of door.

2 pots (broken) against back  
wall 1.70 from right wall

1 <sup>flat</sup> bowl (broken) 1.00 from  
back wall and 0.45 from right  
side.

Bones (one large) begin to appear  
in front of 2 broken pots against  
back wall.

Between breakfast & lunch

1 large stirring cup 0.90 from  
back wall

a good many sherds (myc)

1 paste head - round diameter 0.01.2

at the right back pots and bones  
(no skull) seem to be thrown in a  
mass.

To the right of door - against right  
wall a grave with skull and

see page (78)



78

May 10

from page 77 Thursday Tomb XXXIV

5 two pots are gathered gradually. cist  
measurements 2.00 x 1.00, narrowing at inner end.

One skull <sup>0.50</sup> appears ~~in the cist~~, other to left of

left side of door & in about 1.50 from  
front. also a group of bones to right of skull  
then reaching shelves at about 0.40 above

brass floor level. near door

22 pots visible by room  
all but seven are badly broken.

Several large bones appear in cist 0.35 down  
skull near door.

1 sq = 2 c.

Bronze ~~skull~~ <sup>knife</sup>, tip to wall 0.70 from back  
wall, 0.15 from left wall

0.14 long, 0.015 wide at handle end, 0.016 wide  
at middle, tapers to 0.003 wide. 2 rivets, one  
0.025 from handle end, other 0.01. In removing, breaks  
across 0.06 from tip, 0.017 wide between rivets

Red pierced seal stone, plain on one side  
curved from thin edge to center  
found 0.70 from back wall 0.09 from

middle of knife

0.014 long at hole  
0.016 greatest length  
0.015 wide  
0.005 thick



In cist at right 1 purplish gray steatite bottle  
0.008 long diameters 0.005 and 0.014



see page 79

79

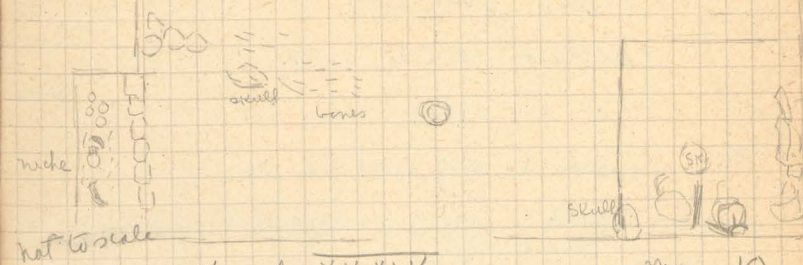

Tomb XXXIV

May 10

there are traces of fire in cist at  
right near side wall, also near

bronze knife. two pieces charred bone  
0.90 from back wall 0.92 from right wall  
By right 5 skulls show in right  
cist, 41 pots in all

see page 80



(80) from page 79 - Friday

May 11 Tomb XXXIV



4 men with knives - ~~one~~<sup>2</sup> with basket continue clearing chamber. skeleton at left back (page 76) is in place, lying on right side head to left wall in contracted position. arms in place & partial femur and tibia ribs scattered

Bronze knife, lying west to east, handle to west  
1.05 from left wall, 0.15 from back,

0.12 x 3 long, 0.01 wide at handle end, 0.018 widest width, tapers to a point (chipped)  
3 rivets - 0.05, 0.026, and 0.005 from handle end.

Working on left side, during morning found scattered small + large bones - 2 skulls

pots (1 stirring camp

2 paste heads - round - diameter 0.009  
similar to those found in niche at left and just outside of niche (page 75)

1 stone arrow head 0.026 long x 0.009 wide  
obsidian

1 stone arrow head 0.028 x 0.014 wide  
obsidian

By noon 5 more pots appear - left side  
1 fragment I + II against left front wall

1 large fragment (late) in door way right.

1 obsidian arrow head 0.034 long x 0.013 wide - some obsidian see page 81

afternoon

from page 80

Tomb XXXIV

(81)  
May 11



The placed skeleton at back and scattered layer of bones and pots and right back are about 0.40 from drums floor level. Bones on level line with inner end of niche (page 78) are slightly below back level.

Digging down at left belvedere + niche another cist is being outlined - similar to that on right.

The area of steres near door page 78 proves to be fallen.

at left again 1 obsidian arrow head  
0.04 x 0.015.

7 more pots visible

1 steatite button 0.008 long x diameters  
0.006 and 0.014

1 flint arrow head point broken  
0.05 long, 0.013 wide

a hole ca 0.60 deep, <sup>expanding</sup> 1.00 deep

see page 81(2)







Saturday Tomb XXXV

(83)

May 12

3 men start to remove heap of earth piled in front of door - finish + close

Saturday Tomb XXXIV from page (82) (84)

May 12

The height of back area corresponds with height of thin red line in soil in door noted on page 36.

This may mean that tomb level below was fixed - charred bones found on this level (page 79) 0.40

The skull and scattered bones in left center (page 78) seem to be a little below level of back skeleton.

These may be the latest interments.

1 man cleans up bones and pots.

Small piles of small bones removed.

Area at right back can not as yet be called a heap - too spread out.

Can all stereo area now left be fallen and this level (0.40) be second burials?

The line of red earth noted in page 36 can be traced in inner side of door and in outlines of hole in front of door (chamber side)

May this mean that present floor see page (85)



(85) From page 84. Saturday  
Jomb XXXIV

May 12

level was filled in over earlier (smaller) chamber. otherwise why is lower floor level below floor level of chamber?

\*

chamber is now ready for second lot of photographs and drawings.

chamber measures 4.15 wide x 3.15 deep with niche in left wall 0.80 wide x 1.40 ~~deep~~ <sup>long</sup> outlined by 6 stones.

In niche are visible 13 pots and small bones.

Cist I 1.20 x 0.60 (long end along front left wall) contains 2 skulls, large + small bones and 10 pots.  
depth 0.50-0.30

Cist II about 0.50 x 0.60 against wall of niche between cist I + III contains

blackened bones in poor condition. (older?)  
depth 0.40 below top of niche stones

Cist III runs parallel to cist I measures 1.65 x 0.70 - depth 0.35, contains 2 pots, a few large bones and 2 skulls.

Lying across cists III + I with head to back wall and about 0.15 below floor level is a skeleton in place. The femurs and pelvis are lacking but lower leg bones  
see page (86)

From page (85)

Saturday, Jomb XXXIV

(86)

and feet; head and arms are in place. May 12

To right of this skull is another badly smashed with a few bones, large <sup>bone</sup> <sup>apts</sup>, however are gone.

at back wall on floor with lead to left wall lies another skeleton in place. also smashed. but contracted leg position may be clearly seen.

extending along back wall from about center of chamber and width gray from 0.80 to 1.20

lies a mass of bones, 21 pots and two skulls. This is on floor level more underneath probably. Two bits of burned bone found. (page 79)

Cist IV extends in 1.80 from right front wall and is 0.70-1.00 wide and 0.25 deep. The earth at outer right shows black, fire. Cist contains 20 pots and 3 skulls.

Separated from cist I by line of stones 0.40 wide and from cist II by line of stones 0.30 wide lies a hole 0.60 deep, 0.70-0.80 wide (see page 87)

see page (87)



(87) Saturday, Tomb XXXIV from page (86)  
May 12

line with door) and 1.00 long.  
a few bones already found in this are they in  
int or part of earlier chamber? Time will  
tell.

1 small coarse red bowl lies on floor  
1.40 from door and a little to right of middle  
of door.

The area at right and back of chamber  
seems to be drier than the rest. Can damp  
line outline the earlier & smaller chamber?  
It forms, roughly, a circle.

The Pottery, with the exception of one sherd  
which is L. H. I., is L. H. III.

Brooms.

In front of door in chamber there is  
a slight depression in the floor. This <sup>part</sup>  
measures 1.00 wide (width of door) X 2.50  
on the right the stereo rises about 0.20  
in a step. The width of this <sup>portion of</sup> stereo is  
0.25. on the left the stereo rises gradually  
to left wall.

This depression may indicate the width  
see page (88)

from Page (87) Tomb XXXIV. Saturday (88)  
May 12

of the original chamber - of a smaller  
chamber. ~~the chamber is~~  
~~small.~~

The layer of fallen stereo comprising  
floor of exposed chamber would be made  
from cutting a larger chamber.

Tomb XXXIV - Monday May 14

Mrs Cox begins second part of drawing.

see page (91)



(89)  
May 14

Monday

Two men working  
In Trench 3.50 to west of geometric frame  
at depth of 0.55 were found group of large bones  
\* and 1 Terracotta animal (Myca also a number of  
sherds (Myca) and several pieces of a cylix.  
Then trench made a little east and west  
of bones, trying to find a dromos. A few  
more sherds found in each trench.

Later in afternoon a few Early Helladic appear  
fairly near surface in western trench.

In eastern trench appear at depth 0.45  
+ 0.30 from east side of trench + 0.30 from south edge.  
jug ( ) in poor condition - badly broken

~~from~~ see page (90)

- \* From tip of nose to tail  
animal measures 0.10 - 0.07.3 tall  
It has both horns and ears - (probably a cow)  
Decorations - undulating stripes of red and green

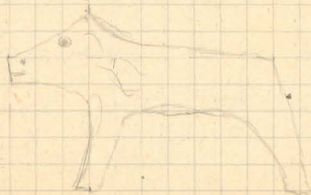

From page (89)  
Tuesday

(90)  
May 15

2 men continue work in trench  
near geometric frame VIII.

1 man in trench to west find 2 sherds,  
E.H. Long first trench deepened.

During morning digging further  
uncovered + more bones including  
skull belonging to group uncovered earlier.

(page 89) area measures 2.25 x 1.80 - length -  
greatest depth 0.80 - smallest depth 0.40 - see page (93)

In long trench 6.00 N.E. of bones  
and 14.00 from <sup>dromos of</sup> south VII a dromos

1.20 wide outlined - this to be known as Tomb VIII later

Three men now follow this in toward IX

a small pile of stones in slope +  
a few sherds and 1 piece 1 cm. 2.4 x 0.05 found.  
see page (92)



(91) from page 88 Tuesday  
Somb XXXIV.  
May 15

1 man sifts dirt.

Mrs Cox continues drawing of plan.

C.W.B. - photographs

- film no. 6. left cists from right wall  
7. Back right area from right wall.  
8. Back right area from west on floor  
9. left inner cist from floor  
10. Back placed skeleton

afternoon - man finds one obsidian arrow head  
length 3.06 - diameter 1.05

Mrs Cox continues drawing -  
1 workman begins to remove pots.

May 16 Somb XXXIV.

Mrs Cox continues drawing.

1 workman removes more pots and bones

C.W.B. - photographs  
2 of right cist

amphora # 34 filled with light gray ash.  
small box reserved for analysis

In removing pots + bones were found

- 8 pierced shells 0.04, 0.035, 0.03 long  
20 whole paste beads - round, diameter 0.009  
+ fragments of same. similar to + here on  
page  
1 fluted paste bead 0.015 long, 0.005 wide  
1 broken " " 0.015 diameter.  
1 steatite button 0.015 long, diameter 0.022  
3 obsidian arrow heads 1.025, 0.032, 0.025  
long  
1 bronze arrow head (broken) 0.036 long, 0.01 wide  
1 " " 0.026 long, 0.017 wide  
4 tiny pieces bronze - tips of arrow heads  
see page 95 (97)

from page 90 Somb XXXIX Wednesday (92)  
May 16

2 men digging down in chert.

During morning - several large  
evidently placed stones 0.25 below  
surface appear. Between them  
and line of rock outlined ~~is~~ <sup>is</sup> toward

slope, the earth is dark, blackened  
at right. at left, at depth of 1.00  
and 2.00 from stones several  
boulders appear. when?

at depth of 1.10 and 0.45 from left  
wall a bronze mesomphiale found.  
It is badly broken, many small pieces  
found, flaked off.  
resembles 0.15 diameter 0.025 deep.

The slightly curved outline of rock at  
back is from beginning of pile  
of placed stone. Are these stones the  
door? No

In afternoon another bronze  
flat bowl found 0.40 from right  
wall, 1.10 from back at depth at  
1.00. Removed whole. It is bent see page (94)  
forming an oval. Diameters 0.117 and 0.105



(93) Wednesday from page (90) top

May 16 - site 29 = 20cm

S.W

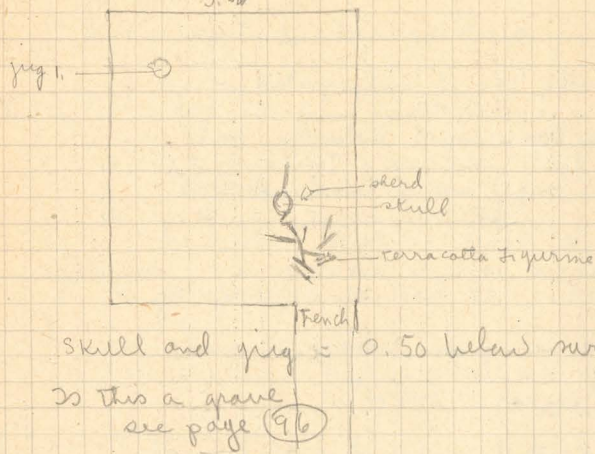

skull and pig = 0.50 below surface

is this a grave  
see page (96)

drums Tomb VIII

wednesday - from page (92)

Tomb VIII - IX

3.40pm May 16

and 0.02.5 deep. (geometrie) <sup>at door</sup> = at other end of

a few geometrie sherds found. <sup>drums</sup>

Two more men begin to clear  
drums on western side of trench.

a few pieces of iron found behind  
door(?)

1 badly broken bronze bowl  
0.12 diameter found in digging at  
right wall, trying to find outline  
of chamber. 2 Myc. sherds found

see page (95)



(95)

Thursday - Tomb VIII from page (94)

May 17

2 men continue to dig out right wall beyond <sup>not placed above</sup> door p slope (in chamber) at depth of 1.05 on left - find badly shattered small bronze bowl - one handle extant.



2 Terracotta spools 0.04 high - 0.037 diameter  
1 broken bronze cup - diameter 0.071  
height 0.053  
handle broken off 0.014 wide

1 lead ring - bent diameter 0.025  
straight piece 0.017 x 0.005 on top.  
(geometric)

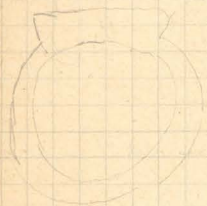

2 pits located at 0.50 <sup>above dromos floor</sup> near left wall of dromos. 1.50 + 1.70 <sup>from left door jamb</sup>  
several pieces iron found in chamber.  
one handle end of sword 0.03 wide by 0.22 long -

Chamber later attacked from above -

By afternoon two men start to dig dromos -

By night dromos is 4.70 long,  
0.95 deep at door and 0.45 at outer end.

Stakes reached at sides and back  
see page (98)

Thursday - from page (93)

(96)

May 17

area enlarged to S.W. in hope of finding meaning of these boxes - see page (143)

2 men begin clearing earth in front of geometric grave VIII to left and right in trial trench. Darker earth in trench may be another dromos.

By noon location of another tomb fairly certain - men dig in further toward geometric grave VIII from trench.

This to be known as Tomb VIII and the tomb to its left (north) changed to tomb IX.

see page (99)



(97)

Thursday from page (91)

May 17 Tomb XXXV

chamber now entirely cleared of pots and bones.

In all levels 71 pots were found  
13 skulls.

Two men begin to remove more of door to 0.30 above dresser floor.

Then the whole door.

It is now seen <sup>(door is near door dug out a little more)</sup> that the line of reddish soil is about 0.10 above floor level of chamber at back.

The remainder of the door is removed during afternoon. 2 (myc.) sherds found.

The cist in front of door is dug out.

measures 1.80 long, 0.70 wide, 1.20 deep.  
It extends to 0.50 from front of door.

It contained 2 pots (myc.) 1 skull and a few bones.

The stones of the lower part of door were large and flat at front, but at back were roughly cut round stones.

see page (127)

Thursday - Tomb IX

(98)

from page (95)

May 17

The left side is fairly straight, curving to back. Right side is curved.

chamber <sup>by night</sup> ~~had~~ measures 2.30 x 2.00

see page (90)



(99)

Jan 8 VIII. From page (96)

Friday  
May 18

2 men continue digging dromos.  
This dromos probably goes through  
geometric grave VIII. ~~with~~ chamber  
lying beyond under slope of hill.

By main door found at edge of and  
a little below surface of geometric  
grave VIII. Dromos is wide.

a quantity of Myc. shreds with  
3 cylix stems found.

near door found

- 1 double concoid greenish steatite button  
0.01.6 long, end diameter 0.00.9  
middle diameter 0.01.5
- 1 single ~~best~~ concoid steatite button  
0.01.3 long X 0.02.3 widest diameter
- 1 single concoid steatite button red  
0.01.8 long X 0.02.6 diameter of base

By mid afternoon door is outlined and  
cleaned. top stones missing. <sup>some fallen in part</sup> <sub>at present</sub>  
stones straight across top - small and  
irregularly placed. Height 1.15; width at floor:

0.78 at top 0.60  
Dromos at floor is 1.30 wide

at 1.42 from door is a step 0.10 high  
and 0.40 wide. irregular outline

for second step rises 0.10 above first

# 40 wide see page (102)

Friday Jan 8 IX. From page (98)

(100)

May 18

Two men continue work in  
dromos

Two men work in chamber.

Top <sup>fallen</sup> door stones cleaned

1.20 high from present floor level  
1.00 wide 0.30 from surface  
large and small irregularly cut stones

In chamber at right bronze ring  
Diameter 0.01.2 with 0.00.5

Bronze flat bowl in many fragments  
found in right outer corner of chamber,  
very dark earth around it.

Several pieces of iron including  
large ring 0.05 in diameter.

C.V.B. photographs stones from  
end of dromos. Stones removed.

Door jamb on left outlined.  
width - .33

In dromos myc. shreds (2 cylix  
stems) chamber still geometric.

# 102 2 pots in dromos 1.80 and 1.70 from  
left door jamb (page 95) removed -  
shattered.

1 bronze ring found in back of  
chamber - diameter 0.02.4 see page (101)



(101)

Tomb VIII  
IX From page 100 - Friday

May 18

1 Terra cotta spool 0.04.4 long  
 diameter at ends 0.04.1  
 " " middle 0.02.2

During afternoon chamber enlarged.  
 Stairs of yesterday was not stairs  
 Drums finished. door cleared.

Length = 5.27  
 width at outer end 0.79  
 " " inner end

at 3.20 from outer end on right a ledge  
 appears 0.20 wide forming small step  
 0.35 ~~deep~~ <sup>high</sup>. Rest of floor from this point  
 uneven.

at left beginning directly in front of left jamb  
 jamb has a cist covered with eight flat  
 stones. depth below present top of door  
 = 1.20. depth below surface in middle  
 of cist = 1.60 cist measures - 1.62 x 0.40

Two top courses overhang  
 0.20.

Door high = 1.40  
 width at top 0.60 gradual inclination  
 " " floor 0.70  
 depth = 70-80

See page (103)

From page (99) Tomb VIII Friday

(102)

May 18

2 men now begin to dig out  
 drums beyond trial trench -  
 finish drums.

length = 5.50  
 width at outer end = 0.80  
 " " door 1.30  
 depth of drums at door = 2.00  
 first step begins 2.90 from outer end

Door jamb right 0.33 at floor, ~~0.30 at top~~  
 jamb left 0.33 - at floor ~~0.30~~  
 " width at floor  
 " " top  
 depth

sides incline <sup>in</sup> beginning 0.80 from floor  
 3 stones embedded in left door jamb

four men now begin clearing chamber  
 from above. this area was geometric plane

VIII - at back of chamber floor = 2.80 from surface  
 see of page (104)



(103)

from page (101)

Friday - Tomb IX

May 18

Left jamb width at floor - 0.32  
 Right jamb " " " 0.20

Door is made up in front of fairly small stones irregularly placed - one large stone on lowest course.

1 small coarse red pot (handle gone) found  
 (pot #3)  
 1.20 above floor level

in right wall - diam. 0.07. height 0.075

1 bronze ring - narrow - 0.23 diameter  
 (geometric)

see page (105)

from page (102) Saturday

Tomb VIII

May 19

(104)

4 men continue digging down chamber from above.

# 1 pot found 1.60 from front right wall. 0.30 from back, 0.30 from right wall. 1.30 from lower part of overhanging rock. geometric black  
 top diameter 0.08  
 base " 0.053  
 height = 0.044

pieces of geometric bronze - rim of bowl 0.117 diameter

By breakfast general level = 0.20 below top of door.

Pieces of bronze disc 0.15 diameter found at back - on even level with top of door - embedded in fallen stones.

3 terracotta spools at right back  
 all 0.042 high  
 end diameter of two = 0.04  
 " " " = 0.036  
 middle diameter = 0.022

C.W.B. takes photograph of door (#6)

door torn down 0.55 1.2. 1.5 0.60

from floor of balcony and earth

see page (106)



from page 103 Saturday  
Jomb IX.

May 19

two men continue work in chamber -  
enlarge it at back and right side.

Many <sup>small</sup> pieces of geometric bronze found.

By breakfast mean level of chamber is  
0.60 below highest part of door.

C. W. B. takes photograph of door.

Pot (geometric) 1.00 from right wall, 1.00 from  
front 0.40 below highest part of door

# 4 removed diameter 0.20, 0.022 thick

Door Part of door removed. leaving height  
of 0.70. Some of the stones are flat  
(irregular shape) but most are fairly  
round, all irregular.

# 5 small <sup>black</sup> geometric pot found 0.10 to right <sup>pit 4</sup> of floor

1 bronze pin with <sup>double</sup> knob length 0.075  
1 " " " " " " " " " " length 0.047

By night chamber floor is 0.30 below door.

Stones like not yet completed at back chamber  
now measures 3.00 wide x 2.90 deep

see page (107)

Saturday Jomb VIII

from page (104)

now carried out in baskets end dia = 0.03 May 19

1 terra cotta spool 0.09.1 high middle " = 0.02.2

1 Bronze ring - decorated with piece  
of bronze looped around it - forming  
top -

1 bronze pin - point missing 0.073 long

(0.55)  
at level flush with door. left side

is found bronze bowl. tiny handle  
which is broken off. diameter 0.09  
deep - 0.02.

2 thin bronze discs diameter  
0.03 and 0.055

against left wall (in middle)

1 bronze bowl - diameter 0.11.4  
depth 0.024

with raised portion in middle 0.03.5 diameter

on bottom 3 incised lines around middle

lines and cross-crocs at top outside

on sides overlapping chevron pattern.

By night chamber floor flush with door  
about 0.55 above dromos floor.

measures 3.38 wide x 2.42

see page (108)



From page (105) Monday

(107) Tomb IX

May 21

2 men continue to dig down level of chamber floor.

just before breakfast one man taken away & ota comes to Tomb VIII

In afternoon three men again at work.

(later 4)

By night floor level about 0.6.0 above bottom of door.

see page (111)

Monday. From page (106) Tomb VIII

(108)

May 21

2 men continue to dig down level of chamber. Two men remove earth, (baskets). Still working through fallen stones a few sherds (geometric) <sup>Cyprian</sup> found. (later 3 basket carriers) working.

By noon floor level cut down to 0.40 below present height of door - nearly to floor level of dromos.

One appears at right back. very firm earth cut further back at right back.

Stump vase appears at front left.

2 small pots appear against right wall middle - also 1 stentite button 0.00.6 long, wide diameter 0.01.3

Sirt now removed for rifling & work with knife. Find near grey pot

1 cylindrical paste bead 0.01.4 long

X 0.01

5 cylindrical <sup>olive pot sherd</sup> black paste beads

0.01.2 long x 0.00.7

1 cylindrical black paste bead 0.01.5 x 0.00.6 <sup>olive pot sherd</sup>

see page (109)



from page 108 Monday

Lomb VIII

May 21

1 round black paste bead 0.00.5 diameter

During afternoon a niche is outlined  
in right wall  
and 1 skull, 2 jaws & 5 pots appear-

3 kinds paste heads

21 black, olive pit shape of various sizes  
19 round paste beads 0.00.9 diameter  
4 cylindrical " "

1 steatite button greenish gray  
0.00.7 long x 0.01.4 inside diameter

1 dark steatite pendant <sup>wood</sup> (shape of a pot)  
0.01.5 long - pierced thru neck



1 yellow brown pendant of steatite  
0.01.3 long

also 9 tiny paste beads - a cushion type 0.00.3 long

Six large bones also outlined in niche

The beads were found scattered among bones.

They were not placed in conjunction with the skulls -

at the left front near door two pots (1 atirrup)  
and 1 piece of a skull.

see page 110

from page 109

Lomb VIII

Tuesday

May 22

Two men continue to dig out  
back wall - rectangular niche.

begins to be outlined at back.

knife work at right + back. During

morning 5 more pots and 1 skull  
appears: also.

1 black steatite <sup>pendant</sup> head (pot shape)  
pierced thru neck 0.01.2 long



1 greenish gray steatite pendant bead  
0.01.4 long - diameter 0.01.1



21 2d black olive pit paste beads of  
sizes varying from diameter of 0.01.2  
to 0.00.7 - also a number of fragments  
of same



7 round paste beads diameter 0.00.7  
and fragments of same.

1 paste bead 0.01.3 long x 0.01.8

1 round paste bead diameter 0.00.3

1 flat paste bead diameter 0.00.2

2 very thin paste beads diameter 0.01.1

see page 112



(111)

Tomb IX

From page 107

Tuesday  
May 22

Four men continue digging  
down floor level.

Find small bits of bronze and

1 safety pin of bronze. tip to tip 0.20  
width at ends 0.04.

Five metal lines run across center lengthwise.

During afternoon a few more pieces  
geometric bronze found at back.

Shards also geometric -

at back in a hollowed out portion is  
a layer of burned earth dark gray  
in color with large pieces of hard  
red material - probably brick - this

layer is 0.20 thick deep.

floor level almost reached - work with  
pick stopped.

Chamber now measures 3.00 wide X 3.20  
deep.

one man begins knife work.

see page (113)

From page (110) Tomb VIII

Tuesday (112)  
May 22

During morning outline of tomb  
completed. measures 3.20 deep X 4.20 wide

1 figurine appears in right section.  
scale = 1 sq = 20 cm.

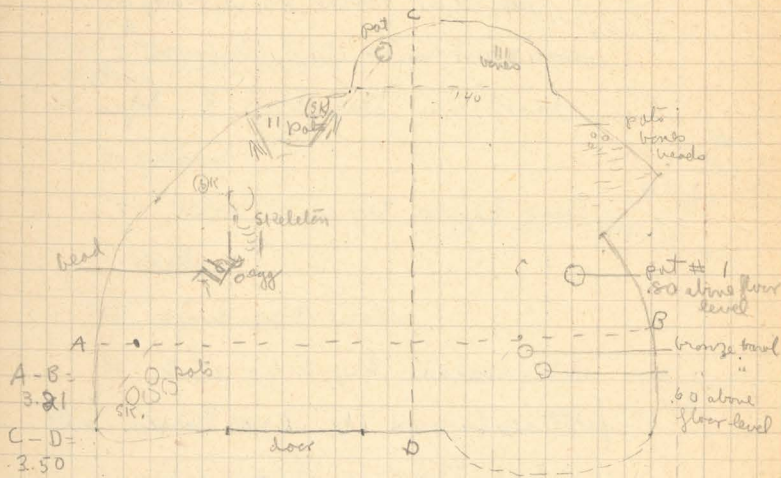

In afternoon work continued at right - found

3 olive pit shaped black paste heads  
(broken)

4 small round paste heads and several  
broken pieces.

The earth in which pots + beads are found  
is very hard pressed stones.

11 pots uncovered at left near back.  
7 of these in line from back wall  
to center.

see page (114)



(113)

Tomb IX

from page (111)

May 22

Monday

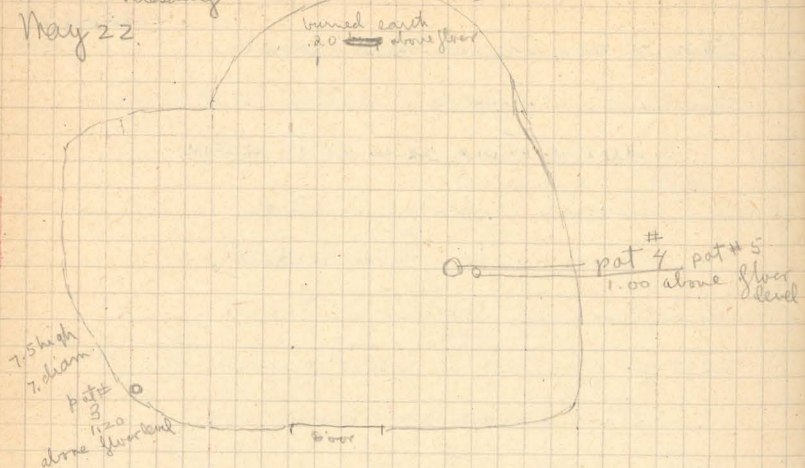

May 23

Wednesday

2 men work about one hour with knives. nothing found.

see page (118)

from page (112)

Tomb VIII

Wednesday (114)

May 23

Two men continue cutting down earth - in chamber.

on left during morning 1 skeleton in place, one skull to its left - see page 119

3 more pots and a few large bones.

on right 3 more pots and heads as follows -

31 black olive pit shaped paste heads.

16 round paste heads.

4 olive pit shaped black + white paste heads (no special pattern)

1 olive pit shape paste head  
0.01.9 long. white background with black spiral inset



1 olive pit shape paste head  
0.01.3 long white background with black spiral

1 reddish stearite button  
0.00.8 long. bottom diameter  
0.01.4

see page (115)



(115) from page (114) Tomb VIII Wednesday

May 23

all these beads <sup>were</sup> found at the right, in no special sequence or arrangement. During afternoon all beads left in place.

Door cut down to within 0.30 of chromis floor level.

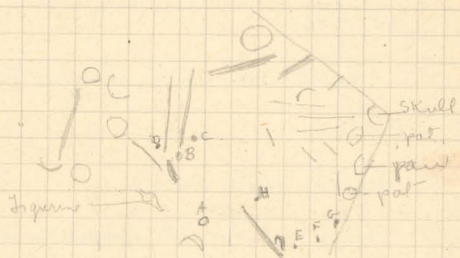

In afternoon

- 1 steatite button (A) blue/black  
0.013 long - bottom diameter 0.019
- 3 olive pit shaped paste beads (B, E, G)
- 3 round paste beads (small) (C, F, H)
- 1 greenish gray steatite pendant bead (D) 0.011 long - pierced at neck

no special arrangement can be observed - all pottery is L.H.III. There are fine pots with fairly dark red back ground

1 pot with one wide handle has

see page (116)

from page (115)

Tomb VIII

wednesday

May 23

the pattern and coloring of polychrome matt painted ware - but paint seems to be glazed.

only one skeleton in place so far, at left, feet to door.

only 1 pot and a few bones in niche at back

There is a small cist on line with left side of door about in middle of chamber (not yet outlined)

see page (117)



(117)

Jamb VIII from page (116)

Thursday  
May 24

a man work with knives cleaning  
bones and pots.

Small pit beginning 1.40 fm from right  
side of door outlined, measure 0.62  
long x 0.27 wide. depth (greatest) 0.19

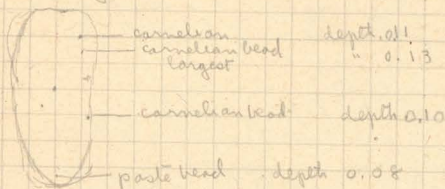

in pit are small <sup>and large</sup> skull  
bones and the

following beads:

- 1 <sup>bevelled lines</sup> carnelian 0.01.5 long  
0.01.3 wide at center  
0.00.4 wide at ends  
flat on either side 0.00.5 thick
- 1 carnelian bead 0.01.3 long  
0.01.1 wide at center  
0.00.3 " " ends
- 1 carnelian bead (chipped)  
0.02.7 long  
0.01.5 diameter at center  
slightly flattened
- 11  $\times$  small round carnelian beads  
0.00.4 - 0.00.6 diameter
- 5  $\times$  round paste beads - largest 0.00.9 in  
diameter

see page (119)

from page (113) Jamb IX

(118)

Thursday  
May 27

two men working (one with knife  
one with basket) - cutting lower  
level of chamber. (three men  
after breakfast)

find 0.70<sup>-0.90</sup> from right wall  
about half way between front and  
back walls the following:

- 1 small piece iron
- 1 bronze round bead  
0.00.6 diameter
- 2 round yellow paste beads  
(broken) 0.01.2 diameter
- 1 broken carnelian bead  
0.02.1 long - with three  
incised lines on each flat  
side



- 3 small pieces bronze  
deposited dots

also 5 small pieces of iron at left  
back.

an iron sickle head

see page (121)



(119)

From page (117)

Thursday June VIII

May 24

1 pale head 4 leaf clover

flat.  0.00.5 widest part.  
0.00.1 thick

These heads do not seem to have  
an ordered arrangement.

at 0.15 below hip joint of placed  
skeleton was found a blackish green  
stone implement (?) egg shaped  
0.05.6 long x 0.03.4 wide.

Skull noted on page (117) near left wall  
seems to be top of skull of placed skeleton.

\* this skeleton lies head to back, feet to  
front of chamber, ~~back~~ back to waist.  
legs turned on right side - contracted  
position.

on the left of group of 11 pots back  
of this skeleton, are outlined (120) more  
see page (120)

From page (119)

June VIII

Thursday (120)  
May 24

leg bones and 1 foot in place, are  
seen; to the right of pots skull,  
arm bones and ribs - this probably  
is another placed skeleton, it lies  
on slightly lower level than 1st placed skeleton  
Directly at left of door is a small  
heap of bones (1 skull) and two pots.

1 small olive pit slope black  
pale head found in angle of  
one of femurs and tibia of other  
placed skeleton.

a larger cist directly in front of  
door begins to be outlined.  
In this cist are three skulls  
and large bones.

It is irregular in outline

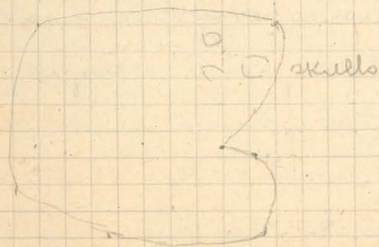

see page (126)



Thursday  
May 24

condition found 1.00 from  
right wall, 1.10 from back, 1.10  
from left (on line with arch)  
measures 0.32 from top to end  
of handle. Handle 2.10 long x 0.04 wide  
this layer (about 0.15-0.20 above  
dromos floor) is geometric except  
the carnelian head.

Near carnelian head found

1 reddish steatite button

0.00.9 long

0.01.5 bottom diameter

The earth at night is fairly soft, filled  
with small white stones; at the back  
is harder fallen stones.

a few sherds (geometric) found

1 large bone found near door.  
0.22 long 0.30 in from right  
side of door.  
group of 12 small stones incised  
at left wall

see page 123

Tomb XII  
(Middle Helladic grave) Thursday  
May 24

Two men begin to remove  
stones 5. metres west of  
door of Tomb XXXV and on  
line with it. <sup>East of right side of dromos of Tomb XXXV</sup> Stones fairly  
small some flat but most  
rounded.

a pot was found earlier

0.42 below top stone on

south side with a few  
bones. (yellow Mycenae) <sup>page 14 c.w.B</sup> 50 from <sup>corner</sup> edge

At 0.20 below surface

large red painted

(amphora) pot appears (broken)

0.40 to left of side wall

toward XXXV.

neck 0.13 diameter

0.20 high

0.23 diameter

Bones + another small broken  
pot (yellow with black lines)found depth 0.45 below right  
side wall. 1.00 from back wall.50 from right <sup>side</sup> see page 124



May 25  
Friday

Tomb IX

3 men working - knives + brooket  
these stones are fairly small  
irregularly cut and placed. a

bronze brooket found resting on  
stone at back in arch or niche.  
slightly bent - diameter 0.10  
very flat

a cist is outlined at right, 1.20 x  
0.60 (width) narrow + small  
front to. This cist is covered partially  
with small irregularly placed stones.

.45 to back wall

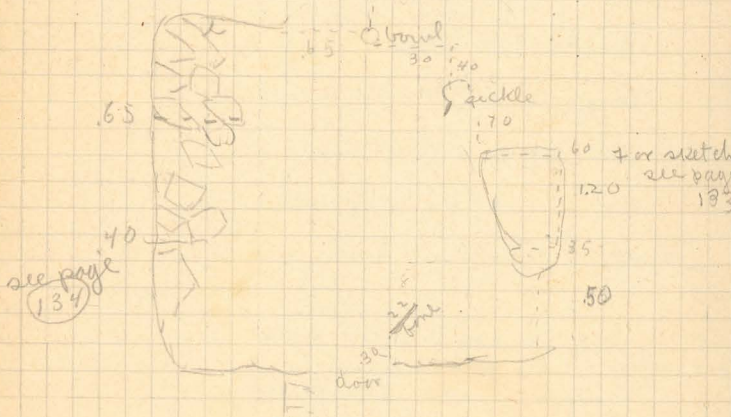

These stones and dramas cleaned up  
So far all shards and bronze and iron found  
is generic.

see page 128

(middle Helladic grave)

Tomb LII

Friday  
May 24

two men working

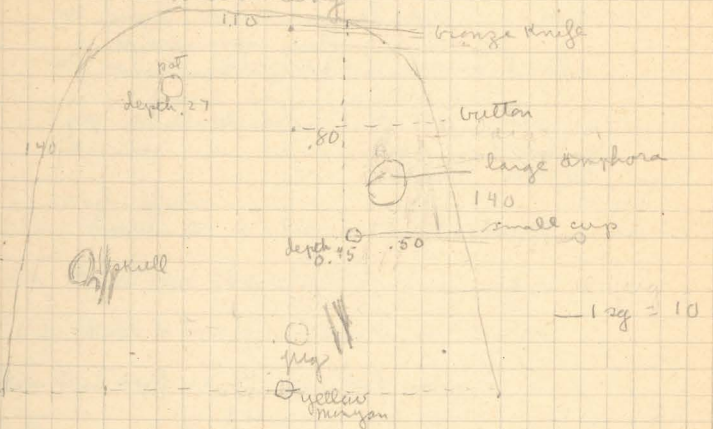

Four small pieces of bronze knife  
(one with two rivets) found against  
back wall depth 0.25, 0.50 from  
right wall.

- 1 <sup>shell</sup> found 0.50 from wall 1.00 from back, 0.15 from large red pit
- 2 pieces black steatite (parts of projection of handle 0.07 diameter 0.025)

1 small red pig found near neobones  
70 from right wall + 1.70 from  
back wall.

1 coarse steatite button found  
0.65 from back wall, 40 from right wall  
x 0.03 wide - 0.025 long

see page 125



(125)

from page (124) This is to be known as the  
 Tomb LII.

Friday  
 May 25

0.65  
 the cairn like structure in front is  
 door. Two large stones lying on  
 either side and partially under the  
 smaller cut flat ones may be an  
 earlier tomb.

Squid 3 huddled pot 0.08 diameter, 0.055  
 high, yellow back ground, red bands and  
 arrow head decoration found at depth of 0.27  
 0.45 from left wall, 0.30 from back wall

this early Mycenaean <sup>L.H.I</sup> others are probably  
 middle Helladic <sup>L.H.I</sup> <sup>no. 2</sup> <sup>by Mycenaean</sup>

Skull 0.20 X 0.17 (jaw and base in part) out lined  
 0.55 from front wall line, 0.25 from  
 left wall.

Present top of door is 0.23 above back wall.  
 Left side of chamber is 1.40 from corner  
 of jamb & drums (right) of tomb XXXIV.

4 tiny pieces bronze perhaps of a ring  
 found few centimeters to right of myc. pot.  
 One sifts dirt taken out May 24

Found one piece of bronze knife  
 see page (129)

from page (129)

Tomb VIII

(126)

Friday  
 May 25

one man sifting earth, finds  
 1 round paste head 0.008 diameter  
 1 " " " 0.009 " "  
 2 broken bits paste  
 1 yellowish pendant stoneware bead  
 0.012 long - pierced at neck  
 2 small sherds.

Chamber is now ready for drawing.

and photo.

measures 3.20 deep X 3.60 wide - check this

see page (140)



(127)

from page (97)

Incl. XXXIV

Friday

May 25

one man sifts earth from east <sup>front of</sup> door  
 During morning finds

1 potte head - round - 0.00.7 diameter

several sherds

1 bronze tip of arrowhead (2) 0.1.8 long

1 <sup>obovoid</sup> ~~flat~~ arrowhead (broken)

0.02.3 long

1 broken potte head cylindrical 0.01.7 long

1 obidian arrowhead 0.02.5 long

1 " " " 0.02.1 long

from page (123)

cont. IX

Friday  
May 25

Door is cut down leaving one  
 course - 0.15 above drums level  
 and 0.33. ~~total~~ above chamber  
 level.

The stones at left side of chamber  
 lie unevenly. ~~is to the~~ under to 0.55  
 0.70 at back from 0.40 at front.

see page (133)



(129)

from page (125)

Friday  
May 25

Tomb LII

stones found at mean depth of 0.50

floor cleaned.

Tomb measures 2.00 wide at door  
2.00 deep. sides

curve gently toward back, making a  
half circle.

see page (135)

from page 43

Tomb XXXV

(130)

Friday  
May 25

2 men remove door

height 0.45  
width outside 0.77  
" middle 0.80  
depth 0.80

on left side stones is 0.17 above level  
of floor - on right 0.10 above -  
no joints defined as yet.

see page (132)



Friday  
May 25

Two men remove earth and stones lying directly to east between door + right wall of Tomb III. Stones very soon reached after finding snail + track.

Small trench now begun 0.60 to east and 0.30 south of door of Tomb III on line with right large stone under door of Tomb. Stones reached at depth of 0.30.

Tomb XXXV - from page (130)

Saturday  
May 26

2 men begin to dig for a dromos. Dromos impossible to determine - space dug 2.00 south from door (including trench)



(133)

Zomb IX from page (128)

Saturday  
May 26

Right list — 1 sq = 5 cm.

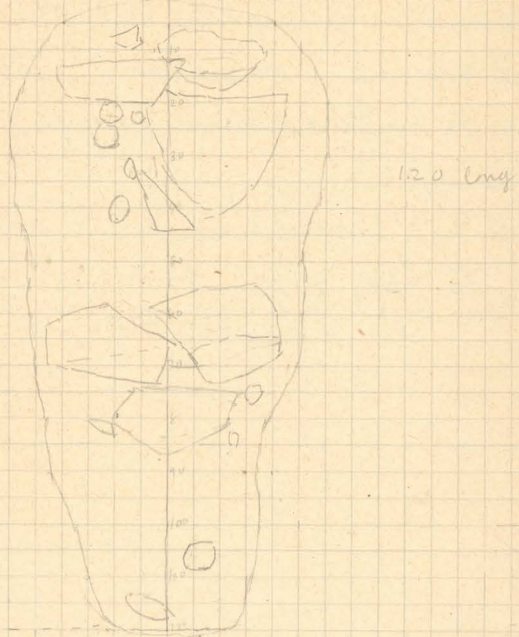
.80 to  
right side  
of door

right anterior wall

see page (134)

from page (133)

Zomb IX

(134)

Saturday  
May 26.60 below wall at well  
front

Zomb IX

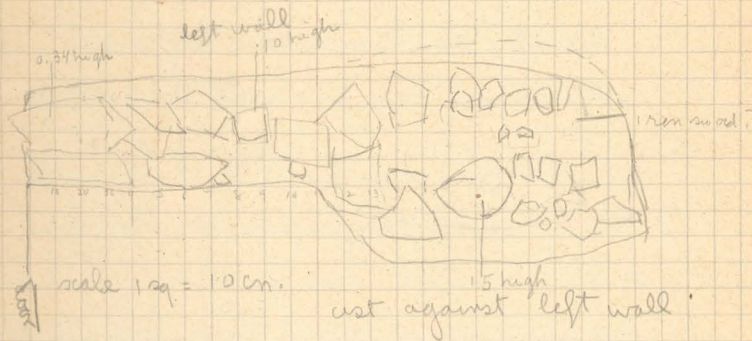

scale 1 sq = 10 cm.

cut against left wall

Chamber measures 3.10 deep x 3.05

cut in drops - left side

1.65 long, 0.50 wide

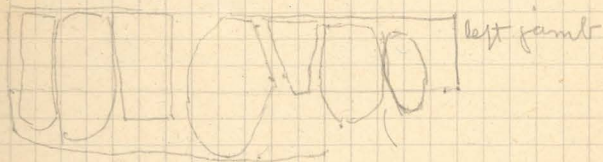

1 man sifts, finds

- 1 fragment pot's head
- black olive pit shaped pot's head
- 2 sherds

see page (137)



(135)

from page (129)

Saturday  
May 26Tomb LII. ~~two~~ <sup>three</sup> men.

one man in sifting finds one piece  
of bronze knife, two sherds

earth cleared from front of door  
slab from M.H. grave XIII showed back

The present door of Tomb LII is composed of  
flat cut stones resting on two large  
stones .0.40 apart. (Space goes on .0.90

from outer edge of larger stone). Door stands  
including large stones 1.10 high. Smaller  
stones alone 0.50. Door is 0.60 deep;  
1.10 wide both front + back.

Door lies 3.20 back (north) of  
middle Hallstatt grave XIII.

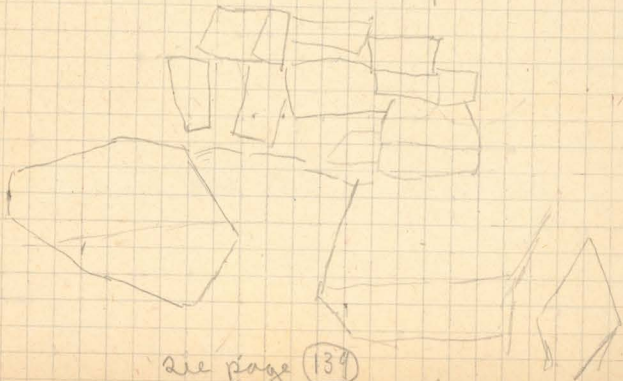

see page (139)

(136)

Tomb XXVSaturday  
May 26

Four men begin to clear right  
side of chamber of fallen earth  
and stones. Tomb dug 1927. Large  
mass of earth and conglomerate Julianin.  
By night have removed approximately  
depth of 1.00

see page (141)



Saturday  
May 26.

C. W. B. photographs

1. cist at left wall from above
2. cist in dromos from above.

In afternoon two men remove stones from left cist. Find under one of larger stones sherds of a coarse brownish pot. Mycenaean?

see page (142)

Saturday  
May 26.

Two men remove stones (fairly small and round) lying diagonally across right front corner of Tomb XXXVI. Loose reddish earth underneath to depth of 1.60. Hole deep measures 1.00 x 0.60.



(139)

from page (135)  
Janr. LII

Saturday  
May 26

C.W.B. takes photograph

a) of chamber from East (no. 2)

b) of door from South (no. 3)

see page (157)

from page (126)

(140)

Janr. VIII

Saturday  
May 26

C.W.B. photographs

a) placed skeleton with group of

parts (nos. 12)

b) Right heap of bones and

parts (no. 1)

1 man in sifting finds

2 1 oblong, sloped black bead

1 round white bead

Mrs Cox begins drawing May 31

see page (165)



(141)

from page (136)

Monday  
May 28

Tomb XXV -

Four men continue to dig down to floor level in right chamber. after digging down about 0.25 all over side chamber, ~~and~~ they dig down to steros in ~~front~~ <sup>half</sup> around two large stones.

a few sherds (granitic) found in fallen earth.

One stone flat roughly rhomboid in shape 0.80 X 0.50, set 1.20 to right of door and 0.60 back from wall removed.

a few small pieces of bronze, probably a knife, found 0.50 from right side wall, 0 from <sup>artificial</sup> corner.

one stone rounded set into right wall about 0.80 diameter removed.

Knife work from begun.

Behind flat stone at height of 0.65 several large bones stuck out from steros. Bones measure 0.25 and 0.20 <sup>long</sup> all page (145)

from page (137)

Tomb IX

(142)

May 28  
Monday

one man clears left wall east and one man removes earth - find more fragments of pot in front, one blue paste head at back at depth 0.08.

mean depth of east 0.15.

when stones are all removed and east outlined, east measures

1.60 X 0.30. the covering stones extended beyond <sup>actual east</sup> to right and at either end.

right hand east now uncovered steros reached at depth of 0.28 - nothing found.

east in dromos uncovered and dug. steros reached at depth of 0.40. when dug.

east measures 1.45 long X 0.30 at outer end and 0.27 at inner end. nothing found.

But sifted May 31 from dromos east Tomb drawn & cleared June 2 sickle + bowl removed June 6



(143)

from top page (96)

Monday  
May 28

Two men again clear bones which  
have been covered by falling earth.  
Bones lie 2.20 from right corner  
wall of Tomb VIII.

Tomb 43

(144)

Four men	1 carnelian round bead	0.00.8
	1 paste round bead	0.01.1
	" "	0.00.8
	1 bronze rivet	0.01.2
	1 wavy rosette	0.01.5
found at center back.		



(145)

Somb XXV From page (141)

Tuesday  
May 29

Two men clean bones in front wall  
and clear fallen earth behind  
large round stone removed May 28

Shaft graves

(146)

Tuesday  
May 29

10 men working

Trench E X A # 7 length 10.60  
width 1.20 at north end  
depth at north 1.40



2.90 from north end depth of 0.65  
a stone wall measuring .60 wide  
at N. narrowing to 0.15, 1.80 long  
appears, another wall at it L  
runs across trench, measures  
0.60 - 1.00 wide, depth 0.40  
a third wall runs diagonally  
across trench 0.46 wide.  
1.20 from 2<sup>nd</sup> at left, facing  
north, 1.50 at right. depth 0.20.  
sketches L H I III + M. H

see page (154)



(147)

## Shaft graves

Tuesday  
May 296.50 metres, <sup>west</sup> from trench #7

E. IX trench #6 being dug into side of sloping dump

1. wall being outlined at north running diagonally across trench East to west.

wall previously uncovered depth of 0.20 runs straight across trench is 0.50 wide and lies 0.90 from west side and 1.70 from east side of northern wall.

This trench is 1.20 deep at north &amp; is 19.00 long. Inward South curves to East.

By now gray earth resembling that in trench 5 + on line with it begins at depth of 1.30.

In pit inside of dump the diagonal wall appears to have two courses only. Fine gray earth (myc. sherds) shows at right back <sup>see page</sup> (155) and along

## Shaft graves

(148)

Tuesday  
May 29E. IX trench #5 dug 3.70 west of trench #6 into slope of dump. Pit containing very soft earth and myc. <sup>coarse red</sup> sherds dug to depth of 2.50. In this pit a number of small round stones appear.

In North section depth 1.40 1 twisted piece bronze, 2 iron nails (?) appear. Earth is dark gray and reddish.

In afternoon a few more pieces iron (one with prong at one end) and bronze appear in north pit.

see page (156)



(149)

Tuesday  
May 29

## shaft graves

DUMR

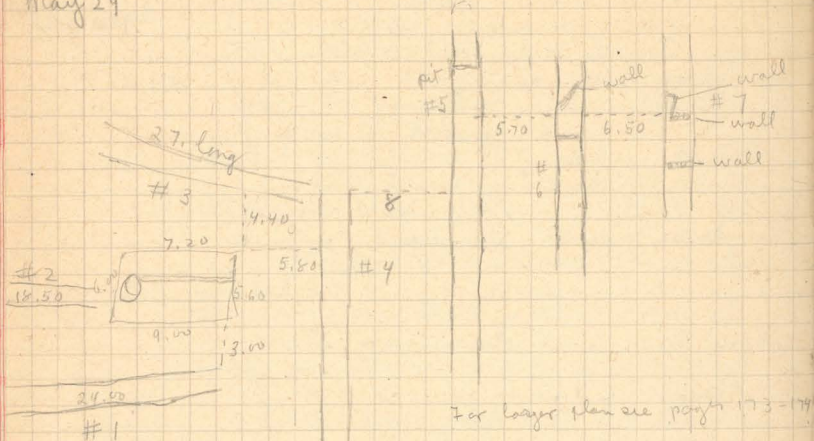

E. XIX trench no. 4 (now abandoned) less 8.00  
to west of # 5. it stops about 14.00  
from beginning of slope of dump. it  
measures 26.00 long. at south it ends against  
two walls  $\wedge$  (Hellenistic) and begins two  
other lines of wall in middle section. at the  
north end trench was dug to depth of 2.70  
sherds myc. gray mignon and coarser unpaired ware

(150)

Tuesday  
May 29Trench  
E. XIX  
# 3E. XIX  
#  
Trench 2

8 shaft graves  
trench # 3. E. XIX runs at  $\angle$  of about  $100^\circ$   
E. to west of trench # 4, in a slight  
curve to the north - it is 27.00 long  
greatest depth is 2.45, width  
averages 0.50. (width 1.20)

sherds ware

trench # 2 runs || to trench # 3 and  
3.30 to south. it is 18.50 long, greatest  
depth is 3.40. a line of earth 0.60  
wide was left between this trench  
and <sup>west line cut for</sup> shaft grave of 1925. trench # 2  
extends 5.00 to west of trench # 3.

a <sup>irregular</sup> rectangular pit running  
east to west including shaft grave  
of 1925 has been dug || to trench # 3.  
N. E. corner of pit is 4.40 from  
trench # 3 and 5.80 <sup>from</sup> end of deep cutting  
in trench # 4. it measures 5.60  
on east side, about 9.00 on south,  
7.20 on north, and about 6.00  
on west side. the shaft grave of  
1925 is at west end of this cutting see page (151)



(151)

Tuesday  
May 29

Shaft graves from page (150)

a stone wall. height 1.10

~~and~~ 0.90 wide divides pit into  
two unequal parts, the north section  
1.30 wide, the south 3.40.

The deepest part is 3.40 below surface.

Trench #1 runs (a little irregularly) E. to W.  
eastern end on line <sup>with</sup> and 3.00 to south  
of large  pit. <sup>S. eastern</sup> It is 24.00 long  
Deepest cutting is 3.10 below surface of  
ground.

Shaft graves

(152)

Tuesday  
May 29

In cutting in slope above S. Stoa  
of temple several bronze rings, nails  
and small discs. Shards gem. or  
cornelian. Earth fairly soft packed  
with small stones.

also  
badly broken paste head  
bronze rivet.

see page (153)



(153)

Wednesday  
May 30

Shaft graves 8 men  
In cutting above South Stoa  
Two men have gone down about  
2.00 and are passing out of  
geometric deposit.  
Cutting about 1.60 x 3.00  
a few myc. sherds found.  
During afternoon steres found at  
depth of 3.40 in center.

see page (159)

(154)

Wednesday  
May 30

From page (146) Shaft graves  
EXIX Trench # 7  
Stereo is reached in this trench  
at uneven depths - from 0.90 - 1.40  
A few small bones found in under-  
cutting to the left (west) near northern  
wall. Earth is ~~soft~~ soft filled with  
small stones, brownish when fresh, turns  
to light <sup>gray</sup> when dry.



(155)

Wednesday  
May 30Shaft graves from page (147)  
E XIX trench # 6

right side at depth of 1.10  
next to <sup>diagonal</sup> wall, sloping diagonally,  
toward outer wall. deposit is .25 deep  
in back right corner gray deposit goes  
down 0.20 wide and 0.30 deeper. a  
cutting in red earth for wall?

In afternoon a few stones appear protruding  
to south from cross wall - depth 1.40  
soft earth (brown) on each side.

at 4.50 from cross wall there is  
a deeper cutting in trench (slit  
at 0.80) outlined on each side by  
straight lines of fairly dark gray  
earth. (not so dark as deposits in north  
end of trench. measures 2.05 long.  
see page (160)

From page (148) Shaft graves

(156)

E XIX trench # 5

Wednesday  
May 30

stones running across trench are  
roughly laid base walls. artificial  
wall between N. + S. parts of trench  
cut lower as N. section becomes deeper.  
at depth of 0.95 (found in N. section)  
badly broken bronze bowl.

In afternoon begin to find Myc. sherds  
(several painted cylix stems)

see page (161)



(157)

from page (139)

Wednesday  
May 30

Tomb II

Miss Cox draws tomb

- # 1 skull
- 2 L.H. 1 pot
- 3. knife in pieces
- 4. large amphora
- 5. yellow Mycenaean cup
- 6. " " jug

1 man removes pots.

(158)

Wednesday  
May 30

Shaft graves.  
Temple terrace

In morning two men, in afternoon  
four begin new trench #108  
running east to west, beginning  
near S.E. corner of 5<sup>th</sup> c temple.

This is below + South of ramp of <sup>the</sup> acropolis.  
a few geometric + proto-Corinthian shards  
found. see page (162)

a sinking in earth with several  
loose stones begun to be dug by two  
men. This lies 18.00 north  
of hut and a little to east of it.  
see page (163)



(159)

from page (153) 2 men

E ~~ATA~~ slope above South Coa shaft gravesThursday  
May 31

Early in morning shales found at  
depth of 2.50 at left (west) back  
and 1.80 at left front.  
(surface of slope very steep)

cutting measures 3.60 X 1.90 at  
west end, narrowing to 0.85 at East  
men transferred to pit and trench 108.

from page (155)

Shaft graves

(160)  
Thursday  
May 31  
E ~~ATA~~  
trench #6

2 men working.  
stones protruding <sup>south</sup> from wall  
removed (probably gulben). Soft  
earth underneath.

During day levels on each side  
dug down further.

shards - myc. some FHI

2 men  
in section south of wall  
depth of 0.80 below wall, two  
animal bones appear.

in section between diagonal  
and cross wall shales reached  
at depth of 1.40 below cross  
wall and at 1.05 below diagonal  
wall

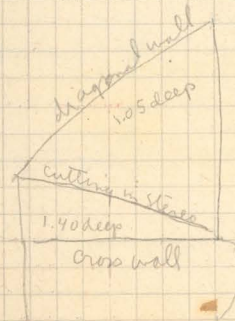

see page (166)

Friday  
June 1



(161) Shaft graves from page (156)

E. XIX

Trench # 5. 2 men working - cutting down  
Thursday  
May 31 northern part of trench.

By night Stereo reached at north  
at depth of 2.60

Trench # 5 2 men - continue digging down  
Friday  
June 1 on northern section.  
Mycenaean sherds.

Trench # 5

1 narrow bronze ring  
1 lead clamp 0.03.5 long



Saturday  
June 2

2 men continue digging down  
northern part of trench -  
sherds Myc. some L.H.I.

By night Stereo slopes steeply down begin-  
ning 2.30 from north end  
from depth of 2.20 to line of stones  
probably <sup>house</sup> wall (page 156) 4.30 length of  
north end of trench.

see page (170)

from page (158) Shaft graves - Temple Terrace (162)  
Top Trench # 108

Thursday  
May 31

Four men (2 from cutting on  
slope above South Stea) continue  
to dig trench.

1/2 geometric seal stone found in

Trench - pierced on sides at center  
measures 0.02.3 wide, 0.01.9 long  
Carved lines represent animal.



Broken unevenly 0.01.1 thick at top,  
0.00.7 thick at bottom.

Bits of bronze wire found

Sherds geometric, Proto-Corinthian  
and Mycenaean.

Friday

4 men continue trench which June 1  
now measures 36.00 long

Find also 1 flint knife (Early Helladic?)

0.06 long. 0.02.7 wide

tapering to point.



see page (167)



(163)

Shaft graves from page 158  
Pit on temple terrace bottom

Thursday  
May 31

Two men continue digging in pit.  
During morning numerous fallen  
stones removed. No placed stones  
found as yet. Shards geometric + mycenaean  
In afternoon rough line of stones (large  
top one cut) appears. Digging begun  
to east of these. By night have  
dug to depth of 0.60. Earth  
soft brown. geometric sherds.

Friday  
June 1

Cutting East of Pit on temple terrace down  
2 men continue digging to east  
of large stones which now appears to  
be wall. (appears also in trench 8  
maybe face of foundations of altar)  
Pots, scarabs found in section east of wall.



0.013 long, 0.009 wide, 0.005 thickest section  
(back of head) - cartouche on bottom +  
carving on side.

Bronze figurine 0.11 tall  
shoulders 0.042 wide, right arm

stumped found. small birdlike head. legs 0.05  
long. found at feet. see page 164

From page (163)

Shaft graves

(164)

Friday  
June 1

Cutting East of Pit on temple terrace

1 reddish stoneware button  
0.015 long, diameters 0.01 and 0.02.1  
shards chiefly geometric - some myc.  
1 gray Mycenaean

Saturday  
June 2

2 men continue digging down  
East of altar? wall. eastern  
face constructed of large roughly  
cut, <sup>rounded</sup> slabs - top ones flat.  
altar foundations 2.40 wide.  
Cutting measures 2.40 along

wall, 0.70 wide and 1.30 deep

Rock reached at 1.35 - 1.45

men transferred to lengthening  
Trench 108.



(165)

Junk 8 from page (140)

Friday  
June 1

- Miss Cox continues drawing  
one man clears small nest - finds
- 9 & round carnelian beads
  - 2 round paste beads (small)
  - 1 4 leaf clover flat paste bead E3

2m squat jar #16 - gray matter (carbonized)  
a bit set aside for analysis.

3m afternoon finds in right hand heap

- 1 seal stone black 0.01.8 diameter  
0.00.6 thick in middle - ribbit? on one  
side, plain on other.
- 1 seal stone red 0.01.8 diameter at  
pericarp, 0.01.8 on other  
0.00.6 thick at center. incised on one  
side, plain on other.



- 1 steatite spool 0.00.7 long
- 1 purplish pendant steatite bead  
pierced at neck 0.01.2 long
- 1 steatite button 0.01.3 long  
0.01.9 diameter
- 2 cylindrical paste beads
- 21 ~~5~~ round paste beads
- 1 flat thin paste bead  
fragment
- 4 ~~8~~ olive pit dyed black paste beads
- 1 glazed paste bead 0.01.1 long  
see page (168)

Start frames from page (160)

E. XIX trench # 6

(166)

Saturday  
June 2

small area directly south of  
wall still being dug -  
means 0.90 deep from bottom  
of wall.

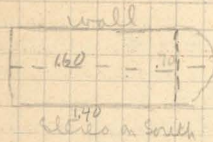

Stones reached at 0.90-1.00 from  
bottom of wall, 2.20-2.30 from top  
of wall and 2.50-2.60 from surface.



Shaft granules E XIX  
Trench 108 on temple terrace

Saturday  
June 2

4 men continue digging trench  
kind bronze bird on round standard

bird 0.03.8 high  
standard 0.00.4 "



1 broken paste scarab found in trench depth 0.15  
pierced lengthwise - cartouche on back  
measures ~~1~~ 0.01.5 X 0.01

1 broken paste bead round 0.01.4 diameter

1 round paste bead (outside flaked off)  
0.01.3 diameter

1 yellow glass bead diameter 0.01.6  
thickness 0.00.7

1 yellow glass bead diameter 0.01  
thickness 0.00.5

triangular stone head black + white

see page (169)



In uncovering front cist two  
more skulls appear.  
also find in front cist

Saturday  
June 2

4 olive pit shaped black paste beads  
8 round paste beads

4 fragments

1 white olive pit shaped paste bead  
0.00.7 long

1 blue black steatite button  
0.01.2 long  
0.01.9 diameter

1 round carnelian head diameter 0.01.7  
" " " " 0.00.3

1 flat steatite <sup>bead</sup> button green gray  
pierced at one side  
diameter 0.01.1  
thickness 0.00.3

as <sup>front</sup> cist is cleared it changes and  
becomes three 

1 man continues clearing <sup>front cist</sup> that uncovers Monday June 4

3 pits 4 skulls (2 on June 2)

1 steatite convex button 0.00.8 long  
0.01.6 diameter

1 terra cotta double convex button  
0.02 long  
0.02.2 widest diameter

1 4 sided steatite button 0.01.1 long  
width of side 0.00.5

skull of back placed skeleton measures  
0.18.4 long X 0.13.3 wide  
2 more cists uncovered in clearing out bones see page  
19 Book II



(169) from page (167) Temple Trench #108

Monday Shaft graves. 8 men

June 4 Several large stones appear in Trench  
4 m. from face of altar - they  
later prove to have very loose earth  
under them. Ramped -

shards, glass, mica & bits of bronze  
at greatest depth just east of altar wall trench is  
now 1.40 deep.

west of altar wall find depth 0.80

1 plate head round 0.01 diameter

2 " " head round 0.009 " (broken)

at depth of 0.90 and at 0.60 west of altar  
several

well a ~~plate~~ large flat stone appears -

at west end of trench <sup>large</sup> pot (burned or vitrified)

stones then outlined across trench

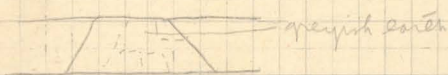

on both sides of altar depth of 1.20 on  
west side, 1.40 on east numerous middle

helladic shards appear mixed with mica

late in afternoon in west end of trench

appears a flat stone, next to it another

narrow cut stone with two thin edges.

depth 1.50

see page (172)

from page (161) Shaft graves E & IX trench #5 (170)

2 men working going down

Monday

on each side of wall across trench  
which is 3.00 deep at wall.

June 4

shards reached at 3.20 - 3.40 below

surface & two men transferred to

temple trench # 108.



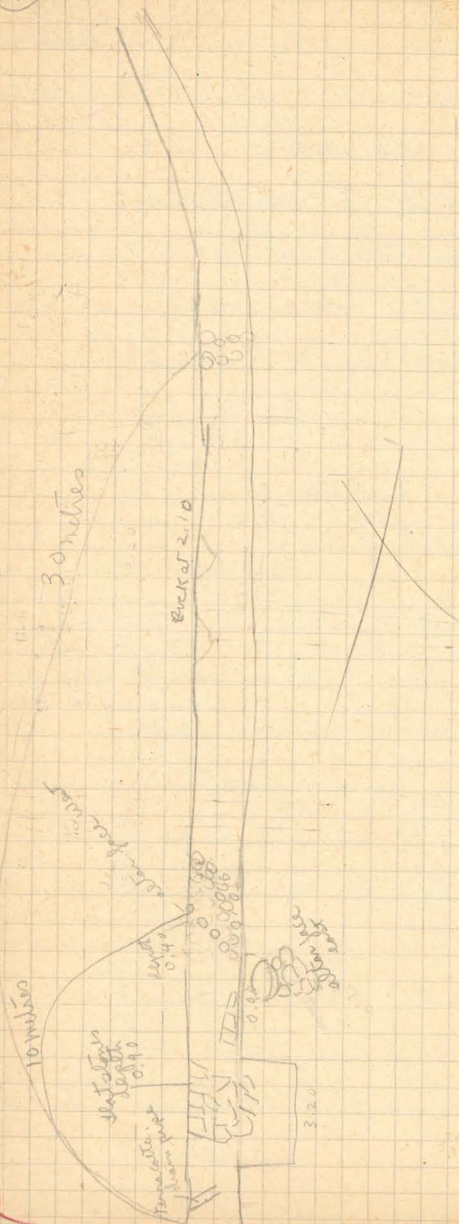

Shaft graves Temple trench 108  
 10 men from page 169

Tuesday  
 June 5

This stone proved to be a terra cotta drain myc. styles sherds found near it. runs diagonally across trench

two men now begin digging south of stones uncovered in trench to find their extent to East

East of altar men find rock along the line at various spots at depth of 2.10

In section of trench farthest East men find geometric sherds; in next section <sup>toward</sup> a mixture of geometric & Mycenaean, and near drain mostly Mycenaean.

trench now measures 47.11 long. By night stones outlined near drain measure 1.70 diagonally x 2.00. at East end nearest ramp is by night 0.50 deep then 1.10 for short distance

see page 1.75



173

shaft graves

Tuesday

June 5

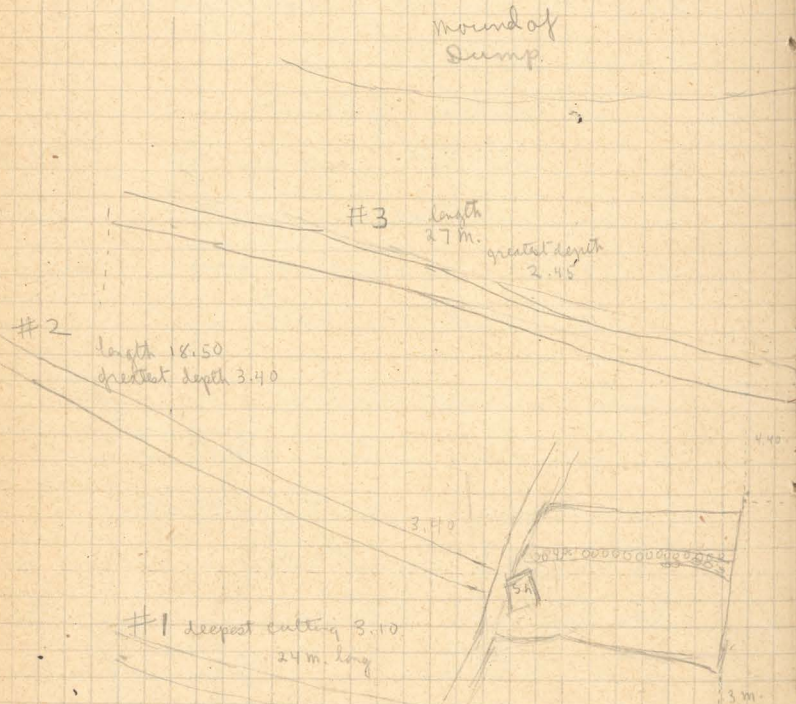

shaft graves

174

Tuesday  
June 5

1 sq = 1 meter

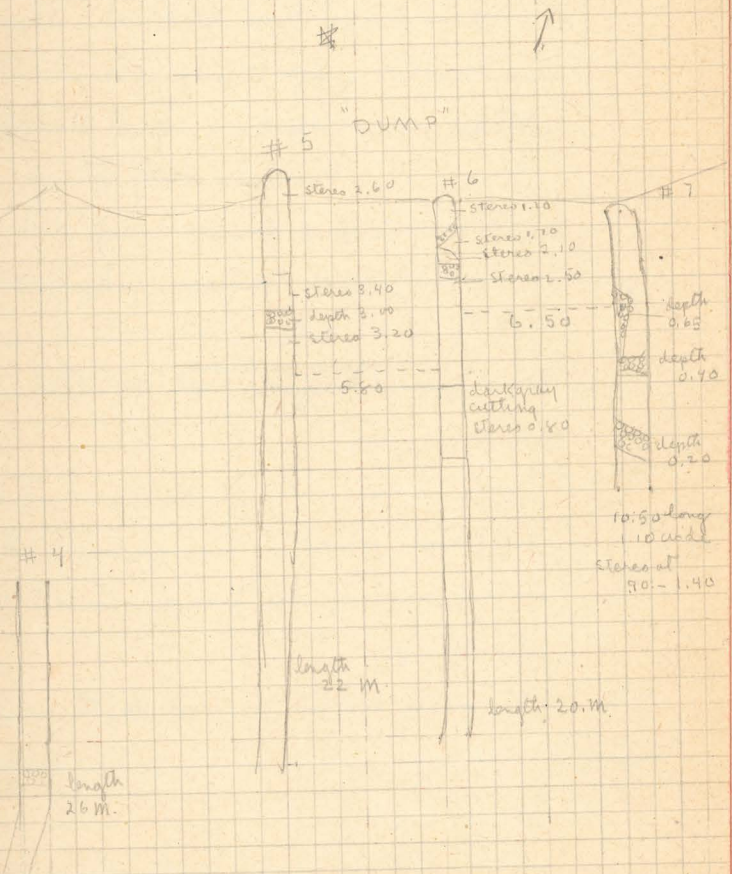



(175) from page (172) Shaft graves Temple trench #108

Wednesday

June 6

10 men working -

Laid stones near drain are probably  
a base: some cylinders found (broken)  
also a few animal bones depth 1.40  
Large cooking pot found depth diameter  
Terra cotta drain is 0.16 wide 0.06 deep  
extends 0.66 diag. across trench from corner  
going S.E. Drain is at depth of 1.60

Termination of drain is line of stones  
corner stone (?) of base is flat; comes to  
depth of 0.65 below corner stone + 1.70  
below ground surface <sup>are</sup> ~~and~~ smaller, some  
cut, some rough.

Drain runs into lower course of stones  
0.35 high roughly triangular in shape  
During morning all these + stones to East  
cleaned up -

In middle section greatest depth is 2.50

Middle sect. In afternoon many slabs of grey masonry  
appear depth 2.70 -

near line of large rough stones a  
series of 6 small stones appear depth  
as page (176)

from page (175) Shaft graves Temple trench #108

(176)

Wednesday  
June 6

2.00 slope <sup>altitude to west</sup>

and at depth of 2.40  
large flat stone outlined, sloping  
west to east. Stone measures 0.60  
along Trench X. 0.62 (width of Trench)  
Earth very soft with some small  
stones, changing to gray. Along Trench  
several large evidently unworked stones  
protrude from sides.

For two metres from flat stone west earth  
very dark - greatest depth <sup>now</sup> 3.30

see page (177)



(177) from page (176)

Thursday  
June 7  
6 men working \*

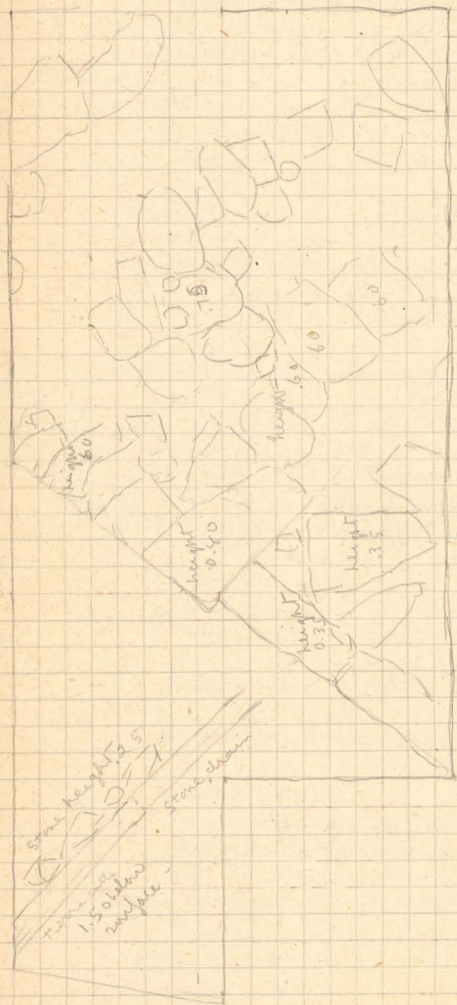

scale 1 sq = 10 cm.

foundations of House

height stone = 90 below surface

datum 1.50 below surface

see page (181)

Tomb 52 III. Summary

(178)

Tomb 52 lies 5 m. west of Tomb 35.

The left side of chamber is 1.00 East of right drinos wall of Tomb 34, the back wall 1.40 from right front corner of Tomb 34 see floor level is 1.40 above the floor level of Tomb 34.

The door to 3.20 back (width) of middle Helladic grave XIII.

The door is composed of two large round stones 0.40 apart which support small cut flat stones laid irregularly. The top course is fairly flat, however, going down a bit to the east.

The door is 1.10 high including large stones, smaller ones above 0.50 high. It is 1.10 wide both front + back + deep.

No ceiling is preserved.

The chamber measures 2.00 wide x 2.00 deep, sides curve <sup>to back</sup> forming a half circle. Parts of the side walls (near door) were destroyed by the trial see page (179)



(179)

Tomb 52 LII from page (178)

trench which uncovered one yellow Mungon jug, one skull and a few bones.

The floor is 0.50 below surface at back and at front of chamber.

at the left front of chamber were one skull and a few bones.

at the left back (depth 0.27) a small squat jar with three handles, common decoration L.H.I. yellow base ground, red red bands & commas.

at the back of chamber were found

6 pieces of a bronze knife + 4 pieces of a ring  
1 steatite conoid button.

at the right a large amphora - L.H.I?

near it were a few bones and to its left a small <sup>shallow</sup> cup (yellow base ground with black paint)

at the front on right side were found a small red jug and a yellow Mungon goblet.

There were neither cists nor placed skeleton.

see page (180)

(180)

from page (179)

This tomb although at a high level (1.40) above Tomb 34 contained <sup>some</sup> subjects of an earlier date - L.H.I and yellow Mungon pots.

Inventory

- 1 steatite conoid button
- 6 pieces bronze knife
- 4 pieces bronze ring
- 1 skull
- 5 pots.

when door <sup>(small flat stones only)</sup> was removed (June 8)

a third large stone was exposed standing between <sup>the</sup> two others and 0.90 back of the front line. This third stone measured 0.45 high and 0.50 wide + 0.55 long.



(181)

from page (177) Temple. Trench #108

Thursday  
June 7

Four men continue to dig down through black earth which is now mixed with streaks of red on sides. Steles on north side of trench:  
Middle Helladic sherds.

In section nearest ramp find:

stone implement roughly cut octagonal concoid slope with smaller stem at one end. Measures 0.12 long x 6.50 stem 0.025 long x 0.028 wide



C.W.B. takes pictures of

1. House from west 10.5
2. " " pit 11
3. Drain 11.10
4. Trench from altar foundation facing East (10-11)
5. Trench facing west showing altar face (12)

Trench 108 maybe divided into 3 sections

1. from west end to west face of altar  
in this the drain + Myc. house foundation a 2<sup>nd</sup> level of drain protrudes a little from corner of trench 0.28 above the other 8 m. long

(182)

Foundation of altar extend 3.50 along it -

2. 2<sup>nd</sup> or middle section from E face of altar to line of large lovely \* embedded stones - length 15.40
- 3<sup>rd</sup> section curves a bit to north measures 14 m. it ends 2 m. from N.E. corner of steps cut into conglomerate of a terrace. Trench at west end is 4 m. E. of foundation of Temple.

- \* at eastern end this section has at depth 2.00 a series of rough round stones, at 2.40 a large flat stones (cut).

at 3.30 depth <sup>remains</sup> 2 m. west from flat stones earth black thickness of stratum 0.30-40.

Below this, a narrow long hole goes down. measures when clear. 2.30 x 2.00 at narrow end + .50 wide

Steles rise in trench from this depth <sup>(3.30)</sup> to west at 2.10 depth.



in a series of shelves protruding from  
north side of trench starting across it.

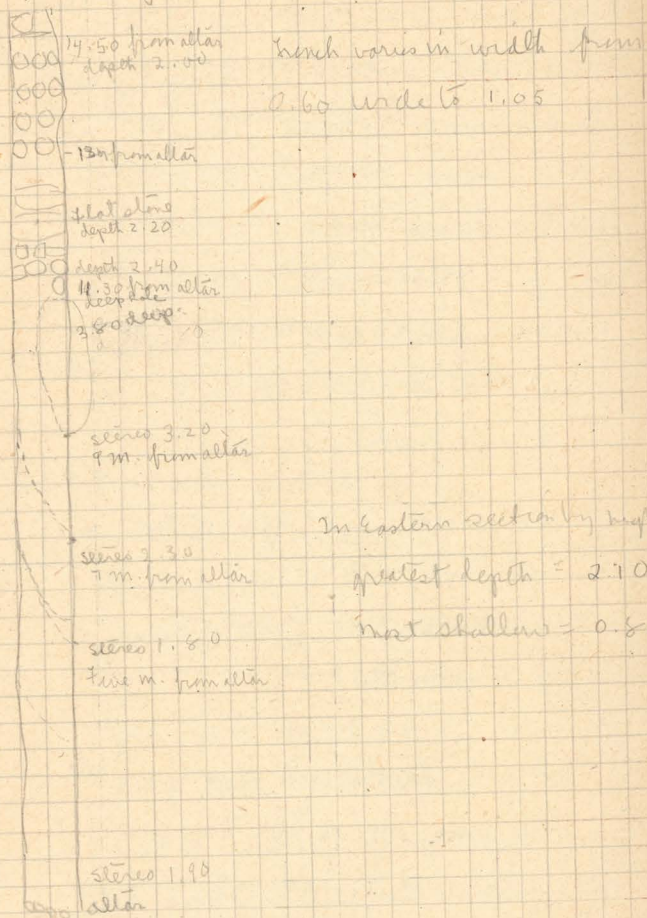

In eastern section by night  
greatest depth = 2.10  
not shallow = 0.80

see page 20  
Book II

1. Skull
2. □ L.H. 1
3. Knife in pieces
4. Large arrow
5. yellow thing up
6. " "



skull - M.H. in place - front bone smoothed  
measures front to back .149 (in place)  
side to side (not even - vacuum table) .129  
later 13.03

Skull in # 16? in M.H. Cleveland  
front to back .18.8  
top of jaw to back .22.6  
" " to top of skull .19.2  
" " to top of nasal cavity 14.2

18.4 long

176  
48  
224

16 asks?  
spout 3 huddled



